

OFFICIAL PREMIUM LIST  
**CALEDON KENNEL ASSOCIATION**

103rd, 104th & 105th All-Breed

# DOG SHOWS

**Friday, November 24, 2017**

**Saturday, November 25, 2017**

**Sunday, November 26, 2017**

**INTERNATIONAL CENTRE, HALLS 3 & 4**

6900 Airport Road, Mississauga, Ontario



*Limited Breed Shows (for full groups):*

**FRIDAY – WORKING and TERRIER GROUPS**

**SATURDAY – NON-SPORTING GROUP**

**SUNDAY – SPORTING GROUP**

**NATIONAL SPECIALTIES** – Dogue de Bordeaux, Siberian Huskies,  
Yorkshire Terriers, Old English Sheepdogs

**REGIONAL SPECIALTIES** – German Shorthaired Pointers, Samoyeds,  
Siberian Huskies, Norfolk Terriers, Miniature Poodles

**GROUP SPECIALTY** – Lakeside Toy Dog Fanciers

**BOOSTERS (34)** – Afghan Hounds (2), Beagles, Bernese Mountain Dogs (2), Border Terriers (2), Bulldogs, Cavalier King Charles Spaniels, Collies & Shetland Sheepdogs, Dandie Dinmont Terriers (2), Doberman Pinschers, Dogue de Bordeaux, French Bulldogs, German Shorthaired Pointers, Giant Schnauzers (2), Labrador Retrievers, Leonbergers (2), Lhasa Apsos, Miniature Poodles, Miniature Schnauzers, Norfolk Terriers, Nova Scotia Duck Tolling Retrievers, Old English Sheepdogs, Portuguese Water Dogs, Samoyeds, Siberian Huskies (3), Sighthounds, Standard Schnauzers, Whippets

## **ROYAL CANIN NATIONAL BREEDERS' CLASSIC**

Saturday, November 25 – MIDDAY – \$4,300 in prize money

### **JUNIOR HANDLING**

Saturday, November 25 and Sunday, November 26, with a Special Unofficial Junior Showmanship Invitational Runoff on Sunday, November 26 – **Over \$450 in prizes**

### **BABY PUPPY CLASSES**

Friday ONLY (including Friday's Limited Shows), November 24

*“Shows the way they used to be.” Please join us!*

**ENTRIES (INCLUDING THE ROYAL CANIN BREEDERS' CLASSIC) CLOSE:  
WEDNESDAY, NOVEMBER 8, 2017, 8 PM (EST)**

These shows held under Canadian Kennel Club Rules. Indoors.

---

**CALEDON  
KENNEL  
ASSOCIATION  
OFFICERS**

---

**SHOW  
COMMITTEE**

*President*  
*Vice-President*  
*Treasurer*  
*Secretary*

Judith Orsi  
Carol Stubbs  
Rosemary Shoreman  
Kim Birch

*Show Chairs*  
Rosemary Shoreman  
(705) 322-7853  
Patty Milton  
(519) 853-5593  
k94milton@gmail.com

*Trophy Chair*  
Anne Swantee

*Booth Chairs*  
Judith Orsi | (705) 250-4744  
judi.orsi@gmail.com  
Kim Birch | (416) 745-1856  
kim.birch@sympatico.ca

*Show Secretary*  
MJN Show Services  
9 Samya Court  
Scarborough, ON M1R 2A4  
(416) 759-8593  
www.mjnshowservices.com

*Promotions & Event Information*  
Patty Milton & Dannielle Adams

*Facilities Management*  
Joyce Logan

*Show Photographer*  
Ringside Images  
ringsideimages.ca

*Junior Handling Chair*  
Dannielle Adams

*Ring Décor*  
Judith Orsi, Carol Stubbs, JoAnne  
Pringle & Dee Devins

*Show Veterinarian*  
Nobleton Veterinary Clinic  
13135 Hwy. 27  
Nobleton, ON LOG 1W0  
(905) 859-4670

*Specialties & Boosters Chair*  
Patty Milton

*CGN Tests*  
Sonya Birch

---

**JUDGES**

**Benny Blid Von Schedvin**  
Strömma 205, SE-310 63 Älvsered, Sweden

**Nina Karlsdotter**  
Grällsbovägen 16, Se-740 45 Tärnsjö, Sweden

**Nancy Liebes**  
624 S Homestead Drive, New Castle, IN 47362-8956, USA

**Allan E. Pepper**  
4122 Concession 11, Moffat, ON LOP 1J0

**Jay Richardson**  
38WO24 Heatherfield Drive, Elgin, IL 60124-880, USA

**William (Bill) Shelton**  
165A Columbia Avenue, Coventry Cottage, Pomona, CA 91767-3829

**Jacqueline Stacy**  
116 Ocoee Falls Dr., Chapel Hill, NC 27517-9531836, USA

**GROUP JUDGING**

will start in Ring 1 when all individual breeds have been judged.  
Puppy groups will follow in an adjacent ring.

**JUNIOR HANDLING JUDGING**

Top Overall Junior Handler over the two days will be judged before the Groups on Sunday.

---

**ENTRY FEES  
CHAMPIONSHIP  
SHOW**

Entry fee per dog, per show .....	\$32.00
Listing fee per dog .....	\$9.60
Exhibition only .....	\$10.00
Catalogue .....	\$8.00
Altered, per dog (Specialties only) .....	\$32.00
Baby Puppy (Friday only) .....	\$15.00
Sweepstakes (Specialties only) .....	\$15.00
Non-Regular/ Unofficial classes (specialties only) .....	\$10.00

**All fees include HST and are in Canadian Funds.** A listing fee is payable for all dogs entered at shows that do not have an individual CKC registration number or an ERN Number. All cheques and money orders are to be made payable to **Caledon Kennel Association** and mailed to

MJN Show Services  
9 Samya Court  
Scarborough, ON M1R 2A4

**ENTRIES CLOSE 8 PM (EST)  
WEDNESDAY, NOVEMBER 8, 2017**

*To comply with instructions issued by the Canadian Kennel Club, we will be unable to accept any entry reaching our Show Secretary after the advertised deadline date and time.*

---

**FAX/CREDIT  
CARD ENTRIES-  
MJN SHOW  
SERVICES**

**MJN Show Services – Fax Number: 416-759-7790**

MJN Show Services will accept entries when paid by VISA, MasterCard, American Express or e-mail transfer. The fee for this service is 10% of the total entry fee. Declined credit cards will be deemed non-payment and entries will be returned. Entries processed by credit card and then cancelled before closing time will be charged a fee of \$3.00. ***MJN Show Services will not be held responsible for any difficulties encountered with fax transmissions. Please call to confirm receipt prior to closing.***

---

**TELEPHONE  
ENTRY SERVICE**



**THE ENTRY LINE [www.theentryline.com](http://www.theentryline.com)**

(519) 754-0393 | 1-800-293-2935 | Fax: (519) 754-0796

Mastercard/Visa/American Express. The Entry Line will close off their telephone and fax lines 2 hours before closing on Wednesday, November 8, 2017. This is a privately owned business that charges a fee for their service. MJN Show Services is not responsible for any errors made through The Entry Line.

---

**CKC  
INFORMATION**

The Canadian Kennel Club  
200 Ronson Drive, Suite 400  
Etobicoke, ON M9W 5Z9  
Phone: (416) 675-5511  
Hours: 9:00 a.m. - 5:00 p.m. M - F

Mr. Lance Novak  
Executive Director  
[information@ckc.ca](mailto:information@ckc.ca)  
Fax: (416) 675-6506

**CKC Director**

Peter Laventhall-Wolfish  
2 Sandringham Drive  
Toronto ON M5M 3G3

(416) 802-4707  
[peter@laventhall.com](mailto:peter@laventhall.com)

**Conformation Representative**

Pam McClintock

## 2017 JUDGING ASSIGNMENTS

Group	Friday, Nov. 24, 2017	Saturday, Nov. 25, 2017	Sunday, Nov. 26, 2017
1	<b>Nancy Liebes*</b>	<b>Nina Karlsdotter</b> Barbets to Retrievers <b>Jay Richardson*</b> Setters to Weimaraners	<b>Jay Richardson</b> Barbets to Retrievers <b>Jacqueline Stacy*</b> Setters to Weimaraners
2	<b>William (Bill) Shelton*</b> All Breeds in Group 2 — EXCEPT — <b>Allan Pepper</b> – Beagles <b>Nancy Liebes</b> – Whippets	<b>Jacqueline Stacy*</b> All Breeds in Group 2 — EXCEPT — <b>William (Bill) Shelton</b> Beagles	<b>Nina Karlsdotter*</b> All Breeds in Group 2 — EXCEPT — <b>William (Bill) Shelton</b> Whippets
3	<b>Nina Karlsdotter*</b> All Breeds in Group 3 — EXCEPT — <b>Benny Blid Von Schedvin</b> Leonbergers, Siberian Huskies <b>Jacqueline Stacy</b> Samoyed, Giant & Standard Schnauzers	<b>William (Bill) Shelton</b> Akitas, Alaskan Malamutes, Anatolian Shepherd Dogs, Black Russian Terriers, Boxers, Bullmastiffs, Canaan Dogs, Canadian Eskimo Dogs, Cane Corsos <b>Benny Blid Von Schedvin</b> Dogue de Bordeaux <b>Nina Karlsdotter</b> Giant & Standard Schnauzers <b>Jacqueline Stacy</b> Siberian Huskies <b>Nancy Liebes*</b> Balance of Breeds	<b>Nancy Liebes</b> Akitas, Alaskan Malamutes, Anatolian Shepherd Dogs, Black Russian Terriers, Boxers, Bullmastiffs, Canaan Dogs, Canadian Eskimo Dogs, Cane Corsos, Dogue de Bordeaux <b>William (Bill) Shelton</b> Bernese Mountain Dogs, Dobermans, Leonbergers, Std Schnauzers, Siberian Huskies <b>Nina Karlsdotter</b> Samoyeds <b>Benny Blid Von Schedvin*</b> Balance of Breeds
4	<b>Nina Karlsdotter*</b> All Breeds in Group 4 — EXCEPT — <b>Jay Richardson</b> Border Terriers	<b>Benny Blid Von Schedvin*</b> All Breeds in Group 4 — EXCEPT — <b>Jacqueline Stacy</b> Norfolk Terriers	<b>Jay Richardson*</b> All Breeds in Group 4 — EXCEPT — <b>Nina Karlsdotter</b> Border Terriers
5	<b>Benny Blid Von Schedvin*</b>	<b>Nina Karlsdotter*</b>	<b>Nancy Liebes*</b>
6	<b>Allan E. Pepper*</b>	<b>Jacqueline Stacy*</b> All Breeds in Group 6 — EXCEPT — <b>Nancy Liebes</b> Miniature Poodles	<b>Nina Karlsdotter *</b> All Breeds in Group 6 — EXCEPT — <b>William (Bill) Shelton</b> Miniature Poodles
7	<b>William (Bill) Shelton</b> Aust. Cattle Dogs, Aust. Kelpies, Aust. Shepherds, Aust. Stumpy Tail Cattle Dogs, Bearded Collies, Beauceron, Belgian Shepherds, Berger des Pyrenees, Berger Picard, Border Collies, Bouviers, Briards, Finnish Lapphunds, German Shepherds, Iceland Sheepdogs, Lancashire Heelers, Mudi, Norwegian Buhunds <b>Benny Blid Von Schedvin*</b> Balance of Breeds	<b>Nina Karlsdotter*</b> All Breeds in Group 7 — EXCEPT — <b>William (Bill) Shelton</b> Collies (Rough & Smooth) Shetland Sheepdogs	<b>Benny Blid Von Schedvin</b> Aust. Cattle Dogs, Aust. Kelpies, Aust. Shepherds, Aust. Stumpy Tail Cattle Dogs, Beardies, Beauceron, Belgian Shepherds, Berger des Pyrenees <b>Jacqueline Stacy</b> Berger Picard, Border Collies, Bouviers, Briards, Collies (R&S), Finnish Lapphunds, GSDs, Iceland Sheepdogs, Lancashire Heelers, Mudi, Norwegian Buhunds, OES, Shelties <b>William (Bill) Shelton*</b> Balance of Breeds
<b>BIS &amp; BPIS</b>	<b>Jay Richardson</b> <i>Best Baby Puppy in Show</i>	<b>William (Bill) Shelton</b>	<b>Nina Karlsdotter</b>

\*denotes group judging

# JUDGES' BIOGRAPHIES

## **BLID VON SCHEDVIN, BENNY** | Sweden

Breeds: Giant Schnauzer, Miniature Schnauzer

My life with dogs started at a very early teen-age when I joined an obedience club in 1964 with a very nice crossbred bitch. They were not allowed to compete in official classes so in 1966 I got my first Giant Schnauzer – a dog that won many shows and became very famous. I had my first Giant Schnauzer litter in 1970, the year I also got my first Miniature Schnauzer, which I been breeding since then. At the moment there is only one Mini here. I have also owned and shown a Borzoi, Beagle, Airedale and a Smooth Fox Terrier.

I was licensed by the Swedish KC to judge all Schnauzers and Pinschers in 1977 and after that studied more breeds in the FCI groups, mostly in Working and Herding breeds, and Terriers and Sighthounds. In 2013 I was asked by the KC if I would like to do a special program to become an all-rounder. I did that and since December 2015 I got my all-rounder license from the FCI.

I have been judging in many countries during the years, both at bigger major shows and smaller specialties. I enjoy judging both the big shows but also very much breed-club shows. I like judging all breeds but of course Schnauzers/Pinschers and also the Terriers feel a bit special to me.

Since last year I retired from work and that is a very pleasant life.

I look forward very much to come back to Canada again and judge at your show.



## **KARLSDOTTER, NINA** | Sweden

Breeds: Giant Schnauzer, Miniature Schnauzer



My dog history started when I was young. In my family we had a Tibetan Spaniel and a Miniature Pinscher. My interest in Schnauzers started when I bought a Giant Schnauzer male in 1972 and a year later we also had a bitch in the house. In 1975, I bought my first Miniature Schnauzer, who did a lot of winning, including a once BIS in a big specialty show. I also had my first litter of Giant Schnauzer. In 1978, I bought two black Minis from U.S., a male and a bitch.

I started breeding Miniature Schnauzers (under the kennel prefix Impact) in 1978 and I have been lucky enough to say that my breeding has produced a lot of champions and so far I have been saved from serious problems. For about 10 years I also had black Standard Schnauzers.

I have also for long had interest in Affenpinscher and had

my first one, a male, in 1990. Today I have two bitches and I also had my first litter just recently. From the '80s, I also have some experience showing, grooming and breeding Border Terrier and Irish Terrier.

For many years, I have been a member of different committees for national kennel clubs and the Giant Schnauzer club, and I have been the Chairman of the Swedish Schnauzer-Pinscher Club for 10 years. For all that, I have been honoured with the Swedish Kennel Clubs badge for merit. At present, I am a member of the Swedish Kennel Club's judges committee.

**LIEBES, NANCY** | United States

Breeds: Komondor

Nancy grew up with English Springer Spaniels, and her first show dog was a Komondor imported from Hungary in 1970. After finishing her championship, and that of her son, she acquired two more Komondor bitches in the late 1970s and bred her first litter in 1979.

In 1980, Nancy bought a large boarding kennel with a grooming shop, continuing to show her dogs, run a handling class and breed the occasional litter. She branched out to sighthounds and also tried her hand at obedience competition and field trials.

During the 1980s Nancy won many Bests in Show and National Specialties with her Komondor bitch. Also winning groups with other Working breeds and Hounds. Nancy moved to Texas in 1990, stopped handling and started judging. Since then she has produced more than 50 champions in Komondors, plus many more in Ibizan Hounds, Vizslas, Whippets and Cavaliers. Producing 4 Best in Show Komondors, something nobody else has ever accomplished plus 7 National Specialty winners who garnered a total of 12 National Specialties. She also produced a National Specialty winning Ibizan Hound and a Best in Show Cavalier.

Nancy currently lives in Indiana with 2 Komondors, 3 Cavaliers, 4 English Toy Spaniels, 1 Russell Terrier, 2 cats, 7 chickens and a parrot.



**PEPPER, ALLAN E.** | Canada

Breeds: Whippet

I have had Whippets for over 40 years and bred under the kennel prefix Alery. I have been privileged to have bred some very nice dogs in that time span. One of my favourites was Am. & Can. Ch. Alery White Warlock, who was by Am. & Can. Ch. Morshor's Whirlaway out of Ch. Winterfold Shining Hour. One of the nicest bitches that I bred was Am. & Can. Ch. Alery Which Witches' Which who was a delight to watch moving. I later had Am. & Can. Ch. Astrologer of Alery who was a Specialty winner in the USA. I have owned Afghans, Silky Terriers and of course Whippets for many years.



I have been judging shows since 1976 here in Canada and have been able to judge and see many breeds in many different countries along the way. I have judged in Australia, Sweden, Finland, Norway, Denmark and the U.S. It has always been a pleasure to see dogs in different countries and assess them. My favourite thing is that we get to meet many people, from around the world who also judge. I stay in touch with many of them through this “thing.”

**RICHARDSON, JAY** | United States



Mr. Richardson began his lifelong involvement in purebred dogs at the age of 10, when his parents, Gerald and Jeanine Richardson purchased their first show dog, a Standard Poodle. His young years were involved in raising and caring for the family’s Poodles, showing both in Junior Showmanship and the conformation ring.

As a young teenager Mr. Richardson went to work after school in the Poodle kennels of J. Lynn and Mabel Welsh. After Mabel’s death and Lynn’s marriage to Dorothy Welsh he added Collies to the after-school care.

In his late teen years, Mr. Richardson went to work for Denny Kodner, an all-breed handler and worked for her until he began to handle professionally in 1975.

Mr. Richardson handled all breeds until he began judging in 1996. As a handler he enjoyed success with many breeds,

including a number of top-winning Best in Show dogs in several groups.

**SHELTON, WILLIAM (BILL) P.** | United States

Breeds: Pembroke Welsh Corgi

William P. Shelton, of Pomona, California, has been involved in the sport of purebred dogs since childhood. He has owned, bred, and shown multiple Best in Show- and specialty-winning dogs in several breeds.

His passion and focus has been directed to Pembroke Welsh Corgis. His Coventry Kennel has been elected “2012 Breeder of the Year” by the five-decade tradition of the DR Winkie awards.

Mr. Shelton writes on a wide range of dog-related topics for several publications and has lectured on canine anatomy at AKC Judges Institutes.

His judging career has taken him to many fascinating places around the world. He says his “greatest pleasure is adjudicating national specialties, and events like this AKC/Eukanuba National Championship.”



**STACY, JACQUELINE L.** | United States

Breeds: Pomeranian, Affenpinscher, Maltese, Skye Terrier



Jacqueline Stacy began exhibiting dogs in 1958. Her father, a German Shepherd Dog fancier, allowed her to pick the breed of her choice. Mrs. Stacy chose Pomeranians, and, with her sister Fran Smith, has bred over 50 champions to date. Mrs. Stacy has also been a breeder-exhibitor of Maltese, Skye Terriers, and Affenpinschers. Her breeding program has produced over 30 champion Affenpinschers, including four national-specialty and Best in Show winners.

Mrs. Stacy has been a member of the American Pomeranian Club for over 25 years, serving as a director, treasurer, and a member of the club's standard-revision committee. She has been a member of the American Maltese Association for 25 years and a member of the Affenpinscher Club of America (president and newsletter editor).



## CDJA & CKC ANNUAL JUDGES' SEMINAR



*Held in conjunction with the Caledon Kennel Association All-breed Shows*

**THIS IS A UNIQUE OPPORTUNITY TO SHOWCASE  
YOUR BREED AND EDUCATE JUDGES!**

If your club is interested in organizing an **ON-SITE 'KENNEL VISIT'**  
or has members available to provide **RINGSIDE MENTORING**, please contact

**Patty Milton** (519) 853-5593 | [k94milton@gmail.com](mailto:k94milton@gmail.com)

### PHOTOGRAPHY AND VIDEOTAPING

Still photography and videotaping or filming will be conducted at the Caledon Kennel Association show. Your entry in, or attendance at, the Caledon Kennel Association show constitutes your permission and consent to the Caledon Kennel Association and its assignees and licensees photographing, videotaping or filming to use the resulting photographic pictures, videotapes or films of yourself, your agents and/or your dogs for any purpose whatsoever and without payment or further release." No photography or videotaping may be conducted for the purpose of resale within the show precincts by anyone other than the official Show Photographer without express written consent from the Caledon Kennel Association.



---

## CONFORMATION TROPHY LIST



Through the generosity of its members and friends, the Caledon Kennel Association is pleased to offer the following trophies. Note: All trophies must be picked up on the day they are awarded. None will be mailed.

**Best in Show** Friday and Sunday – Trophy and Rosette

**Best Puppy in Show** all days – Trophy and Rosette

**All Group 1sts and All Best Puppy in Groups** – Trophy and Rosette  
all donated by Caledon Kennel Association

**Best In Show** Saturday – Tiffany Vase given in memory of Dr. William Stoyka from Anne McIntyre and Pat Berry

**Best Baby Puppy in Show** (Friday) – Trophy and Rosette

The following people have donated to the General Trophy Fund:  
Judi Orsi, Patty Milton, Michael & Rosemary Shoreman (Roschel Perm. Registered) and Carol Stubbs

### BREED PRIZES

Best Puppy, Golden Retrievers, all three days – Rob & Edie Ward,  
Baileymist Goldens

Best of Breed, Weimaraners, Saturday – Michael & Rosemary  
Shoreman, Roschel Perm. Reg'd

Best of Breed, Border Terriers, Friday – Michael & Rosemary  
Shoreman, Roschel Perm. Reg'd

Best of Breed, Irish Wolfhounds, Friday and Sunday – Judi Orsi

Best of Breed, Toy Poodles, Friday and Sunday – Carol Stubbs

Best of Breed, Toy Poodles, Saturday – Joan Ticknor, Joed Silver Toy  
Poodles

Best of Breed, Best of Opposite and Best of Winners, West Highland  
White Terriers, all three days – Lindy Barrow, Skyehigh Westies

### JUNIOR HANDLING

Donated by ringsideimages.ca

All junior handling competitors are invited to receive a free portrait session that they may use to accompany a resume or for other future purposes. The same offer applies should the junior wish to be photographed with their dog or family.

The winner of the Junior Handling Invitational on Sunday will receive a 16 x 20-inch Canvas Mounted print of their choice of:

- a) The Group Photo of all the competitors,
- b) The individual or family portrait, or
- c) The Best Overall Junior Official photo.



## NATIONAL BREEDERS' CLASSIC

**ENTRY DEADLINE:**  
**8 PM (EST) – WEDNESDAY, NOVEMBER 8, 2017**

Royal Canin National Breeders' Classic will be held midday,  
Saturday, November 25, 2017. (Judging will be scheduled so entered  
Breeders' Teams will not be judged at the All Breed during the Breeders' Classic.)

**SPECIAL THANKS TO:**

**FLOWER ARRANGEMENTS for Show Secretary, Royal Canin Booth and Ringside Images – Compliments of Suzanne Gardner Flowers. We look forward to your lovely arrangements every year.**



suzanne gardner  
F L O W E R S

**GREENERY FOR RINGS from Glen Echo Nurseries  
15070 Airport Road, Caledon, Ontario, for making  
our show beautiful. Your greenery is lovely.**

---

**EVENT  
REGISTRATION  
FEE**

Effective January 1, 1992, all dogs that are foreign born and foreign owned and enter Canada for the sole purpose of entering CKC events will no longer require a CKC registration number but will require an Event Registration Number (ERN).

The ERN number MUST be applied for within 30 days of the first day of entering a CKC event.

Fee is \$62.40 per dog after February 1, 2017, plus applicable taxes. For further information contact:

The Canadian Kennel Club  
Phone: (416) 675-5511  
Fax: (416) 675-6506  
information@ckc.ca  
Hours: 9:00 a.m. - 5:00 p.m. (Monday - Friday)

---

**NON-MEMBER  
PARTICIPATION  
FEE**

Effective January 1, 2011:

- a) A non-member participation fee will be charged to a resident of Canada who is a non-member of the CKC. The fee will be \$62.40 plus applicable taxes.
- b) The non-member participation fee is paid in any year a title is earned and covers all titles and dogs owned by that individual.
- c) In order for the title to be awarded, the non-member will have a choice to either become a CKC member or pay the non-member participation fee. Failure to comply within 30 days of notification will result in the title being withheld and the dog cannot be moved up to the next level.
- d) The fee applies only to dogs wholly owned by non-member residents of Canada and is not applicable to CKC members.

---

## CHAMPIONS AND CHAMPIONSHIP POINTS

Chapter 15, Section 15.1.1 A dog awarded Winners at a conformation show shall be credited with a number of championship points (ranging from 0 to 5) and the number of championship points credited to a dog awarded Winners shall be as provided hereunder.

Section 15.1.2 The schedule to be employed in the determination of the number of points to be allocated a dog awarded WINNERS shall be as follows:

Dogs competing*	1	2	3 to 5	6 to 9	10 to 12	13 or more
Points allocated	0	1	2	3	4	5

\*includes the dog awarded Winners.

In counting the number of eligible dogs in competition, a dog that is disqualified, dismissed, excused or ordered from the ring by the judge SHALL NOT be included in the calculation for championship points.

To determine the number of championship points earned by a dog awarded Winners, total all the dogs in competition which the dog defeated, directly or indirectly, for the highest of the following official breed awards: Winners, Best of Winners, Best of Breed, or Best of Opposite Sex and then consult the schedule set forth above.

Section 15.1.8 A Dog awarded Winners which also places in the regular Group competition shall be credited with the following additional points, provided that a dog was defeated at the group level, save that no more than five (5) points will be credited to a dog for a single show.

Number of Breeds Competing at Group Level	Dog Placed First	Dog Placed Second	Dog Placed Third	Dog Placed Fourth
13 or more	5	4	3	2
10 to 12	4	3	2	1
6 to 9	3	2	1	1
5	2	1	1	1
4	2	1	1	0
3	2	1	0	0
2	1	0	0	0
1	0	0	0	0

Section 15.1.11 A class dog awarded Best in Show at an all-breed Championship show will be credited with five points inclusive of any points earned at the breed or group level.

Section 15.1.12. In order for a dog to be recognized as a Champion and its owner provided with a Championship Certificate, the dog must have earned at least one 2 point win either at the breed or group level.

---

## MOVING CLASS DOGS TO SPECIALS

Chapter 8, Section 8.9 of the Conformation Show Rules and Regulations has been amended to allow a dog which is individually registered in the records of the Canadian Kennel Club, and has completed the requirements for a Championship, after the Closing Date for entries for a show, may be transferred from one of the Regular Classes to "Specials Only", providing the request for a transfer is submitted to the Show Secretary in WRITING at least one hour prior to the opening of the show, by the owner or handler. Every day of a 2 or 3 day show is a separate show. ***Please note that this rule is effective up to one hour prior to the opening of the show, NOT one hour prior to the judging of the breed.***

---

## CONFORMATION SHOW RULES AND REGULATIONS

The Exhibitor is responsible for knowing and complying with the Conformation Show Rules and Regulations of the Canadian Kennel Club. **Chapter 4 - Section 4.7.3** of the Conformation Show Rules and Regulations states: A judge officiating at a show held under these rules shall not be subjected to indignities of any kind during the progress of the show. It shall be the duty and obligation of the club holding the show to see that this rule is effectively carried out.

---

## ENTRY INFORMATION

1. No entry will be accepted unless all particulars called for on the entry form are completed in full. Handlers or agents please note the full name and address of all owners must be filled in.
2. Incomplete entries will be returned. No entry will be accepted unless accompanied by entry fees. Telephone and telegraph entries cannot be accepted. Exhibitors must abide by errors made in entering their dogs regardless of how or by whom the entries were made.
3. There is no refund for duplicate cheques. Every effort will be made to find all duplicate entries, however if the entry has been processed and appears in the official catalogue, no refund will be made.
4. Substitutions or cancellations of any entry after the closing date is prohibited. Moving Class Dogs to Specials is permitted. An error in the class, date of birth or sex may be amended on the entry form up to one hour before the start of the show. Only dogs that are already registered in the Canadian Kennel Club Stud Book, or are eligible for such registration, can be entered. The committee reserves the right to refuse any entry subject to CKC Rules. Entries close 8 PM (EST) WEDNESDAY, NOVEMBER 8, 2017, and must be in the hands of the Show Secretary by that date.
5. Identification cards and judging schedules will be e-mailed as soon as possible after the entries close. Identification cards must be printed and presented upon arrival at the show. We will be handing out wristbands at the exhibitor door – one dog, one wristband. Please be prepared to present your show I.D.
6. Tendering of NSF cheques in payment of fees shall be considered non-payment of fees and is punishable by disciplinary action. *Any NSF cheques will be subject to a \$20 service charge.*

---

## GENERAL INFORMATION

1. The Show Superintendent will be in full charge of the show which will be governed by CKC Rules.
2. The Caledon Kennel Association will use due care and diligence for the welfare of dogs and exhibitors, but will not be responsible for, or assume liability in the event of accident, or other misfortunes, to either dogs, exhibitors or patrons.
3. If, because of riot, civil disturbance or other acts beyond the control of management, it is impossible to open or to complete the show, no refund of Entry will be made.
4. Dogs should arrive in adequate time for their breed judging (allowing for absentees) and will be excused each show when not required for further judging. It is the responsibility of the exhibitors to have the dog at ringside when the dog's class is scheduled for judging. Waiting for dogs will not be possible and handlers with several breeds must arrange for alternate handlers if judging times for their breeds conflict.
5. Judging will commence at 8 a.m. each day. A later starting time may be specified in the judging schedule. Starting time of each ring will be specified in judging schedule.
6. Security will be provided and the building will be locked at 10 p.m. and re-opened for 6:30 a.m.
7. SHOW PRECINCTS – The Show precincts shall consist of all areas set out for breed conformation rings, and the facilities set aside for show officials, judges, exhibitors and handlers.
8. GROOMING AREA – Space will be at a premium in the grooming area. One x-pen area will be provided inside and there will be space outside adjacent to the building for private x-pens. No x-pens will be allowed during show hours. We ask that all exhibitors be mindful of keeping their area confined by stacking crates and keeping chairs and equipment to a minimum. Please see pre-booked grooming area notice in the premium list.
9. An IN-TRANSIT AREA will be available for owners/handlers who are transporting dogs not entered in the show. All dogs issued an In-Transit Pass must be 6 months of age or older. The owner/agent is responsible for the care of said dog.



## CALEDON KENNEL ASSOCIATION **LIMITED BREED SHOWS**

---

### **WORKING GROUP** FRIDAY, NOVEMBER 24

**Jay Richardson**  
38WO24 Heatherfield Drive, Elgin, IL 60124-880, USA  
*All Official Classes, Baby Puppy & Group*

Through the generosity of the members and friends of the Caledon Kennel Association, a rosette and prize will be offered for Group 1st, Group 2nd, Group 3rd, Group 4th, Best Puppy in Group and Best Baby Puppy in Group.

---

**JUDGE &  
ASSIGNMENTS**

---

**TROPHIES**

### **TERRIER GROUP** FRIDAY, NOVEMBER 24

**Jacqueline Stacy**  
116 Ocoee Falls Dr., Chapel Hill, NC 27517-9531836, USA  
*All Official Classes, Baby Puppy (except Norfolk Terrier) & Group*

**Allan E. Pepper**  
4122 Concession 11, Moffat, ON L0P 1J0  
*Norfolk Terrier Official Classes & Baby Puppy*

Through the generosity of the members and friends of the Caledon Kennel Association, a rosette and prize will be offered for Group 1st, Group 2nd, Group 3rd, Group 4th, Best Puppy in Group and Best Baby Puppy in Group.

---

**JUDGES &  
ASSIGNMENTS**

---

**TROPHIES**

### **NON-SPORTING GROUP** SATURDAY, NOVEMBER 25

**Benny Blid Von Schedvin**  
Strömman 205, SE-310 63 Älvsered, Sweden  
*All Official Classes & Group*

Through the generosity of the Caledon Kennel Association, and the ongoing support from Pat Berry & Anne McIntyre, a rosette and prize will be offered for Group 1st, Group 2nd, Group 3rd, Group 4th, Best Puppy in Group.

---

**JUDGE &  
ASSIGNMENTS**

---

**TROPHIES**

### **SPORTING GROUP** SUNDAY, NOVEMBER 26

**Benny Blid Von Schedvin**  
Strömman 205, SE-310 63 Älvsered, Sweden  
*All Official Classes & Group*

Through the generosity of the members and friends of the Caledon Kennel Association, a rosette and prize will be offered for Group 1st, Group 2nd, Group 3rd, Group 4th, Best Puppy in Group.

---

**JUDGE &  
ASSIGNMENTS**

---

**TROPHIES**

---

## **BOOSTERS**

The Caledon Kennel Association has graciously donated rosettes for Best of Breed, Best of Opposite Sex, Best of Winners, Winners Dog, Winners Bitch and Best Puppy.

### **SPORTING DOGS**

#### **GERMAN SHORTHAIRED POINTER CLUB OF CANADA**

**Saturday, November 25, 2017 | Judge: Nina Karlsdotter**

A trophy will be offered for Best of Breed, Best of Opposite, Best of Winners, Winners Dog, Winners Bitch, Select Dog, Select Bitch and Best Puppy.

#### **LABRADOR OWNERS CLUB**

**Saturday, November 25, 2017 | Judge: Nina Karlsdotter**

A trophy will be offered for Best of Breed, Best of Opposite, Best of Winners, Winners Dog, Winners Bitch and Best Puppy.

#### **ONTARIO NOVA SCOTIA DUCK TOLLING RETRIEVER CLUB**

**Saturday, November 25, 2017 | Judge: Nina Karlsdotter**

A trophy will be offered for Best of Breed, Best of Opposite, Best of Winners, Winners Dog, Winners Bitch, Select Dog, Select Bitch and Best Puppy.

### **HOUNDS**

#### **ONTARIO SIGHTHOUND ASSOCIATION**

**Saturday, November 25, 2017 | Judge: Jacqueline Stacy**

A trophy will be offered for Best of Breed and Best Puppy for each breed (*Afghan, Basenji, Borzoi, Deerhound, Greyhound, Ibizan, Irish Wolfhound, Pharoah Hound, Saluki, Whippet*). CKA will provide rosettes for BB, BP for each breed.

#### **AFGHAN HOUND CLUB OF CANADA**

**Friday, November 24, 2017 | Judge: William (Bill) Shelton**

**Sunday, November 26, 2017 | Judge: Nina Karlsdotter**

A trophy will be offered for Best of Breed, Best of Opposite, Best of Winners, Winners Dog, Winners Bitch, Select Dog, Select Bitch and Best Puppy, courtesy of Dee Devins, Tokabout.

#### **BEAGLE CLUB OF CANADA**

**Saturday, November 25, 2017 | Judge: William (Bill) Shelton**

A trophy will be offered for Best of Breed, Best of Opposite, Best of Winners, Winners Dog, Winners Bitch, Select Dog, Select Bitch and Best Puppy.

FOR <sup>THE</sup> Love OF  
PUREBRED  
DOGS 



**WILL BE IN ATTENDANCE THROUGHOUT THE WEEKEND AT THE CALEDON SHOW**

---

**BOOSTERS**

*continued*

**WHIPPET CLUB OF EASTERN CANADA**

Sunday, November 26, 2017 | Judge: William (Bill) Shelton

A trophy will be offered for Best of Breed, Best of Opposite, Winners Dog, Winners Bitch and Best Puppy.

**WORKING DOGS****BERNESE MOUNTAIN DOG CLUB OF ONTARIO**

Saturday, November 25, 2017 | Judge: Nancy Liebes

A trophy will be offered for Best of Breed, Best of Opposite, Winners Dog, Winners Bitch, Select Dog, Select Bitch and Best Puppy.

**BERNESE MOUNTAIN DOG CLUB OF CANADA**

Sunday, November 26, 2017 | Judge: William (Bill) Shelton

A trophy will be offered for Best of Breed, Best of Opposite, Winners Dog, Winners Bitch, Select Dog, Select Bitch and Best Puppy.

**DOGUE DE BORDEAUX CLUB OF CANADA**

Sunday, November 26, 2017 | Judge: Nancy Liebes

A trophy will be offered for Best of Breed, Best of Opposite, Best of Winners, Winners Dog, Winners Bitch, Select Dog, Select Bitch and Best Puppy.

**GIANT SCHNAUZER CANADA**

Saturday, November 25, 2017 | Judge: Nina Karlsdotter

Sunday, November 26, 2017 | Judge: Benny Blid Von Schedvin

A trophy will be offered for Best of Breed, Best of Opposite, Winners Dog, Winners Bitch and Best Puppy.

**GREATER MID-ONTARIO DOBERMAN FANCIERS**

Sunday, November 26, 2017 | Judge: William (Bill) Shelton

A trophy will be offered for Best of Breed, Best of Opposite, Best of Winners, Winners Dog, Winners Bitch and Best Puppy.

**LEONBERGER CLUB OF ONTARIO**

Saturday, November 25, 2017 | Judge: Nancy Liebes

A trophy will be offered for Best of Breed, Best of Opposite, Best of Winners, Winners Dog, Winners Bitch, Select Dog, Select Bitch and Best Puppy.

**LEONBERGER CLUB OF CANADA**

Sunday, November 26, 2017 | Judge: William (Bill) Shelton

A trophy will be offered for Best of Breed, Best of Opposite, Best of Winners, Winners Dog, Winners Bitch, Select Dog, Select Bitch and Best Puppy.

**PORTUGUESE WATER DOG CLUB OF CANADA**

Saturday, November 25, 2017 | Judge: Nancy Liebes

A trophy will be offered for Best of Breed, Best of Opposite, Best of Winners, Winners Dog, Winners Bitch, Select Dog, Select Bitch and Best Puppy.

---

## **BOOSTERS**

*continued*

### **SAMOYED CLUB OF ONTARIO**

**Sunday, November 26, 2017 | Judge: Nina Karlsdotter**

A trophy will be offered for Best of Breed, Best of Opposite, Winners Dog, Winners Bitch and Best Puppy.

### **SIBERIAN HUSKY CLUB OF ONTARIO**

**Friday, November 26, 2017 | Judge: Benny Blid Von Shedvin**

A trophy will be offered for Best of Breed, Best of Opposite, Winners Dog, Winners Bitch, Select Dog, Select Bitch and Best Puppy.

### **SIBERIAN HUSKY CLUB OF CANADA, Golden Horseshoe Area**

**Saturday, November 25, 2017 | Judge: Jacqueline Stacy**

A trophy will be offered for Best of Breed, Best of Opposite, Winners Dog, Reserve Winners Dog, Winners Bitch, Reserve Winners Bitch, Select Dog, Select Bitch and Best Puppy.

### **SIBERIAN HUSKY CLUB OF CANADA**

**Sunday, November 26, 2017 | Judge: William (Bill) Shelton**

A trophy will be offered for Best of Breed, Best of Opposite, Winners Dog, Winners Bitch and Best Puppy.

### **STANDARD SCHNAUZER CLUB OF CANADA**

**Saturday, November 25, 2017 | Judge: Nina Karlsdotter**

A trophy will be offered for Best of Breed, Best of Opposite, Winners Dog, Winners Bitch and Best Puppy.

## **TERRIERS**

### **BORDER TERRIER CLUB OF ONTARIO**

**Saturday, November 25, 2017 | Judge: Benny Blid Von Schedvin**

A trophy will be offered for Best of Breed, Best of Opposite, Winners Dog, Winners Bitch and Best Puppy.

## **PRE-PAID RESERVED GROOMING AREAS and POWER**

Enjoy the luxury of pre-booked grooming space and be assured that your space will be there for you when you choose to arrive. (A pre-booked grooming space is required if you plan to order power.)

**Reserved Grooming must be ordered online at [www.caledondogs.ca](http://www.caledondogs.ca) starting on TUESDAY, SEPTEMBER 12TH, 2017.** Power must be ordered online at <https://e.showtechordering.com/ST-00049864> or by calling 905-283-0550.

**NOTE:** Power Special Rate until November 9, 2017 – \$167 for outlet capable of running one dryer and one minor electrical tool. \$199 for outlet capable of running two dryers.

**IMPORTANT: Last day to book grooming is November 21, 2017.**



---

## **BOOSTERS**

*continued*

### **BORDER TERRIER CANADA**

**Sunday, November 26 2017 | Judge: Nina Karlsdotter**

A trophy will be offered for Best of Breed, Best of Opposite, Winners Dog, Winners Bitch, Select Dog, Select Bitch and Best Puppy.

### **DANDIE DINMONT CLUB OF CANADA**

**Saturday, November 25, 2017 | Judge: Benny Blid Von Schedvin**

**Sunday, November 26, 2017 | Judge: Jay Richardson**

A trophy will be offered for Best of Breed, Best of Opposite, Best of Winners, Winners Dog, Winners Bitch, Select Dog, Select Bitch and Best Puppy.

### **MINIATURE SCHNAUZER CLUB OF CANADA**

**Saturday, November 25, 2017 | Judge: Benny Blid Von Schedvin**

A trophy will be offered for Best of Breed, Best of Opposite, Best of Winners, Winners Dog, Winners Bitch, Select Dog, Select Bitch and Best Puppy.

### **NORFOLK TERRIER CLUB OF CANADA**

**Friday, November 24, 2017 | Judge: Nina Karlsdotter**

A trophy will be offered for Best of Breed, Best of Opposite, Best of Winners, Winners Dog, Winners Bitch, Select Dog, Select Bitch and Best Puppy.

## TOYS

### **CAVALIER FANCIERS OF SOUTHERN ONTARIO CLUB**

**Sunday, November 26, 2017 | Judge: Nancy Liebes**

A trophy will be offered for Best of Breed, Best of Opposite, Winners Dog, Winners Bitch, Select Dog, Select Bitch and Best Puppy.

## NON-SPORTING DOGS

### **BULLDOG CLUB OF CANADA**

**Saturday, November 25, 2017 | Judge: Jacqueline Stacy**

A trophy will be offered for Best of Breed, Best of Opposite, Best of Winners, Winners Dog, Winners Bitch, Select Dog, Select Bitch and Best Puppy

### **FRENCH BULLDOG CLUB OF CENTRAL CANADA**

**Saturday, November 25, 2017 | Judge: Jacqueline Stacy**

A trophy will be offered for Best of Breed, Best of Opposite, Best of Winners, Winners Dog, Winners Bitch, Select Dog, Select Bitch and

## **PLEASE PICK UP AFTER YOUR DOGS**

Let's show the public how responsible we are as dog owners. Please pick up after your dogs. It's your responsibility. Video surveillance will be activated in the parking lots and the outside perimeters of the building. *This is not the way to get onto Facebook.*

---

## **BOOSTERS**

*continued*

Best Puppy

### **LHASA APSO CANADA**

**Saturday, November 25, 2017 | Judge: Jacqueline Stacy**

A trophy will be offered for Best of Breed, Best of Opposite, Best of Winners, Winners Dog, Winners Bitch, Select Dog, Select Bitch and Best Puppy

### **MINIATURE POODLE CLUB OF ONTARIO**

**Sunday, November 26, 2017 | Judge: William (Bill) Shelton**

A trophy will be offered for Best of Breed, Best of Opposite, Winners Dog, Winners Bitch and Best Puppy

## **HERDING DOGS**

### **CANADIAN COLLIE AND SHETLAND SHEEPDOG ASSOCIATION**

**Saturday, November 25, 2017 | Judge: William (Bill) Shelton**

A trophy will be offered for Best of Breed, Best of Opposite, Best of Winners, Winners Dog, Winners Bitch, Select Dog, Select Bitch and Best Puppy (for each breed).

### **OLD ENGLISH SHEEPDOG OWNERS' CLUB OF CANADA**

**Sunday, November 26, 2017 | Judge: Jacqueline Stacy**

A trophy will be offered for Best of Breed, Best of Opposite, Best of Winners, Winners Dog, Winners Bitch, Select Dog, Select Bitch and Best Puppy.



## **CDJA & CKC ANNUAL JUDGES' SEMINAR**



*Held in conjunction with the Caledon Kennel Association All-breed Shows*

### **THIS IS A UNIQUE OPPORTUNITY TO SHOWCASE YOUR BREED AND EDUCATE JUDGES!**

If your club is interested in organizing an **ON-SITE 'KENNEL VISIT'** or has members available to provide **RINGSIDE MENTORING**, please contact

**Patty Milton** (519) 853-5593 | [k94milton@gmail.com](mailto:k94milton@gmail.com)

## **CANINE GOOD NEIGHBOUR TESTING**

Caledon Kennel Association is offering testing for CGN Certificates at the show on

**Saturday, November 25 & Sunday, November 26 | 10 am to 4 pm**

**Cost: \$25 per dog**

Registrations will be accepted at the time of evaluation or at the CKA booth. Don't forget to bring your dog's CKC registered name and registration number.



OFFICIAL CANADIAN KENNEL CLUB FORM  
**CONFORMATION**  
**CALEDON KENNEL ASSOCIATION**

**CLOSING DATE: 8 P.M. (EST)  
 WEDNESDAY, NOV. 8, 2017**

Make fees payable to  
**Caledon Kennel Association**  
 and mail to:  
 MJN Show Services,  
 9 Samya Court  
 Scarborough, ON M1R 2A4

- Fri., November 24, 2017  
 Sat., November 25, 2017  
 Sun., November 26, 2017

Entry Fees \$ \_\_\_\_\_  
 (\$32.00 per show)  
 Listing Fees \$ \_\_\_\_\_  
 (\$9.60 per show)  
 Baby Puppy \$ \_\_\_\_\_  
 (\$15.00)  
 Exhibition Only \$ \_\_\_\_\_  
 (\$10.00 per show)  
 CATALOGUE \$ \_\_\_\_\_  
 (\$8.00 each)  
 TOTAL enclosed \$ \_\_\_\_\_

**Limited Breed Shows:**

- Working Group (Nov. 24)  
 Terrier Group (Nov. 24)  
 Non-Sporting Group (Nov. 25)  
 Sporting Group (Nov. 26)

*Please type or print clearly*

Breed _____	Variety _____	Sex _____
-------------	---------------	-----------

Enter in the following Classes:

- |  |  |  |
|--|--|--|
| <input type="checkbox"/> Junior Puppy  | <input type="checkbox"/> Bred by Exhibitor   | <input type="checkbox"/> Exhibition Only |
| <input type="checkbox"/> Senior Puppy  | <input type="checkbox"/> Open  | <input type="checkbox"/> Catalogue       |
| <input type="checkbox"/> 12 - 18 Month | <input type="checkbox"/> Specials Only   |  |
| <input type="checkbox"/> Canadian Bred | <input type="checkbox"/> Baby Puppy ( <i>Friday only, including Friday's Limited Shows</i> ) |  |

Reg. Name of Dog \_\_\_\_\_

Check One – and – Enter Number here

- CKC Reg. No.  
 CKC ERN No.  
 CKC Misc. Cert. No.  
 Listed

Date of Birth D _____ M _____ Y _____	Is this a puppy? YES ___ NO ___
Place of Birth <input type="checkbox"/> Canada <input type="checkbox"/> Elsewhere	

Breeder(s) \_\_\_\_\_

Sire \_\_\_\_\_

Dam \_\_\_\_\_

Reg'd Owner(s) \_\_\_\_\_

Owner's Address \_\_\_\_\_

City _____	Prov. _____	Code _____
------------	-------------	------------

Name of Owner's Agent (if any)  
 at the Show \_\_\_\_\_

Agent's Address \_\_\_\_\_

City _____	Prov. _____	Code _____
------------	-------------	------------

Mail I.D. to  Owner or  Agent **Email** \_\_\_\_\_

**FAX/CREDIT CARD ENTRIES**

Amer Express  Mastercard  VISA Card No. \_\_\_\_\_ Expiry \_\_\_\_\_

Name of Cardholder \_\_\_\_\_ Signature \_\_\_\_\_

I CERTIFY that I am the registered owner(s) of the dog or that I am the authorized agent of the owner(s) whose name(s) I have entered above and accept full responsibility for all statements made in this entry. In consideration of the acceptance of this entry I (we) agree to be bound by the rules and regulations of the Canadian Kennel Club and by any additional rules and regulations appearing in the premium list. Also by signing this form, I certify that I will not hold the Show giving Club, its members, directors, employees or agents liable in the event of any accident of misfortune however caused.

SIGNATURE OF OWNER OR AGENT \_\_\_\_\_

TELEPHONE NO. \_\_\_\_\_

# JUNIOR HANDLING EVENTS

## The Caledon Kennel Association will host 2 JUNIOR HANDLING COMPETITIONS

One on **SATURDAY, NOVEMBER 25, 2017**, supported by Best in Show Dog Supplies with 1st in each class and Best Overall Junior Handler gift certificates. Judge for Saturday's Junior Competition will be Colin Brownlee.

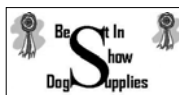

The other on **SUNDAY, NOVEMBER 26, 2017**, supported by the Caledon Kennel Association with 1st in each class and Best Overall Junior Handler prizes. Judge for Sunday's Junior Competition will be Elizabeth Numbers.

*All Best Overall Junior Handler judging will be done prior to the Groups on Saturday and Sunday.*

Held under CKC Rules

<b>CLASSES:</b>	Pee Wee	4 – 6 yrs. (non-competitive)
	Junior	7 – 10 yrs. (Novice and Open)
	Intermediate	11 – 14 yrs. (Novice and Open)
	Senior	15 – up to but not incl. 18 yrs. (Novice and Open)
	Best Overall	(excluding Pee Wee)

All dogs for Junior Handling must be entered in one of the Official Classes or Exhibition Only on the day of competition. Entry to be made at the show. Complete rules will appear in the Show Catalogue.

*Ribbons and Rosettes donated by MJN Show Services.*

## JUNIOR HANDLING INVITATIONAL (UNOFFICIAL) BEST JUNIOR HANDLER OF THE CALEDON KENNEL ASSOCIATION SHOWS

No entry is required as this is an unofficial invitational competition. All first-place winners, at each competitive level, from each of the two days of Juniors, will be invited to compete in this event. There will be no Ribbons or Rosettes presented at this level. The six winners will advance to the final judging, where a single award will be given. *Judged on Sunday prior to Best in Show.*

**BEST OVERALL – \$200 CASH** *Donated by Caledon Kennel Association*

**The five remaining Junior Handlers will receive \$50 CASH**

Judge for The Invitational – **Allison Foley, CPHA**

## JUNIOR HANDLING NUMBERS

Effective January 1, 2016, Junior Handlers with the exception of PeeWees, must apply to CKC Head Office on the appropriate form for a Junior Handling Number within 30 days of competing in their first Junior Handling event. This Junior Handling Number will be used by the Junior Handler for the duration of their Junior Handling career. If a Junior Handling number is not obtained, Junior Handling points earned will not be tracked.



## JUNIOR HANDLING TRAINING

There will be Junior Handling training, compliments of the Canadian Professional Handlers Association, held on Friday evening, at 7 p.m. Just come along with your dog to the show site and learn from the Pros.



OFFICIAL CANADIAN KENNEL CLUB FORM  
SPECIALTY CONFORMATION ENTRY FORM

**CALEDON KENNEL ASSOCIATION**

**CLOSING DATE: 8 P.M. (EST) – WEDNESDAY, NOVEMBER 8, 2017**

Make fees payable to **Caledon Kennel Association** and mail to:

MJN Show Services  
9 Samya Court  
Scarborough, ON M1R 2A4

Entry fee	\$32.00	_____
Listing fee	\$9.60	_____
Sweepstakes	\$15.00	_____
Altered	\$32.00	_____
Baby Puppy	\$15.00	_____
Non-Regular	\$10.00	_____
Unofficial	\$10.00	_____
Exhibition Only	\$10.00	_____
Catalogue	\$8.00	_____
<b>TOTAL</b>		_____

- |  |   |
|--|---|
| <input type="checkbox"/> GERMAN SHORTHAIRED POINTER CLUB OF CANADA | <input type="checkbox"/> LAKESIDE TOY DOG FANCIERS                                |
| <input type="checkbox"/> DOGUE DE BORDEAUX CLUB OF CANADA NATIONAL | <input type="checkbox"/> THE CANADIAN YORKSHIRE TERRIER ASSOCIATION INC. NATIONAL |
| <input type="checkbox"/> SAMOYED CLUB OF ONTARIO                   | <input type="checkbox"/> MINIATURE POODLE CLUB OF ONTARIO                         |
| <input type="checkbox"/> SIBERIAN HUSKY CLUB OF CANADA NATIONAL    | <input type="checkbox"/> OLD ENGLISH SHEEPDOG OWNER'S CLUB OF CANADA NATIONAL     |
| <input type="checkbox"/> SIBERIAN HUSKY CLUB OF ONTARIO            |   |
| <input type="checkbox"/> NORFOLK TERRIER CLUB OF CANADA            |   |

- |  |  |  |   |
|--|--|--|---|
| <input type="checkbox"/> Junior Puppy      | <input type="checkbox"/> Veterans 7 to 9 Years | <input type="checkbox"/> Brace                       | <input type="checkbox"/> 6 to 9 Months                            |
| <input type="checkbox"/> Senior Puppy      | <input type="checkbox"/> Veterans 10 Years +   | <input type="checkbox"/> Team                        | <input type="checkbox"/> 9 to 12 Months                           |
| <input type="checkbox"/> 12-18 Months      | <input type="checkbox"/> Specials Only         | <input type="checkbox"/> Exhibition Only             | <input type="checkbox"/> 12 to 18 Months                          |
| <input type="checkbox"/> 12-15 Months      | <input type="checkbox"/> Sexually Altered      | <b>UNOFFICIAL CLASSES</b>                            | <b>VETERANS SWEEPS</b>  |
| <input type="checkbox"/> 15-18 Months      | <b>NON-REG. CLASSES</b>                        | <input type="checkbox"/> Pointing Dog/Bitch (GSP)    | <input type="checkbox"/> 7 to 9 Years                             |
| <input type="checkbox"/> Open              | <input type="checkbox"/> Baby Puppy            | <input type="checkbox"/> Sled Dog (Sibes)            | <input type="checkbox"/> 10 Years +                               |
| <input type="checkbox"/> Canadian Bred     | (GSP, Yorkie, Lakeside Toy)                    | <input type="checkbox"/> Working Dog (Sibes)         | <input type="checkbox"/> Catalogue                                |
| <input type="checkbox"/> Bred by Exhibitor | <input type="checkbox"/> Stud Dog              | <b>SWEEPSTAKES</b>                                   | <i>Please consult individual specialties for classes offered.</i> |
| <input type="checkbox"/> Veterans          | <input type="checkbox"/> Brood Bitch           | <input type="checkbox"/> 3 to 6 Months (GSP, Yorkie) |   |

Breed	Variety/Colour	Sex
-------	----------------	-----

Reg. Name of Dog

Check One – and – Enter Number here

- CKC Reg. No. \_\_\_\_\_
- CKC ERN No. \_\_\_\_\_
- CKC Misc. Cert. No. \_\_\_\_\_
- Listed

Date of Birth	Is this a puppy?
D _____ M _____ Y _____	YES ___ NO ___

Place of Birth
<input type="checkbox"/> Canada <input type="checkbox"/> Elsewhere

Breeder(s)

Sire

Dam

Reg'd Owner(s)

Owner's Address

City	Prov.	Code
------	-------	------

Name of Owner's Agent (if any)  
at the Show

Agent's Address

City	Prov.	Code
------	-------	------

Mail I.D. to  Owner or  Agent **Email** \_\_\_\_\_

**FAX/CREDIT CARD ENTRIES**

Amer Express  Mastercard  VISA Card No. \_\_\_\_\_ Expiry \_\_\_\_\_

Name of Cardholder \_\_\_\_\_ Signature \_\_\_\_\_

I CERTIFY that I am the registered owner(s) of the dog or that I am the authorized agent of the owner(s) whose name(s) I have entered above and accept full responsibility for all statements made in this entry. In consideration of the acceptance of this entry I (we) agree to be bound by the rules and regulations of the Canadian Kennel Club and by any additional rules and regulations appearing in the premium list. Also by signing this form, I certify that I will not hold the Show giving Club, its members, directors, employees or agents liable in the event of any accident of misfortune however caused. I assume full responsibility for confirming receipt of all emailed entries with the Show Secretary.

SIGNATURE OF OWNER OR AGENT

TELEPHONE NO.

# **SPECIALTY CONFORMATION CLASSES – BOTH SEXES**

## **REGULAR CLASSES:**

**JUNIOR PUPPY** – a dog between 6 months and under 9 months on day of show.

**SENIOR PUPPY** – a dog between 9 months and under 12 months on day of show.

**12-18 MONTHS** – a dog between 12 months and under 18 months on day of show.

**12 – 15 MONTHS** – a dog between 12 months and under 15 months on day of show.

**15 – 18 MONTHS** – a dog between 15 months and under 18 months on day of show.

**CANADIAN BRED** – a dog born in Canada.

**BRED BY EXHIBITOR** – dogs owned and handled in the ring by the breeder. The handler must be the owner/co-owner AND breeder/co-breeder of the dog. The breeder/owner must handle the dog in this class, but need not handle the dog for further awards.

**OPEN CLASS** – for all dogs.

**VETERANS CLASS (Specialty Shows Only)** – for all dogs over 7 years of age as of the date of the show. These dogs to compete for the regular placements, and the 1st-place dog and bitch will go on to compete for Best of Breed. Veterans may be broken down into separate age categories. The winner of the Veterans Class will not compete for points but go directly into the Best of Breed competition. Dogs entered in this class may be spayed or neutered.

**SPECIALS ONLY** – dogs that are Canadian Champions.

## **NON-REGULAR CLASSES:**

**BABY PUPPY** – a dog between 3 months and under 6 months on day of show. Baby Puppies do not compete for points.

**STUD DOG & GET** – Stud Dog and two or more of his get. Stud must be entered in a Regular class or Exhibition Only. Get must be entered in a Regular class. Stud Dog may be neutered. Ownership in this class need not be identical.

**BROOD BITCH & PROGENY** – Brood Bitch and two or more of her progeny. Brood Bitch must be entered in a Regular class or Exhibition Only. Progeny must be entered in a Regular class. Brood Bitch may be spayed. Ownership in this class need not be identical.

**BRACE** – Two dogs shown by a single handler on one lead. Ownership in this class need not be identical.

**TEAM** – The requirements for this class are the same as those for the Brace Class except that four dogs shall be entered. Ownership in this class need not be identical.

**EXHIBITION ONLY** – All dogs entered in this class shall be listed in the catalogue with the same particulars as dogs entered in Regular competition. Dogs entered in this class may not compete in any Regular class but may enter and compete in Non-Regular/Unofficial classes and/or Parades.

## **SEXUALLY ALTERED CLASSES:**

Limited to dogs and bitches over 6 months of age that have been sexually altered by veterinarian procedure.

## **UNOFFICIAL CLASSES:**

For a list of unofficial classes, refer to individual breed specialties.

## **SWEEPSTAKES:**

For sweepstakes information, refer to individual breed specialties



## REGIONAL SPECIALTY SHOW GERMAN SHORTHAIRED POINTER CLUB OF CANADA

Saturday, November 25, 2017

---

### GERMAN SHORTHAIRED POINTER CLUB OF CANADA OFFICERS

*President*  
*Vice-President*  
*Secretary*  
*Treasurer*

Maria Foster  
Francois-R Bernier  
Heather Brennan  
Barbara Taws

---

### SHOW COMMITTEE

*Show Coordinator*  
Maria Foster | [aspenglow@sympatico.ca](mailto:aspenglow@sympatico.ca)  
*Show Superintendent & Secretary*  
MJN Show Services  
9 Samya Court, Scarborough, ON M1R 2A4  
(416) 759-8593 | [www.mjnshowservices.com](http://www.mjnshowservices.com)

---

### JUDGES AND ASSIGNMENTS

**Garth Gourley**  
231 11th Concession East, Freulton, ON L8B 1H7  
*All Official Classes, Veterans, Baby Puppy, Altered, Stud Dog, Brood Bitch, Pointing Dog and Pointing Bitch*

**Jeannette Warner Desruisseaux**  
978 Buchner Road, R.R. 1, Welland, ON L3B 5N4  
*3-18 Month and Veteran Sweepstakes*

---

### TROPHIES AND AWARDS

Through the generosity of members and friends, the German Shorthaired Pointer Club of Canada will offer a rosette and prize for the following awards: Best of Breed, Best of Opposite Sex, Best of Winners, Winners Dog, Winners Bitch, Reserve Winners Dog, Reserve Winners Bitch, Select Dog, Select Bitch, Best Puppy, Best Baby Puppy, Award of Merit, Best of Breed Altered, Best of Opposite Sex Altered Best Veteran, Veteran Dog, Veteran Bitch, Stud Dog, Brood Bitch, Best Pointing Dog, Best Pointing Bitch, Best in Sweeps and Best of Opposite in Sweeps, Best in Veteran Sweeps and Best of Opposite Veteran Sweeps.

*Award of Merit:* At the judge's discretion, Award of Merit may be awarded up to one award for every 10 dogs competing for Best of Breed, which will be presented following Best of Breed judging.

---

### SWEEPSTAKES

**6-18 MONTHS** – The following classes are offered: Baby Puppy (3-6 months) Junior (6-9 months), Senior (9-12 months), Open (12-18 months) on the day of the specialty. Classes are divided by sex. First Place winners of each class will compete for Best in Sweepstakes and Best of Opposite Sex in Sweepstakes. Dogs entered in Sweepstakes must be entered in one of the Regular Classes at the Specialty.

**VETERAN** – The following classes are offered: 7 to 10 years, 10 to 12 years, 12 years and older on the day of the specialty. Classes are divided by sex. First Place winners of each class will compete for Best in Sweepstakes and Best of Opposite Sex in Sweepstakes. Dogs entered in Sweepstakes must be entered in one of the Official Classes at the Specialty. Spayed and neutered dogs may compete.

---

**SWEEPSTAKES  
PRIZE MONEY**

**SWEEPSTAKES PRIZES** – Money received in entry fees shall be divided as follows: 25% of total fees will be retained by the club for administration. Best in Sweepstakes will receive 25% of total entry fee. Best of Opposite Sex in Sweepstakes will receive 20% of total entry fee. First Place winners in each class will divide the remaining 30% of the total entry fee.

---

**UNOFFICIAL  
CLASSES**

**POINTING DOG & POINTING BITCH** – Shall be for all German Shorthaired Pointers who have earned a Qualifying score at a Licensed CKC Field Dog Test (Canada) or at a Licensed AKC Hunting Test (USA), or have received a placement at a Licensed CKC Field Trial (Canada) or at a Licensed AKC Field Trial (USA) prior to the closing of entries. Dogs must be at least 6 months of age or older and eligible for registration. Each entrant for Field Dog or Field Bitch Class must be entered in one of the Official Classes in the specialty or exhibition only. This class is divided by sex.





## NATIONAL SPECIALTY SHOW DOGUE DE BORDEAUX CLUB OF CANADA

Saturday, November 25, 2017

---

### DOGUE DE BORDEAUX CLUB OF CANADA OFFICERS

*President*  
*Vice-President*  
*Secretary*  
*Treasurer*

Richard Larocque  
Peter Muth  
Carole Saunders  
Cindy Wisman

---

### SHOW COMMITTEE

*Show Coordinator*  
Peter Muth | [pmuth@explornet.com](mailto:pmuth@explornet.com)

*Trophy Chair*, Cindy Wisman  
*Hospitality*, Janine Cummings  
*Fundraising*, Kiara Beaulieu

*Show Superintendent & Secretary*  
MJN Show Services  
9 Samya Court, Scarborough, ON M1R 2A4  
(416) 759-8593 | [www.mjnshowservices.com](http://www.mjnshowservices.com)

---

### JUDGE AND ASSIGNMENT

**William (Bill) Shelton**  
165A Columbia Avenue, Coventry Cottage, Pomona, CA 91767-3829  
*All Official Classes, 12-18 Month Class (divided 12-15 Month  
and 15-18 Month), Veterans, Altered, Stud Dog, Brood Bitch, Brace*

---

### TROPHIES AND AWARDS

Through the generosity of members and friends, the Dogue de Bordeaux Club of Canada will offer a rosette and prize/trophy for Best of Breed, Best of Opposite Sex, Best of Winners, Winners Dog, Winners Bitch, Reserve Winners Dog, Reserve Winners Bitch, Select Dog, Select Bitch, Best Puppy, Award of Merit, Best Veteran, Best Veteran Dog, Best Veteran Bitch, Stud Dog, Brood Bitch, Brace, Best Bred By Exhibitor, Best of Breed Altered, Best of Opposite Sex Altered, Best Junior Handler.

**PERPETUAL TROPHY:** A perpetual trophy will be presented for Best in Specialty Show. *A suitable keeper trophy will be awarded.*

**Award of Merit:** At the judge's discretion, Award of Merit may be awarded up to one award for every 10 dogs competing for Best of Breed, which will be presented following Best of Breed judging.

**Best Bred By Exhibitor:** All eligible dogs not directly or indirectly defeated by another eligible dog can compete for this award. All dogs must be breeder/owner-handled throughout the competition.

**Best Veteran:** All eligible dogs not directly or indirectly defeated by another eligible dog can compete for this award.

---

**JUNIOR  
HANDLING**

*Judge to be announced.* Held under CKC rules and class divisions. The Dogue de Bordeaux handled by the Junior must be entered in the Specialty in an Official class OR for Exhibition Only. The dog used need NOT be owned by the Junior or any member of his/her family. Prizes/ribbons will be awarded. Complete rules will appear in the show catalogue. Entries will be taken by the show secretary on the day, at least one hour before specialty judging commences. For more information, contact specialty coordinator.



## REGIONAL SPECIALTY SHOW SAMOYED CLUB OF ONTARIO

Saturday, November 25, 2017

---

### SAMOYED CLUB OF ONTARIO OFFICERS

*President*  
*Vice-President*  
*Secretary*  
*Treasurer*

Blair Elford  
Judith Wasserfall  
Judi Elford  
Judi Elford

---

### SHOW COMMITTEE

*Show Coordinator*  
Judi Elford | samoyeds@gmail.com  
*Trophy Chair*, Susan Coulson  
*Fundraising*, Donna Hiderman  
*Show Superintendent & Secretary*  
MJN Show Services  
9 Samya Court, Scarborough, ON M1R 2A4  
(416) 759-8593 | www.mjnshowservices.com

---

### JUDGES AND ASSIGNMENTS

**William (Bill) Shelton**  
165A Columbia Avenue, Coventry Cottage, Pomona, CA 91767-3829  
*All Official Classes, Veterans, Altered*

**Liz Patterson**  
5847 Salt Road, R.R. 5, Watford, ON N0M 2S0  
*6-18 Month Sweepstakes*

---

### TROPHY AND AWARDS

Through the generosity of members and friends, the Samoyed Club of Ontario will offer a rosette and a prize for the following awards: Best of Breed, Best of Opposite Sex, Best of Winners, Winners Dog, Winners Bitch, Best Puppy, Veteran Dog, Veteran Bitch, Best Bred By Exhibitor, Best of Breed Altered and Best of Opposite Sex Altered. Rosettes will also be offered for: Reserve Winners Dog, Reserve Winners Bitch, Select Dog, Select Bitch, Award of Merit, Best in Sweepstakes and Best of Opposite Sex in Sweepstakes.

The following cups (which remain the property of the club) will also be presented: The Samovar Cup for BOB, donated by David & Suzanne Rosehart in memory of Myriam Mantle; The Breeders Cup for Best BBE, donated by David & Suzanne Rosehart; and The Deberlack Cup for Best Puppy, donated by Marthe Milas in memory of Andre Desrosiers.

**Award of Merit:** At the judge's discretion, Award of Merit may be awarded up to one award for every 10 dogs competing for Best of Breed, which will be presented following Best of Breed judging.

**Best Bred By Exhibitor:** All eligible dogs not directly or indirectly defeated by another eligible dog can compete for this award. All dogs must be breeder/owner-handled throughout the competition.

---

**SWEEPSTAKES**

**6-18 MONTHS** – The following classes are offered: Junior (6-9 months), Senior (9-12 months), Open (12-18 months) on the day of the specialty. Classes are divided by sex. First Place winners of each class will compete for Best in Sweepstakes and Best of Opposite Sex in Sweepstakes. Dogs entered in Sweepstakes must be entered in one of the Regular Classes at the Specialty.

---

**SWEEPSTAKES  
PRIZE MONEY**

Money received in entry fees shall be divided as follows: 25% of total fees will be retained by the club for administration. Best in Sweepstakes will receive 25% of total entry fee. Best of Opposite Sex in Sweepstakes will receive 20% of total entry fee. First Place winners in each class will divide the remaining 30% of the total entry fee.



## NATIONAL SPECIALTY SHOW SIBERIAN HUSKY CLUB OF CANADA

Saturday, November 25, 2017

---

### SIBERIAN HUSKY CLUB OF CANADA OFFICERS

*President*  
*Vice-President*  
*Secretary*  
*Treasurer*

Michelle Delalieux  
Debra Bowles  
Barb Tauvette  
Joanne Dixon

---

### SHOW COMMITTEE

*Show Coordinator*  
Joanne Dixon

*Show Superintendent & Secretary*  
MJN Show Services  
9 Samya Court, Scarborough, ON M1R 2A4  
(416) 759-8593 | [www.mjnshowservices.com](http://www.mjnshowservices.com)

---

### JUDGES AND ASSIGNMENTS

**Nancy Liebes**  
624 S Homestead Drive, New Castle, IN 47362-8956, USA  
*All Official Classes, Veterans, Altered, Stud Dog, Brood Bitch,  
Brace, Team*

**Ruth Ann Miller**  
98 North Street, Newcastle, ON L1B 1H7

*6-18 Month and Veteran Sweepstakes  
Sled Dog Classes (SD, SDX, SDU) and Best Overall Sled Dog, Working  
Dog Classes (WD, WDX) and Best Overall Working Dog*

---

### TROPHIES AND AWARDS

Through the generosity of members and friends, the Siberian Husky Club of Canada will offer a **rosette and prize** for the following awards: Best of Breed, donated by Native Siberians (Joanne Dixon), Best of Opposite Sex, Best Puppy, Winners Dog, Winners Bitch, Reserve Winners Dog and Reserve Winners Bitch, Veteran Dog, Veteran Bitch, Best Stud Dog, Best Brood Bitch, Brace, Team, Bred By Dog and Bitch donated by Innisfree (the Kanzlers in memory of Norbert Kanzler), Best Bred By Exhibitor (eligible dogs MUST be entered in the BBE class), 1st place in each class, Best of Breed Altered, Best of Opposite Altered, Best Sled Dog and Best Overall Working Dog. A **rosette** will be offered for Best Puppy in Sweeps, Best Veteran in Sweeps, Best of Winners, Award of Merit, Select Dog, Select Bitch and Best Veteran (from the Veteran classes).

**PERPETUAL TROPHIES:** The W.B. Screaton Challenge Cup for Best of Breed, donated by W.B. Screaton. Best Overall Sled Dog, donated by Mrs. M.P. McCoy. Best Bred By Exhibitor (eligible dogs MUST be entered in the Bred By Exhibitor class), donated by Diane Solman and Ms Manon Parent. *All perpetual trophies remain in the possession of the SHCC. A suitable keeper trophy will be awarded.*

**Award of Merit:** At the judge's discretion, Award of Merit may be awarded up to one award for every 10 dogs competing for Best of Breed, which will be presented following Best of Breed judging.

---

## **SWEEPSTAKES**

**6-18 MONTHS** – The following classes will be offered: Junior (6-9 months), Senior (9-12 months), Open (12-18 months) on the day of the specialty. Classes are divided by sex. First Place winners of each class will compete for Best in Sweepstakes and Best of Opposite Sex in Sweepstakes. Dogs entered in Sweepstakes must be entered in one of the Regular Classes at the Specialty.

**VETERAN** – The following classes are offered: 7 to 11 years and 11 years and older on the day of the specialty. Classes are divided by sex. First Place winners of each class will compete for Best in Sweepstakes and Best of Opposite Sex in Sweepstakes. Dogs entered in Sweepstakes must be entered in one of the Official Classes at the Specialty. Spayed and neutered dogs may compete.

---

## **SWEEPSTAKES PRIZE MONEY**

Money received in entry fees shall be divided as follows: 25% of total fees will be retained by the club for administration. Best in Sweepstakes will receive 25% of total entry fee. Best of Opposite Sex in Sweepstakes will receive 20% of total entry fee. First Place winners in each class will divide the remaining 30% of the total entry fee.

---

## **UNOFFICIAL CLASSES**

**SLED DOG CLASS (SD), SLED DOG EXCELLENT CLASS (SDX) & SLED DOG UNLIMITED CLASS (SOU)** – Entry requirements for any of the above three Sled Dog Classes are as indicated below: 1) Requirements as per CKC Certificate Program. Copy of CKC title certificates must accompany all entries. 2) Any dog that does not have a title may be exhibited if proof that said dog has met condition #1 above is submitted with entry (e.g., completed passport). 3) Males and females will compete together in all classes. 4) Winners of each of these 3 classes will compete together for Best Overall Sled Dog. 5) Each entry must be entered in a Regular CKC Official class or for Exhibition Only. 6) Entrants must compete at the “highest eligible level.” 7) Altered dogs/bitches are eligible.

**WORKING DOG (WD) & WORKING DOG EXCELLENT (WDX)** – Entry requirements for any of the above two Working Dog Classes are as indicated below: 1) Copy of title certificates must accompany all entries. 2) Males and females will compete together in all classes. 3) Winners of each of these 2 classes will compete together for Best Overall Working Dog. 4) Each entry must be entered in a Regular CKC Official class or for Exhibition Only. 5) Entrants must compete at the “highest eligible level.”



*We thank Royal Canin for sponsoring  
the Siberian Husky Club of Canada National Specialty.*



## SPECIALTY SHOW SIBERIAN HUSKY CLUB OF ONTARIO

Sunday, November 26, 2017

---

### SIBERIAN HUSKY CLUB OF ONTARIO OFFICERS

*President*  
*Vice-President*  
*Secretary*  
*Treasurer*

Melody Roth  
Kim Ramey-Leblanc  
Linda Philp  
Linda Philp

---

### SHOW COMMITTEE

*Show Coordinator*

Robbyn Gordon | robyn.gordon@sympatico.ca

*Show Superintendent & Secretary*

MJN Show Services

9 Samya Court, Scarborough, ON M1R 2A4

(416) 759-8593 | www.mjnshowservices.com

---

### JUDGES AND ASSIGNMENTS

**Nina Karlsdotter**

Grällsbovägen 16, Se-740 45 Tärnköping, Sweden

***All Official Classes, Veterans, Altered, Stud Dog, Brood Bitch, Brace, Team***

**Robin Hughes**

855038 Gobles Road, Princeton, ON N0J 1V0

***6-18 Month and Veteran Sweepstakes***

***Sled Dog Classes (SD, SDX, SDU) and Best Overall Sled Dog, Working Dog Classes (WD, WDX) and Best Overall Working Dog***

---

### TROPHIES AND AWARDS

Through the generosity of members and friends, the Siberian Husky Club of Ontario will offer a **rosette and prize** for the following awards: Best of Breed, Best of Opposite Sex, Best Puppy, Winners Dog, Winners Bitch, Veteran Dog, Veteran Bitch, Best Stud Dog, Best Brood Bitch, Brace, Team, Best Bred By Exhibitor (eligible dogs MUST be entered in the BBE class), Best of Breed Altered, Best of Opposite Altered, Best Sled Dog and Best Overall Working Dog. A **rosette** will be offered for Best Puppy in Sweeps, Best Veteran in Sweeps, Best of Winners, Reserve Winners Dog, Reserve Winners Bitch, Award of Merit, Select Dog, Select Bitch and Best Veteran (from the Veteran classes).

***Award of Merit:*** At the judge's discretion, Award of Merit may be awarded up to one award for every 10 dogs competing for Best of Breed, which will be presented following Best of Breed judging.

---

### SWEEPSTAKES

**6-18 MONTHS** – The following classes will be offered: Junior (6-9 months), Senior (9-12 months), Open (12-18 months) on the day of the specialty. Classes are divided by sex. First Place winners of each class will compete for Best in Sweepstakes and Best of Opposite Sex in Sweepstakes. Dogs entered in Sweepstakes must be entered in one of the Regular Classes at the Specialty.

---

## **SWEEPSTAKES**

*continued*

**VETERAN** – The following classes are offered: 7 to 11 years and 11 years and older on the day of the specialty. Classes are divided by sex. First Place winners of each class will compete for Best in Sweepstakes and Best of Opposite Sex in Sweepstakes. Dogs entered in Sweepstakes must be entered in one of the Official Classes at the Specialty. Spayed and neutered dogs may compete.

---

## **SWEEPSTAKES PRIZE MONEY**

Money received in entry fees shall be divided as follows: 25% of total fees will be retained by the club for administration. Best in Sweepstakes will receive 25% of total entry fee. Best of Opposite Sex in Sweepstakes will receive 20% of total entry fee. First Place winners in each class will divide the remaining 30% of the total entry fee.

---

## **UNOFFICIAL CLASSES**

**SLED DOG CLASS (SD), SLED DOG EXCELLENT CLASS (SDX) & SLED DOG UNLIMITED CLASS (SOU)** – Entry requirements for any of the above three Sled Dog Classes are as indicated below: 1) Requirements as per CKC Certificate Program. Copy of CKC title certificates must accompany all entries. 2) Any dog that does not have a title may be exhibited if proof that said dog has met condition #1 above is submitted with entry (e.g., completed passport). 3) Males and females will compete together in all classes. 4) Winners of each of these 3 classes will compete together for Best Overall Sled Dog. 5) Each entry must be entered in a Regular CKC Official class or for Exhibition Only. 6) Entrants must compete at the "highest eligible level." 7) Altered dogs/bitches are eligible.

**WORKING DOG (WD) & WORKING DOG EXCELLENT (WDX)** – Entry requirements for any of the above two Working Dog Classes are as indicated below: 1) Copy of title certificates must accompany all entries. 2) Males and females will compete together in all classes. 3) Winners of each of these 2 classes will compete together for Best Overall Working Dog. 4) Each entry must be entered in a Regular CKC Official class or for Exhibition Only. 5) Entrants must compete at the "highest eligible level."



*We thank Royal Canin for sponsoring  
the Siberian Husky Club of Ontario Specialty.*





## REGIONAL SPECIALTY SHOW NORFOLK TERRIER CLUB OF CANADA

Saturday, November 25, 2017

---

### NORFOLK TERRIER CLUB OF CANADA OFFICERS

*President*  
*Vice-President*  
*Secretary*  
*Treasurer*

Christin Borowka  
Sarah Paquette  
Kim Hurd  
Brenda Stahle-Sousa

---

### SHOW COMMITTEE

*Show Coordinator*  
Kim Hurd | puttnpurl@sympatico.ca  
*Trophies*, Barbara Palmer  
*Show Superintendent & Secretary*  
MJN Show Services  
9 Samya Court, Scarborough, ON M1R 2A4  
(416) 759-8593 | www.mjnshowservices.com

---

### JUDGES AND ASSIGNMENTS

**Benny Blid Von Schedvin**  
Strömma 205, SE-310 63 Älvsered, Sweden  
*All Official Classes, Veterans, Altered, Stud Dog, Brood Bitch, Brace*  
**Robin Hughes**  
855038 Gobles Road, Princeton, ON N0J 1V0  
*6-18 Month and Veteran Sweepstakes*

---

### TROPHIES AND AWARDS

Through the generosity of members and friends, the Norfolk Terrier Club of Canada will offer *a rosette and prize* for the following awards: Best of Breed, Best of Opposite Sex, Best of Winners, Winners Dog, Winners Bitch, Best Puppy, Award of Merit, Best Veteran, Best Bred By Exhibitor, Best Junior Handler, Best Canadian Bred, BOB Sexually Altered and BOS Sexually Altered, Best in Sweepstakes and Veteran Sweepstakes; and *a rosette* for Reserve Winners Dog, Reserve Winners Bitch, Select Dog, Select Bitch, Veteran Dog, Veteran Bitch, Stud Dog, Brood Bitch, Brace and Best of Opposite in Sweepstakes and Veteran Sweepstakes.

**Award of Merit:** At the judge's discretion, Award of Merit may be awarded up to one award for every 10 dogs competing for Best of Breed, which will be presented following Best of Breed judging.

**Best Bred By Exhibitor:** All eligible dogs not directly or indirectly defeated by another eligible dog can compete for this award. All dogs must be breeder/owner-handled throughout the competition.

**Best Veteran:** All eligible dogs not directly or indirectly defeated by another eligible dog can compete for this award.

---

## **SWEEPSTAKES**

**6-18 MONTHS** – The following classes will be offered: Junior (6-9 months), Senior (9-12 months), Open (12-18 months) on the day of the specialty. Classes are divided by sex. First Place winners of each class will compete for Best in Sweepstakes and Best of Opposite Sex in Sweepstakes. Dogs entered in Sweepstakes must be entered in one of the Regular Classes at the Specialty.

**VETERAN** – The following classes are offered: 7 to 11 years and 11 years and older on the day of the specialty. Classes are divided by sex. First Place winners of each class will compete for Best in Sweepstakes and Best of Opposite Sex in Sweepstakes. Dogs entered in Sweepstakes must be entered in one of the Ocial Classes at the Specialty. Spayed and neutered dogs may compete.

---

## **SWEEPSTAKES PRIZE MONEY**

Money received in entry fees shall be divided as follows: 25% of total fees will be retained by the club for administration. Best in Sweepstakes will receive 25% of total entry fee. Best of Opposite Sex in Sweepstakes will receive 20% of total entry fee. First Place winners in each class will divide the remaining 30% of the total entry fee.

---

## **JUNIOR HANDLING**

***Judge to be announced.*** Held under CKC rules and class divisions. The Norfolk Terrier handled by the Junior must be entered in the Specialty in an Official class OR for Exhibition Only. The dog used need NOT be owned by the Junior or any member of his/her family. Prizes/ribbons will be awarded. Complete rules will appear in the show catalogue. Entries will be taken by the show secretary on the day, at least one hour before specialty judging commences. For more information, contact specialty coordinator.

# REGIONAL SPECIALTY SHOW LAKESIDE TOY DOG FANCIERS

Sunday, November 26, 2017

---

## LAKESIDE TOY DOG FANCIERS OFFICERS

President	Sandra Lex
Vice-President	Olga Gagne
Secretary	Elaine Whitney
Treasurer	Elaine Whitney
Director	Margaret Brown

---

## SHOW COMMITTEE

**Show Coordinator**  
Sandra Lex | sandralex@rogers.com

**Show Superintendent & Secretary**  
MJN Show Services  
9 Samya Court, Scarborough, ON M1R 2A4  
(416) 759-8593 | www.mjnshowservices.com

---

## JUDGE AND ASSIGNMENT

**Jacqueline Stacy**  
116 Ocoee Falls Dr., Chapel Hill, NC 27517-9531836, USA  
*All Official Classes, Baby Puppy, Veterans, Brace*

---

## TROPHIES AND AWARDS

Through the generosity of members and friends, the Lakeside Toy Dog Fanciers will offer a rosette and prize for the following awards: Group 1st, Group 2nd, Group 3rd, Group 4th, Best Puppy in Specialty, Best Bred By Exhibitor in Specialty (competitors will be picked from the BBE classes for each breed), Best Veteran in Specialty (from the classes), Best Baby Puppy and Best Brace.



*We thank Royal Canin for sponsoring  
the Lakeside Toy Dog Fanciers Specialty.*



NATIONAL SPECIALTY SHOW  
**THE CANADIAN YORKSHIRE TERRIER  
ASSOCIATION INC.**

Saturday, November 25, 2017

---

**THE CANADIAN  
YORKSHIRE  
TERRIER  
ASSOCIATION  
INC. OFFICERS**

*President*  
*Vice-President*  
*Secretary*  
*Treasurer*

Theresa Franz  
Wayne Blackman  
Loreta Serafini  
Lilly DeWitte

---

**SHOW  
COMMITTEE**

*Show Coordinator*  
Loreta Serafini | ozyt@cogeco.ca  
*Conveyors*, Ilona Radionova & Tatyana Kolensikov  
*Perpetual/Keeper Trophy Convener*, Theresa Franz  
*Hospitality*, Eric Franz  
*General Assistant*, Lilly DeWitte  
*Show Superintendent & Secretary*  
MJN Show Services  
9 Samya Court, Scarborough, ON M1R 2A4  
(416) 759-8593 | [www.mjnshowservices.com](http://www.mjnshowservices.com)

---

**JUDGES AND  
ASSIGNMENTS**

**Kim Skiba**  
298 264th Street, Aldergrove, BC V4W sL6  
*All Official Classes, 12-18 Month Class (divided 12-15 Month  
and 15-18 Month), Veterans, Altered, Baby Puppy*

**Betty Anne Durrer**  
113 Thimbleberry Crossing, New Hamburg, ON N3A 4P4  
*3-18 Month Sweepstakes*



*NEW THIS YEAR!*

**ARMBAND DRAW**

Prize amount dependent on total entries in the CYTA National Specialty  
– i.e., 25 entries, draw for \$100; 30 entries, \$150; 35 entries, \$200;  
40 entries, \$300; and 50 and over, \$500

**ENTRY REBATES**

The Canadian Yorkshire Terrier Club is pleased to offer a rebate  
to all exhibitors entering Yorkshire Terriers in our National Specialty  
as follows. For every three entries of a dog owned by one person,  
the Club will provide a rebate of one entry fee (limited to \$30, not including  
listing fees) to the owner. Details can be found at [www.cyta.ca](http://www.cyta.ca)

---

## TROPHIES AND AWARDS

Through the generosity of members and friends, The Canadian Yorkshire Terrier Association will be offering the following: perpetual trophies (which remain the property of the club) for Best in Specialty Show, Best of Opposite Sex, Winners Dog, Winners Bitch, Best Canadian Bred (only Canadian Bred class entries eligible), Best Bred By Exhibitor (only BBE Bred class entries eligible), Best Puppy in Specialty and Best Puppy in Sweepstakes; keeper trophies for Best of Breed, Best of Opposite Sex, Best of Winners, Winners Dog, Reserve Winners Dog, Winners Bitch, Reserve Winners Bitch, Best Puppy, Best Puppy in Sweeps, Best Bred By Exhibitor (from the classes), Best Canadian Bred (from the classes).

Rosettes for all class placements to fourth and Best of Breed, Best of Opposite Sex, Best of Winners, Winners Dog, Winners Bitch, Reserve Winners Dog, Reserve Winners Bitch, Select Dog, Select Bitch, Best Puppy, Award of Merit, Best Veteran (only Veteran class entries eligible), Veteran Dog, Veteran Bitch, Best Bred By Exhibitor (only BBE Bred class entries eligible), Best Canadian Bred (only Canadian Bred class entries eligible), Best of Breed Altered, Best of Opposite Sex Altered and Best Baby Puppy.

**Award of Merit:** At the judge's discretion, Award of Merit may be awarded up to one award for every 10 dogs competing for Best of Breed, which will be presented following Best of Breed judging.

---

## SWEEPSTAKES

**3-18 MONTHS** – The following classes are offered: Baby Puppy (3-6 months), Junior (6-9 months), Senior (9-12 months), Open (12-18 months) on the day of the specialty. Classes are divided by sex. First Place winners of each class will compete for Best in Sweepstakes and Best of Opposite Sex in Sweepstakes. Dogs entered in Sweepstakes must be entered in one of the Regular Classes at the Specialty.

---

## SWEEPSTAKES PRIZE MONEY

Money received in entry fees shall be divided as follows: 25% of total fees will be retained by the club for administration. Best in Sweepstakes will receive 25% of total entry fee. Best of Opposite Sex in Sweepstakes will receive 20% of total entry fee. First Place winners in each class will divide the remaining 30% of the total entry fee.



SPECIALTY SHOW  
**MINIATURE POODLE CLUB OF ONTARIO**

Saturday, November 25, 2017

---

**MINIATURE  
POODLE CLUB  
OF ONTARIO  
OFFICERS**

*President*  
*Vice-President*  
*Secretary*  
*Treasurer*

Joanne Reichertz  
Alysia Reichertz  
Carolyn Savage  
Anne Bell

---

**SHOW  
COMMITTEE**

*Show Chair*  
Michele Kerr | [michele@adanacpoodles.com](mailto:michele@adanacpoodles.com)

*Show Superintendent & Secretary*  
MJN Show Services  
9 Samya Court, Scarborough, ON M1R 2A4  
(416) 759-8593 | [www.mjnshowservices.com](http://www.mjnshowservices.com)

---

**JUDGE AND  
ASSIGNMENT**

Jacqueline Stacy  
116 Ocoee Falls Dr., Chapel Hill, NC 27517-9531836, USA  
*All Official Classes*

---

**TROPHIES  
AND AWARDS**

Through the generosity of members and friends, the Miniature Poodle Club of Ontario will offer *a rosette and trophy* for Best of Breed, Best of Opposite Sex, Winners Dog, Winners Bitch, Best Puppy, and Best Bred By Exhibitor; and *a rosette* for Best of Winners, Reserve Winners Dog, Reserve Winners Bitch, Select Dog and Select Bitch.

*Award of Merit:* At the judge's discretion, Award of Merit may be awarded up to one award for every 10 dogs competing for Best of Breed, which will be presented following Best of Breed judging.

*Best Bred By Exhibitor:* All eligible dogs not directly or indirectly defeated by another eligible dog can compete for this award. All dogs must be breeder/owner-handled throughout the competition.



# NATIONAL SPECIALTY SHOW THE OLD ENGLISH SHEEPDOG AND OWNERS' CLUB OF CANADA

Saturday, November 25, 2017

---

## THE OLD ENGLISH SHEEPDOG AND OWNERS' CLUB OF CANADA OFFICERS

<i>President</i>	Barbara Lynch
<i>Vice-President</i>	Shazia Awan-Hughes
<i>Secretary</i>	Adele MacAskill
<i>Treasurer</i>	Adele MacAskill

---

## SHOW COMMITTEE

*Show Coordinator*  
Adele MacAskill | [adele.macaskill@sympatico.ca](mailto:adele.macaskill@sympatico.ca)

*Show Superintendent & Secretary*  
MJN Show Services  
9 Samya Court, Scarborough, ON M1R 2A4  
(416) 759-8593 | [www.mjnshowservices.com](http://www.mjnshowservices.com)

---

## JUDGES AND ASSIGNMENTS

**William (Bill) Shelton**  
Columbia Avenue, Coventry Cottage, Pomona, CA 91767-3829  
*All Official Classes, 12-18 Month Class (divided 12-15 Month and 15-18 Month), Veterans (divided 7-9 Years and 10+ Years)*

**Barbara Sherman Lam**  
21802 Roosevelt Road, Merrill, MI 48637  
*6-18 Month and Veteran Sweepstakes*

---

## TROPHIES AND AWARDS

Through the generosity of members and friends, The Old English Sheepdog and Owners' Club of Canada will be offering **a prize and rosette** to the following: Best of Breed, Best of Opposite Sex, Best of Winners, Winners Dog, Reserve Winners Dog, Winners Bitch, Reserve Winners Bitch, Best Puppy, Best in Sweepstakes and Best of Opposite in Sweepstakes (puppy and veteran); and **a rosette** for Select Dog, Select Bitch, Awards of Merit, Best Veteran (from the Veteran classes), Best Bred By Exhibitor and all class placements to fourth.

**Award of Merit:** At the judge's discretion, Award of Merit may be awarded up to one award for every 10 dogs competing for Best of Breed, which will be presented following Best of Breed judging.

**Best Bred By Exhibitor:** All eligible dogs not directly or indirectly defeated by another eligible dog can compete for this award. All dogs must be breeder/owner-handled throughout the competition.

---

**SWEEPSTAKES**

**6-18 MONTHS** – The following classes are offered: Junior (6-9 months), Senior (9-12 months), Open (12-18 months) on the day of the specialty. Classes are divided by sex. First Place winners of each class will compete for Best in Sweepstakes and Best of Opposite Sex in Sweepstakes. Dogs entered in Sweepstakes must be entered in one of the Regular Classes at the Specialty.

**VETERAN** – The following classes are offered: 7 to 9 years, 10+ years on the day of the specialty. Classes are divided by sex. First Place winners of each class will compete for Best in Sweepstakes and Best of Opposite Sex in Sweepstakes. Dogs entered in Sweepstakes must be entered in one of the Official Classes at the Specialty. Spayed and neutered dogs may compete.

---

**SWEEPSTAKES  
PRIZE MONEY**

Money received in entry fees shall be divided as follows: 25% of total fees will be retained by the club for administration. Best in Sweepstakes will receive 25% of total entry fee. Best of Opposite Sex in Sweepstakes will receive 20% of total entry fee. First Place winners in each class will divide the remaining 30% of the total entry fee.





**NATIONAL BREEDERS' CLASSIC**  
**Saturday, November 25, 2017**



**ENTRIES CLOSE AT 8 PM (EST) – WEDNESDAY, NOVEMBER 8, 2017**

---

**THE JUDGES**

---

**ASTON, Kim**  
Laureate Shetland Sheepdogs

Since our first Sheltie litter in 1989, Kim Aston along with husband Peter Culumovic, have bred or owned 184 champions, including five National Specialty Best of Breed winners and numerous Best in Specialty and Best in Show winners. We breeder/owner-handled the #1 Conformation Dog in the Herding Group in Canada in 1995. We are proud to have produced three ROM and 15 ROMC titlists.

We are most proud of our accomplishments at the most competitive Sheltie venue in the world, the American Shetland Sheepdog Association (ASSA) National Specialty, where we have won Best of Breed twice, Best of Opposite Sex twice, Select Dog twice, Best in Futurity twice, Runner-up to Best in Futurity, Best of Winners and 11 Awards of Merit.

I have had the privilege of judging several specialty Sweepstakes in Canada and the U.S., including the 2010 ASSA Futurity.



**BRANGERS, Kerri**  
Carnaby English Cockers

I am an English Cocker Spaniel breeder/exhibitor who's love of the breed began in 1968 when a well-bred bitch puppy was purchased as a family companion. Little did I realize that Ch. Brandmoor's Flair "Chelsea" would become the foundation of all the Carnaby dogs, and so would begin my journey with this fabulous breed. We are a small kennel, keeping less than six dogs and breeding a litter every year or two.

Over the years our Carnaby dogs have accomplished some notable wins including Best of Breed at the 2007 English Cocker Club of America National Specialty, six-times Best of Breed at the English Cocker Club of Canada National Specialty, numerous regional specialty wins and over 20 all-breed Bests in Show, always breeder/owner-handled.



Beyond showing our dogs, my involvement with our breed has included various Board positions with both the ECSCA and ECSCC. I am also currently on the approved list of ringside mentors with the ECSCA. My previous experience includes judging the the ECSCA National Sweepstakes in 2000 and 2014 as well as several all-breed and specialty Sweepstakes in Canada.

Away from the dog fancy I am a Senior Production Artist with Staples Canada and also enjoy our two horses, gardening and reading when the dogs allow me the time.

**DESRUISSEAU, Jeannette**  
**Reidwood English Setters**

I have been involved in the sport of dogs since I was born (1987). I went to my first National Specialty at six weeks of age. My family and I breed and exhibit English Setters under the Reidwood prefix. Together we have bred numerous Best in Show, Best in Specialty Show and National winners in multiple countries. We also have had the honour of winning the Royal Canin National Breeders' Classic in 2013 and 2016, as well as Reserve in 2014.



When I was under 18 years old I competed in Junior Handling. I had the great honour of representing Canada twice at Crufts. I still enjoy showing and learning about other breeds. In the future I would like to obtain my judge's licence.

My husband, my son and I share our home with one English Setter, two English Cockers and two cats.

I am looking forward to judging part of the Breeders' Classic this year. Thank you for choosing me as one of the judges.

**PHOTOGRAPHY AND VIDEOTAPING**

Still photography and videotaping or filming will be conducted at the Caledon Kennel Association show. Your entry in, or attendance at, the Caledon Kennel Association show constitutes your permission and consent to the Caledon Kennel Association and its assignees and licensees photographing, videotaping or filming to use the resulting photographic pictures, videotapes or films of yourself, your agents and/or your dogs for any purpose whatsoever and without payment or further release." No photography or videotaping may be conducted for the purpose of resale within the show precincts by anyone other than the official Show Photographer without express written consent from the Caledon Kennel Association.

**PRE-BOOKED GROOMING SPACES – Available September 12, on the Caledon website**  
**[www.caledondogs.com](http://www.caledondogs.com)**

# ROYAL CANIN NATIONAL BREEDERS' CLASSIC RULES

## BREEDER

1. Enters a minimum of 3 dogs to a maximum of 5 dogs – making up each Breeder's Team of the same breed.
2. Breeder must be the "breeder of record" on all dogs entered in the Team.  
(Co-breeders are permissible.)
3. Canadian Kennel Club as well as foreign registered dogs are eligible.
4. Spayed or neutered dogs are eligible.
5. Exhibits must be over 6 months of age.
6. Entry fee is \$30 per Team
7. Exhibits do not have to be entered in the regular Caledon Kennel Association shows.
8. Dogs can only be entered in one Team.

## JUDGING

1. The Royal Canin National Breeders' Classic will start MIDDAY on Saturday, November 25, 2017.
2. Teams will be divided into two units\* (Group A and Group B) by a draw and posted Friday morning. Just prior to the start of judging, the judge for each unit will be drawn.
3. Each unit will be judged by one of the Royal Canin's selected judges.
4. Four Finalists will be selected from each unit to advance to the Finals to compete for Best in Classic and Reserve Best in Classic Awards.
5. Judges will judge the Teams as a unit to evaluate the overall quality of the breeding program as represented by the Team – its consistency of breed type and soundness.

**PLEASE NOTE:** Judging for the Classic will be scheduled so entered Breeders' Teams will not be judged at the All Breed during the Breeders' Classic. Please insure that you have sufficient handlers to show your team. We will also bring the dogs in each unit into the ring in breed size order.

## Prizes – Awarded to the Breeder of Record

**Best in Classic – \$2,500**

**Reserve Best in Classic – \$1,000**

**Finalists (8\* awarded) – \$100**

\*NOTE: If the entry exceeds 60 Teams, the entry will be divided into 3 units, with 4 finalists chosen from each Unit.

**Best in Classic will receive a 16x20 Canvas Portrait of the winning TEAM compliments of Ringside Images.**

**Rosettes – as above – donated by MJN Show Services**



## CGN TESTING

Caledon Kennel Association is offering testing for Canine Good Neighbour Certificates at the show on

**Saturday, November 25 & Sunday, November 26**

10 am to 4 pm

**Cost: \$25 per dog**

Registrations will be accepted at the time of evaluation or at the CKA booth. Don't forget to bring your dog's CKC registered name and registration number.

  
**ROYAL CANIN NATIONAL BREEDERS' CLASSIC**  
**OFFICIAL ENTRY FORM – ENTRY \$30 PER BREEDER'S TEAM**



ENTRY NUMBER
-----------------

Please send entry form and cheque (payable to Caledon Kennel Association) to:  
MJN Show Services, 9 Samya Court, Scarborough, ON M1R 2A4

**ENTRIES CLOSE:**  
**WEDNESDAY, NOVEMBER 8, 2017, 8 PM (EST)**

**BREED/VARIETY** \_\_\_\_\_ **BREEDER OF RECORD** \_\_\_\_\_

1. **NAME** \_\_\_\_\_

SEX \_\_\_\_\_ REG. NO./COUNTRY \_\_\_\_\_ DOB D \_\_\_\_\_ M \_\_\_\_\_ Y \_\_\_\_\_

2. **NAME** \_\_\_\_\_

SEX \_\_\_\_\_ REG. NO./COUNTRY \_\_\_\_\_ DOB D \_\_\_\_\_ M \_\_\_\_\_ Y \_\_\_\_\_

3. **NAME** \_\_\_\_\_

SEX \_\_\_\_\_ REG. NO./COUNTRY \_\_\_\_\_ DOB D \_\_\_\_\_ M \_\_\_\_\_ Y \_\_\_\_\_

4. **NAME** \_\_\_\_\_

SEX \_\_\_\_\_ REG. NO./COUNTRY \_\_\_\_\_ DOB D \_\_\_\_\_ M \_\_\_\_\_ Y \_\_\_\_\_

5. **NAME** \_\_\_\_\_

SEX \_\_\_\_\_ REG. NO./COUNTRY \_\_\_\_\_ DOB D \_\_\_\_\_ M \_\_\_\_\_ Y \_\_\_\_\_

**We encourage exhibitors to include each dog's full name and ALL its titles on this entry form.**

I hereby give permission for Royal Canin and/or their employees or agents to reduce, copy publish, broadcast or otherwise use my name, picture and/or video of me and/or my dog(s), likeness or statements or any material based or derived from them, in congratulatory advertising or promotional advertising for the Royal Canin National Breeders' Classic.

Breeder's Name \_\_\_\_\_ Breeder's Kennel Name \_\_\_\_\_

Breeder's Address \_\_\_\_\_ E-mail \_\_\_\_\_

Breeder's Signature \_\_\_\_\_

**PLEASE NOTE: It is the breeder's responsibility to ensure that they have enough handlers to help show their dogs, keeping in mind that other breeders may ask the same handler.**

---

## HOTELS and RVs

## HOTELS & MOTELS ACCEPTING DOGS

### CROWNE PLAZA TORONTO AIRPORT (Host Hotel)

33 Carlson Court

Toronto, ON M9W 6H5 Canada

Phone: 416-675-1234 | Fax: 416-675-2869

Special Rate until November 2, 2017: \$109 CDN + tax/night,  
based on single or double occupancy

Complimentary parking

15% food discount at La Brasserie Restaurant and Rendezvous  
Bar & Lounge

Free WiFi

\$35 one-time pet-cleaning fee per stay

To book, contact Cassandra at the Crown Plaza Toronto Airport at  
1416-675-4726 or 1-800-268-3300, ext 1325; or email: salesadmin2@  
cptayyz.com. Request the Caledon Kennel Association rate and please  
indicate that you are travelling with your pet.

### MOTEL 6

160 Steelwell Road (410 and Steeles, BRAMPTON)

Tel: 905-451-3313

NO CHARGE FOR DOGS

ASK FOR THE CKC RATE

### RV PARKING

**NEW RULES for RV parking – see next page.**

There will be no hook-ups and no dumping of waste water. Parking is  
free. *However, all RVs need to be registered at [ticcparking.com](http://ticcparking.com).*

---

## MAP



# RV PARKING

## NEW RULES FOR CALEDON DOG SHOW

*Due to municipal bylaws, RVs must be parked out of sight.*

To accommodate this, RVs must be parked between Halls 2 and 5 on **Thursday, November 23, between 3 and 9 p.m.**

Security will be on site during these hours.

***All RVs need to be registered at [ticcparking.com](http://ticcparking.com)***

Access to the show will still be through the exhibitors' entrance at Hall 4 (requiring exhibitors to walk around the outside of Hall 5).

If you have any questions, please contact Patty at [k94milton@gmail.com](mailto:k94milton@gmail.com)

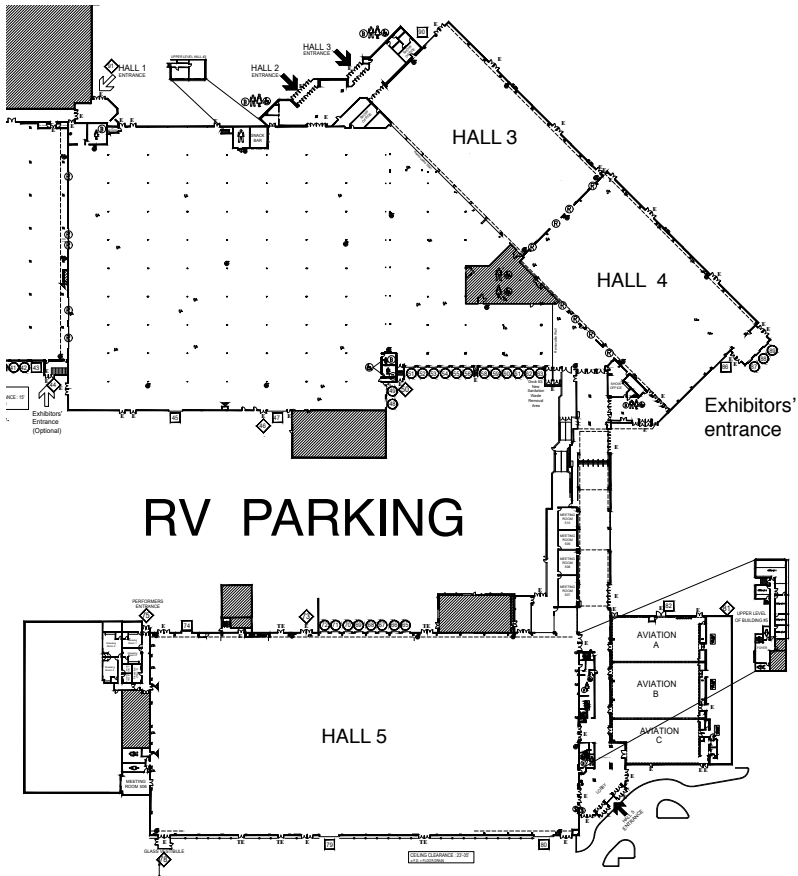

# PRE-PAID RESERVED GROOMING SPACE and POWER

## RESERVED GROOMING SPACE

Enjoy the luxury of pre-booked grooming space (required if electrical necessary). Avoid the day before line-up to set-up at the show. Your space will be there for you when you choose to arrive.

- We have a limited number of spaces that will be able to be booked for electrical drops for prepaid reserved grooming.
- There is a limit of one (1) 10' x 10', one (1) 20' x 10' or one (1) 20' x 20' spot per responsible handler/exhibitor please. Pre-booked grooming-space rates: 20' x 20' – \$80 plus HST; 20' x 10' – \$40 plus HST; and 10' x 10' – \$20 plus HST. **IMPORTANT: Last day for booking grooming is November 21, 2017.**
- Pre-booked spaces must be fully utilized. If there are other exhibitors who do not have space to set up, Caledon Kennel Association may request that you share your space.
- If you wish to bench with a friend, please have one person book all spots.
- Spaces are assigned on a first come-first serve basis and may be altered by the Caledon Kennel Association. No changes will be made once reserved or at the show!

## HOW TO BOOK GROOMING SPACE

- Go to [caledondogs.com](http://caledondogs.com) to order your space. (All reservations must be submitted online or by mail. No telephone reservations will be accepted. Requests sent by mail do not guarantee space until you receive confirmation.)
- Once you have a confirmed, paid-for, reserved grooming area number, contact ShowTech online at <https://e.showtechordering.com/ST-00049864> or by calling 905-283-0550 to book your electrical drop. Exhibitors will need to create a username and password before placing an online order. The electrical drop MUST be booked by the SAME person who booked the grooming space.

## HOW MUCH POWER WILL I NEED

- 1500 watt, 12 amp, 120 volt duplex outlet – \$167 (+HST) – one dryer and one minor electrical tool
- 1800 watt, 15 amp, 120 volt single outlet – \$199 (+HST) – two dryers
- If a breaker is blown by overuse, International Centre maintenance fees will be charged.  
**Special Power Rate above until November 9, 2017.**

## GUIDELINES FOR RESERVED/UNRESERVED GROOMING SPACE

- Grooming areas are offered and designed for the convenience of all exhibitors.
- Any dogs left overnight are the express responsibility of the exhibitor/agent. Contact information must be present and clearly visible. The Caledon Kennel Association assumes no liability in this regard.
- All crates, equipment, chairs, etc., must remain within the limits of designated space.
- Plastic (not provided by the Caledon Kennel Association) must be used under and up the sides of all exercise pens. Please plan accordingly; this will be strictly monitored for compliance.
- Exhibitors are expected to keep their space clean or The International Centre will clean it and bill the exhibitor.
- Fire Lanes/Aisles must be kept clear.
- All dogs must be exercised in the exercise pens provided for that purpose. Exhibitors are liable for all costs related to cleaning or damage caused by a dog(s) under their control. Failure to exercise appropriate diligence may result in a loss of show privileges.
- No commercial activity may occur within any space without the express permission of the Caledon Kennel Association Show Chairs. Exhibitors are welcome to have signage on pens or crates indicating which breed they have on display.
- Signage is not allowed on the walls of The International Centre. If signage is required, please see the Caledon Kennel Association at their booth to obtain the approved signage application material.
- Space is limited. Please keep x-pens to a minimum. X-pens will not be allowed during show hours.
- On Sunday, November 26, 2017, the space must be vacated within 1 hour following Best in Show.
- All Dog Show Rules and Regulations of the CKC and the Caledon Kennel Association will apply to the Reserved Grooming Areas. Exhibitors will be expected to accept space as assigned and keep it clean or this privilege may be withdrawn.

**UNRESERVED SPACES WILL BE AVAILABLE ON A FIRST-COME, FIRST-SERVED BASIS**

**NO POWER AVAILABLE THE DAY OF SETUP • PRE-PAID ONLY**

---

**BOOK YOUR GROOMING SPACE AT CALEDONDOGS.COM starting on September 12, 2017**

---

# CALEDON FLOOR PLAN

Floor plan not to scale

For a more detailed floor plan, visit [caledondogs.com](http://caledondogs.com)

## VENDORS

To book space, contact

**Kim Birch**

(416) 745-1856

[kim.birch@sympatico.ca](mailto:kim.birch@sympatico.ca)

or **Judi Orsi**

(705) 250-4744

[judi.orsi@gmail.com](mailto:judi.orsi@gmail.com)

## GROOMING

Enjoy the luxury of pre-booked grooming space and be assured that your space will be there for you when you choose to arrive. (A pre-booked grooming space is required if you plan to order hydro. Hydro is an additional cost.)

**Bookings begin on  
September 12, 2017**

A reminder will be posted on Ontario and Canadian ShowDogs lists.

For more info, contact

**Patty Milton**

(519) 853-5593

[k94milton@gmail.com](mailto:k94milton@gmail.com)

*Dogs may be left in the building overnight. There will be a Security Guard on site at all times. Contact information must be posted on the outside of your benching area in the event of an emergency.*

HALL 2 FREE UNRESERVED DAY GROOMING

ROYAL  
CANIN

CKA

MJN

PHOTOS

VENDORS

SLOP-SINK

VENDORS

RING 1  
75x37

RING 2  
75x37

RING 3  
35x37

RING 4  
35x37

RING 5  
35x37

RING 6  
35x37

HOLDING AREA (BEHIND SCREEN)  
FOR GROUPS, BIS & CLASSIC

VENDOR BOOTHS

VENDORS

VENDORS

VENDORS

VENDORS

RING 7  
75x37

An additional ring will be added, if required.

**PRE-BOOKED  
GROOMING SPACE**

REQUIRED FOR HYDRO

*All grooming spots are*

**10' x 10'**

**\$20**

EACH + HST

(Visit [caledondogs.com](http://caledondogs.com) for detailed floor plan.)





# YOUR BREED IS OUR SPECIALTY.

At ROYAL CANIN®, we obsess over purebred dogs — and the perfect nutrition for each of them. ROYAL CANIN® formulas are developed with your breed's unique needs in mind for superior muscle tone, coat health and digestion. As a breed expert, you know the right nutrition can unlock the magnificence inside your dogs, and so do we.



**Contact the Royal Canin Breeders' Club:**

Membership, rewards program, puppy starter kits and much more.

1-800-527-2673 • [royalcaninbreedersclub.ning.com/](http://royalcaninbreedersclub.ning.com/)

