

Camping

There is a full hook up campground in Okotoks. Local campgrounds are subject to flooding so early reservations are recommended and be prepared to make alternate arrangements. Call the town offices to obtain information.

On site Portable washrooms will be available. Please park where directed.

Directions

From Calgary – South on the #2 Highway, exit at the Okotoks overpass.
Proceed south through the town of Okotoks to the intersection of #2A and #7 Highways.
(There will be a Sobeys on your left at the intersection.)
Turn right (West) on to #7 highway, continue past the Big Rock.
Next left (South) past Big Rock – 64th Street. Proceed south on 64th Street to 455 Avenue.
Turn left (East) on 455 Avenue and watch for signs.

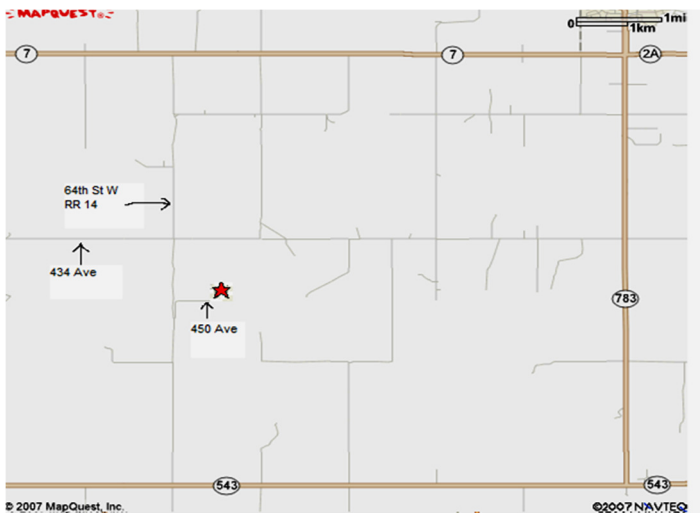
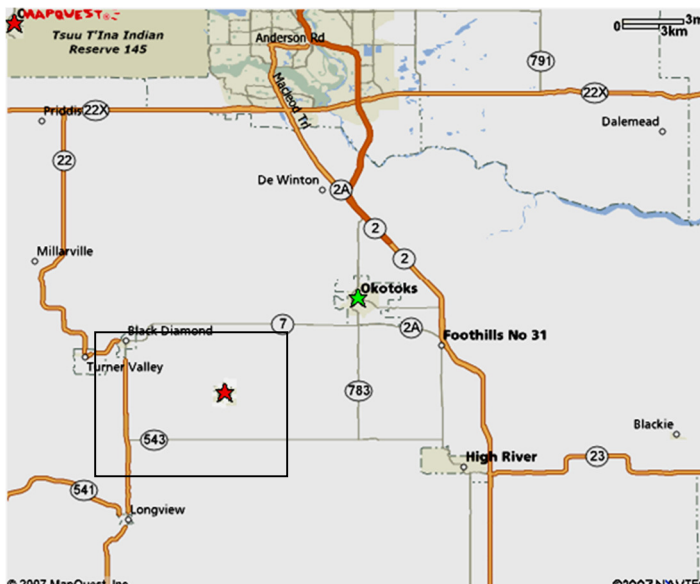

Performance and Earthdog Association of Alberta

Barn Hunt Sanctioned Fun Match

FTLE 15102

May 3, 2015

Smithart Kennels
48120 450 Avenue W
Okotoks, Alberta

Judge: Greg Perry, WA

Permission has been granted by the **Barn Hunt Association, LLC** to hold this barn hunt fun match under BHA rules and regulations.

Open to all breeds and mixed breeds, ages 6 months or older.
Dogs **do not need** to be registered with Barn Hunt Association, LLC to participate at this fun match.

Entries open on March 27, 2015. Pre-entries will be accepted in the order received until the limits are reached or until **April 24, 2015 at 6:00 pm MST.**

These trials are PRE-ENTRY ONLY
Maximum of 10 dog entries per envelope

Classes offered: RATI, RATN

Fun Match Entry Limit: 120 runs

Trial is under cover. There is no indoor crating. **Dogs that bark incessantly must be crated in the handler's vehicle**

Performance and Earthdog Association of Alberta

Officers of the Club

President: Mary Smithdorf
Vice President: Kathy McAra
Secretary: Angela Roper
Treasurer: Christine Duncan
Directors: Megan McGovern

Fun Match Organizers

Chairperson: Megan Crane
225040 Range Road 282
Rocky View County, AB T1X 0E3
Tel: (403) 478-1841
Email: peaabarnhunt@gmail.com

Secretary: Christine Duncan
214 Douglasdale Court SE
Calgary, Alberta T2Z 3B4
Tel: (403) 236-0640
Fax: 1-877-99-Entry (36879)
Email: peasecretary@gmail.com

Trial Committee: Executive of the Performance and Earthdog Association of Alberta

Fun Match Judge

Greg Perry 9775 NE 127th PL
Kirkland, WA 98034-2734 USA

Schedule and Running Order

8:00 a.m. - 8:30 a.m. – Check-in and measuring

8:45 a.m. – Judge's briefing

9:00 a.m. – First dog on the line. (Instinct)

Running order: Dogs will be run in height order, RATI followed by RATN. The running order will be: large, followed by medium, followed by small. Dogs being handled by the same person must be separated into different staged groups.

Move-ups: Move-ups are not allowed at this Fun Match.

Class Descriptions

RATI (Rat Instinct Class): Three PVC tubes placed in plain sight on the course. Tubes will be: one dry, one with litter only (no gerbil), and one with both litter and a gerbil. Time Limit: 1 minute.

RATN (Novice Barn Hunt): Three PVC tubes hidden on the course. Tubes will be: one dry, one with litter only, and one with both litter and a gerbil. Time Limit: 2 minutes.

RATO (Open Barn Hunt): Five PVC tubes hidden on the course. Tubes will be: one dry, two with litter only, and two with both litter and a gerbil. Time Limit: 2 minutes 30 seconds.

RATS (Senior Barn Hunt): Eight PVC tubes hidden on the course. Tubes will be: one dry, three with litter only, and four with both litter and a gerbil. Time Limit: 3 minutes 30 seconds.

RATM (Master Barn Hunt): Ten PVC tubes hidden on the course. One to five tubes will have both litter and a gerbil. All remaining tubes will have litter only. Time Limit: 4 minutes 30 seconds.

Instinct and Novice may be entered at the same fun test. Instinct Test is optional. You do not need to pass Instinct to test in Novice. You may not enter Instinct Test if you have achieved RATN.

Entry Fees

Class	Entry Fee
RATI	\$8
RATN	\$10
RATO, RATS, RATM	These classes are not being offered at this trial

Mail entries may be sent to the Trial Secretary, please provide an email address for confirmation of entry. Online entry is available at www.dogshow.ca. **Online and mail entries close at 6:00 pm MST April 24, 2015.**

Entry fees as listed above must accompany the entry. Make all cheques payable to:

Performance and Earthdog Association of Alberta (PEAA)

Dog Show.ca™ ENTER OUR 10th ANNIVERSARY CONTEST!

ENTER ONLINE AT WWW.DOGSHOW.CA
AND WIN A TRIP* FOR TWO TO
THE 2016 CRUFTS IN BIRMINGHAM, ENGLAND

A service charge of 10% will be assessed. This includes entries sent online, by fax or post using a credit card for payment



* No purchase required. Full contest details available at www.DogShow.ca/Contest

Awards

Awards are not presented at fun matches.

Exhibitor Information

It is expressly understood that participants alone are responsible for the behavior of their dogs. Any participant whose dogs create an unnecessary disturbance or repeatedly engage in unsafe or disruptive behavior may, at the discretion of the event committee, be asked to leave the event site. In such case, no refund of any fees paid will be made. The Performance and Earthdog Association of Alberta ("PEAA") and all persons associated with running this event will assume no responsibilities for any loss damage or injury sustained by participants or spectators, or to any of their dogs or property.

- **Barn Hunt Registration Number and Barn Hunt Rules and Regulations may be obtained on the website, www.barnhunt.com.**
- **Entries made without fees or signature and a completed Waiver and Indemnity Form will not be accepted.**
- If you provide your email address, we will acknowledge receipt of your entry via email within a few days. If you do not receive an initial confirmation within one week of submitting your entry, contact the Trial Secretary. Any errors must be reported prior to the commencement of the trial. If you do not have email but want us to confirm receipt of your entry, please include a SASE with your entry. Please double-check your entry form and remember to sign the Waiver and Indemnity Form. A \$35.00 service charge will be added for any returned cheques.
- Entry fee(s) will not be refunded in the event that a dog is absent, disqualified, excused, or barred from competition by the action of the Trial Committee. Entry fee(s) will not be refunded if the Fun Match cannot open or be completed by reason of riots, civil disturbances, fire, act of God, public emergency, act of a public enemy, or any other causes beyond the control of the organizing committee.
- Withdrawals after the closing date due to injury of the dog will be eligible for a 75% refund of entry fees paid upon receipt of a note from your veterinarian. The note must be dated and emailed or mailed to the Trial Secretary prior to the close of the trial on Sunday afternoon. Priority mail is not necessary. If you have questions, contact the Trial Secretary directly at peasecretary@gmail.com.
- Any dog of any breed or mix, 6 months of age or older, with useable vision may participate in Barn Hunt Sanctioned Fun Match.
- Possessing or training with personal, live quarry is not permitted on show grounds at any time.
- Food and toys are **not** permitted in the ring. Squeaky toys are **not** permitted in the building.

- All dogs must be on a short leash (6') and under control at all times, while on trial grounds, except when in the ring for judging. Approved collars include flat snap or buckle collars of solid construction and leather or nylon leads. Limited slip martingale collars are allowed. Single piece slip collars/leads are allowed. Harnesses, with the exception of head-halter types, are allowed. Dog **must** run "naked," without a collar/harness. *The actual course area will be securely enclosed.* **No flexi-leads or head halters allowed.** Per BHA rules, electronic collars/devices are not allowed anywhere on the site – this includes electronic bark collars. Prong collars may be used on the site while walking dogs, but are not allowed while the dog is competing.
- Bitches in season may compete. They will run at the end of each class. They **must** wear "pants" at all times when not being pottied, **including on the course. Owners of bitches in season should confine their dog(s) away from the trial area and other dogs, post "dog in season" signs in their area, and potty their dogs away from other competitors.** Owners should make their condition known to the Trial Secretary **prior to the start of the fun match** and inform all exhibitors **at the judge's briefing.**
- The judge need not wait for any dog holding up a class because the exhibitor is not ready. It is the exhibitor's responsibility to be ready for their runs. **The club has no obligation or responsibility for calling or locating dogs that are not brought to the ring when required.**
- There will be a short lunch break at the judge's discretion. Hot dogs, chips and beverages will be available for purchase onsite. Fast food restaurants are at least 15 minutes away.
- **BHA rules and common courtesy: Remember that this is private property and we are here at the pleasure of our hosts.** Exhibitors are responsible to clean up after their dogs. Dispose of waste in appropriate containers outside of the building.
- Show courtesy to all competitors. Manage loud or disruptive dogs. Treat every dog as if they were reactive or spatially challenged and remain aware of what your dog is doing at all times. Every dog and exhibitor deserves to have a pleasant experience.
- You **MUST** park where directed by our parking attendant.
- These trials are held under cover in an open sided facility. There will be no crating space. Plan to keep your dog(s) safely confined in the proximity of your vehicle. Bring water, shade and shelter for you and your dogs. Please bring weather appropriate gear as the facility is affected by outside temperature. Wear appropriate footwear as the ground is uneven.
- **Smithart Kennels is a non-smoking facility.** If you must smoke, please do so **inside your vehicle** and dispose of the butts in the vehicle. Anyone found smoking around the facility will be asked to leave the event site. In such case, no refund of any fees paid will be made.

**Performance and Earthdog Association of Alberta
Barn Hunt Participation Agreement**

Smithart Kennels
Site 1 Box 14 RR 1
48120 450 Ave W
Okotoks, AB T1S 1A1

403.540.9186
smithart@outlook.com

Waiver and Indemnity

It shall be known that:

Name _____

(known as participant)

spouse & minor children, if present _____

(also known as participants)

Address _____

Town, Province/State, Postal Code/Zip Code _____

Phone _____ Email _____

Hereby desires to engage in and does engage in any or all of the following canine, or other activities provided at Smithart Kennels, 48120 450 Avenue W, Okotoks, AB, T1S 1A1, owned by Mark N. and Mary C. Smithdorf.

Barn Hunt Trial

As a Volunteer As a Participant As a Spectator



In consideration of the above activities, services and entry fees paid, receipt and sufficiency of which is hereby acknowledged, the Participant hereby does forever and finally release, remise, satisfy, acquit, satisfy and forever discharge Performance and Earthdog Association of Alberta, Smithart Kennels, Mark N. and Mary C. Smithdorf (including employees, teachers, trainers, and agents) of and from all manner of action and actions, cause and causes of action, suit debts, dues, sums of money, bonds, billings, contracts, controversies, agreements, promises, damages, variances, judgments, executions, claims and demands whatsoever, in the law or in equity, which may arise or might in the future arise or herein after may arise for or against Smithart Kennels, the Performance and Earthdog Association of Alberta, or the landowners for the activities as stated above.

Photo and video release. My signature below authorizes the Performance and Earthdog Association of Alberta to use images of me and my family for publication or to promote or document the events we participate in. This document is meant to be a full and complete release from any and all liability that may arise on the properties of Smithart Kennels, Mark N. and Mary C. Smithdorf and employees, jointly and severally. This release is given freely and voluntarily by the participant and is meant to remain in existence throughout the duration of my presence on the property for any period of time in association with the canine event and/or other activities whether I am or am not found to be negligent while handling or near a dog in the above mentioned activities.

Date _____ Signature of participant(s) _____

Legal Guardian (if participant is a minor child) _____

THIS AGREEMENT MUST BE SIGNED FOR YOUR ENTRY(S) TO BE ACCEPTED

OFFICE USE		SANCTIONED BARN HUNT FUN MATCH Performance and Earthdog Association of Alberta May 3, 2015		OFFICE USE
I ENCLOSE ENTRY FEES IN THE AMOUNT OF \$ _____ Includes \$1.50 BHA Recording Fees			Payable to: PEAA 214 Douglasdale Court SE Calgary, AB T2Z 3B4	
PLEASE TYPE OR PRINT CLEARLY				
BREED		Variety:		___ MALE ___ FEMALE
ENTER IN ONE OF THE FOLLOWING CLASSES:				
Trial I RATI _____ RATN _____			Call Name:	
<i>Check appropriate boxes above. Instinct and Novice may be entered at the same trial. For all other classes, only one class/level per trial allowed. Only enter the class for which your dog is eligible.</i>				
FULL NAME OF DOG				
DATE OF BIRTH		HEIGHT CLASS		
____/____/____ Day Month Year		___ SMALL ___ MEDIUM ___ LARGE S = 13" and under, M = 13.1" to 18", L = over 18".		
BHA REGISTRATION NUMBER:		ACTUAL HEIGHT _____ (inches)		
ACTUAL OWNER(S)				
OWNER'S ADDRESS				
CITY		PROV./STATE	POSTAL CODE	
NAME OF OWNER'S AGENT (IF ANY) AT THE SHOW				
AGENT'S ADDRESS				
CITY		PROV./STATE	POSTAL CODE	
ID'S WILL NOT BE MAILED – PLEASE SUPPLY A VALID EMAIL ADDRESS BELOW FOR ENTRY CONFIRMATION				
I (we) acknowledge that if this application for the entry of this dog is made available to me (us) for participation in a Barn Hunt event, that I (we) agree that this facility has the right to refuse the entry of this dog and/or they reserve the right to dismiss the dog and myself for cause which Barn Hunt deems to be sufficient. In consideration of the acceptance of this and the opportunity to train my dog(s), I (we) agree to hold Barn Hunt Association, LLC, Performance and Earthdog Association of Alberta, and all associates harmless from any claim for loss or injury which may be alleged to have been caused directly or indirectly to any person or thing by the act of this dog or dogs while in or upon the premises or grounds or near any entrance thereto, and I (we) personally assume all responsibility and liability for such claim, and I (we) further agree to hold the aforementioned parties harmless from any claim for damage or injury to the dog or myself, either physically or mentally, whether such loss, disappearance, theft, damage or injury, be caused or alleged to be caused by negligence while in or upon the premises of the Barn Hunt grounds. The terms of this agreement bind the parties for the current period of training, and all subsequent classes/training/events in which they hereafter participate.				
SIGNATURE OF OWNER OR AGENT DULY AUTHORIZED TO MAKE THIS ENTRY				
E-MAIL ADDRESS:			TELEPHONE NUMBER	