

ALCA PRESENTS OUR FIRST



ANNUAL TWO-DAY



TURKEY TROT!!!!

SATURDAY OCTOBER 1ST &

SUNDAY OCTOBER 2, 2022

TWO LURE COURSING

FIELD TRIALS AND WE

ARE BRINGING BACK

OUR FAMOUS POTLUCK



TURKEY LUNCH!!



Official Premium List



ALBERTA LURE COURSING ASSOCIATION

Announces

TWO CKC LURE FIELD TRIAL SATURDAY OCTOBER 1 & SUNDAY OCTOBER 2, 2022
(Outdoors)

This event Held Under the Rules of the Canadian Kennel Club

To Be Held At:

Bremner House on the **NORTH FIELD**
53452 Rge Rd 225, Sherwood Park, AB T8A 4V3
Co-Ordinates: Lat 53 deg, 36', 30.0" N, Long -113 deg, 13', 29.0" W



Mail ALL Entries To:

Ivy Molloy
169 – 52061 Rge Rd 215
Sherwood Park, AB T8E 1B2
Email: andare@syban.net

Secure on-line entry service available at
www.dogshow.ca (VISA, Mastercard, American Express & Interac)



Field Trial Pre-Entry Closes: Wednesday September 28, 2022

Post Entry Closes:	Saturday	8:30 a.m.	Official Classes
	Sunday	8:30 a.m.	Official Classes
		10:30 a.m.	Puppy, Veteran, Singles
Roll Call:	Saturday	9.00 a.m.	Official Classes
	Sunday	9.00 a.m.	Official Classes
		11:00 a.m.	Puppy, Veteran

Rolling Inspection from arrival to Roll Call

Lure Coursing Field Trial Stakes

Open Stake – for all eligible hounds one year or older, including Field Champions. When the entry in a regular stake reaches 20 after roll call, the entry will be divided into separate stakes.

Mixed Stake – if there are multiple breeds with entries of three or less, upon agreement of all owners, they will be combined in a **Mixed Stake**

Lure Coursing Field Trial Unofficial Stakes

Best In Field – Offered on Sunday all Best of Breed and Stakes winners from both days are eligible.

Puppy Stake – 6-9, 10-12, 13-18 months – Sunday after completion of Preliminary runs

Veteran Stake – dogs 7 years and older – Sunday after **Puppy Stake**

Singles Stake – Sunday after completion of Preliminary runs

Puppy, Veteran and Single Stake will be run on an abbreviated course with continuous loop.

Judge: Cindy Kremer

Lure Operator: Alex Hagen

ENTRY FEES:

LURE FIELD TRIAL

Pre-entry, first hound (closes Wednesday September 28th) \$22.00 includes CKC recording fees

Pre-entry, each additional hound same owner/co-owner \$20.00 includes CKC recording fees

Post entry (after Sept 28th) \$35.00 includes CKC recording fees

TCN (Temporary Competition Number) Fee per event per dog \$10.50

PUPPY, VETERAN, SINGLES \$ 5.00

POTLUCK SATURDAY Adult \$10.00

Child – 12 & under \$ 5.00

PIZZA SUNDAY All \$ 8.00

COURSING JUDGES:

Valorie Hill	Lucky Lake, SK
Barbara (Bobbi) Westman	Edmonton, AB
Lynda Webster	Edmonton, AB

JUDGING ASSIGNMENTS:

	Saturday Oct 1	Sunday Oct 2
Afghan Hound	VH, BW	VH, BW
Azawakh	VH, BW	VH, BW
Basenji	VH, BW	VH, BW
Borzoi	VH, BW	VH, BW
Deerhound (Scottish)	VH, BW	VH, BW
Greyhound	VH, LW	VH, LW
Ibizan Hound	VH, BW	VH, BW
Irish Wolfhound	VH, BW	VH, BW
Italian Greyhound	VH, LW	VH, LW
Pharaoh Hound	VH, BW	VH, BW
Rhodesian Ridgeback	VH, BW	VH, BW
Saluki	VH, BW	VH, BW
Whippet	VH, BW	VH, BW
Mixed Stakes	VH, BW	VH, BW

ROLL CALL TIMES AND RUNNING ORDER

We are offering a Rolling inspection between the time you arrive and Roll Call.
Official Classes Post Entry closes at 8.30 a.m. Roll Call at 9:00 a.m both days

Sunday only:

Puppy Stake, Veteran Stake and Singles Post Entry closes at 10:30 a.m Roll Call 11:00 a.m.

Breed running order will be posted at Roll Call.
Puppy Stakes, Veterans and Singles will be run after the Preliminary runs.
Best in Field - Open to all Breed and Stake winners from both days.

PRIZES & AWARDS

OPEN: **Best Of Breed, First In Mixed Stake And Best In Field: Rosette & Prize**
Second to Next Best Qualifier: Rosette

Qualifying Score: Ribbon will be offered for each **qualifying score** earned by a hound which has not previously earned the Novice Courser Title. Please let the Field Trial Secretary know if your hound qualifies.

BEST PUPPY: Highest score for a **Puppy in Field:** Rosette & prize

BEST VETERAN: Highest score for a **Veteran in Field:** Rosette and prize

NOVICE: **Highest Weekend Aggregate Score for a Hound competing in its First Trial:** Rosette
Total of qualifying scores for the weekend, adjusted for judges' averages.

2022 AGGREGATE AWARD: ALCA will be offering the ALCA Aggregate Award for the hound entered in all **SIX** lure trials with the highest score adjusted for judges averages. In the event of a tie, a coin toss will determine choice of ribbon or prize. Donated by Miriam & Piet Woestenburg.



A service charge of 10% will be assessed. This includes entries sent online or post using a credit card or Interac for payment.

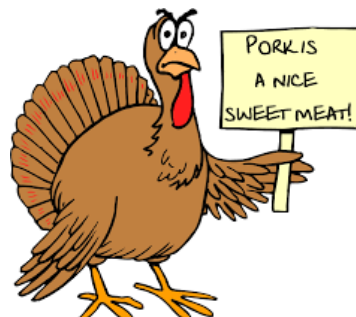

FIELD TRIAL COMMITTEE AND OFFICIALS		ALBERTA LURE COURSING ASSOCIATION 2022 EXECUTIVE	
Field Trial Chair	Ed Molloy	President	Bobbi Westman
Field Trial Committee:	Ivy Molloy Miriam Woestenburg Cindy Kremer Cheri Hunchak	Vice President	Piet Woestenburg
Field Clerk	Nevodka Algu	Secretary	Cindy Kremer
Field Trial Secretary	Ivy Molloy	Treasurer	Ivy Molloy
Lure Operators	Cherie Hunchak Neil Smith		
Hunt Master	Piet Woestenburg Brendan Molloy		
Paddock Master	Cindy Kremer		
COMPLAINTS COMMITTEE: Piet Woestenburg, Ed Molloy, Cherie Hunchak, Cindy Kremer			

ATTENTION:

It shall be the duty and obligation of the trial-giving club to see that a judge, club official, volunteer or any participant at an event held under these rules is not subject to indignities of any kind. The Field Trial Committee Chair shall promptly report to the CKC any infringement of this regulation, and the CKC shall have the authority to take such action as it deems fit on receipt of a report indicating that this has occurred.

CANADIAN KENNEL CLUB OFFICIALS:

THE CANADIAN KENNEL CLUB EXECUTIVE DIRECTOR

Mr. Jeff Cornett, 200 Ronson Drive, Suite 400, Etobicoke, ON, M9W 5Z9 (416) 675-5511

THE CANADIAN KENNEL CLUB DIRECTOR FOR ALBERTA

Lee Ann Bateman, Edmonton AB Email: zone10director@ckc.ca

ALBERTA LURE COURSING REPRESENTATIVE

Ed Molloy Email: andare@syban.net Sherwood Park, AB T8E 1B2

DIRECTIONS TO THE FIELD:

From South: Hwy 21 North to Township Road 534 (First road after Hwy 16 overpass)

Turn right (east) onto Twp Rd 534 and proceed to Range Road 225 (First cross road)

Turn left (north) onto Rge Rd 225. Field is 1 km north on left side of road. Entrance has SVTA in big letters over the gate

From West: Hwy 16 east to Range Road 225 (First road after Hwy 21, approx 2 km)

Turn left (north) on Rge Rd 225

Field is 4 km north of Hwy 16 on left side of road. Entrance has SVTA in big letters over the gate.

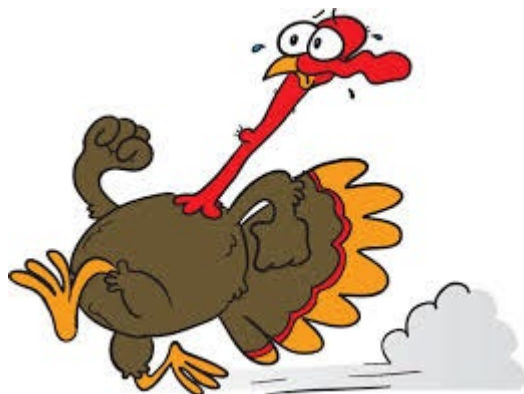

EQUIPMENT AND FIELD CONDITIONS:

The field is a mown hay field, flat on the west side, sloping towards the road.
An electric drag will be used.
A continuous loop will be used for the Puppy, Veteran and Single stakes.

CONDITIONS AND INFORMATION:

- Saturday lunch will be a **TURKEY DINNER POTLUCK!** Sunday lunch will be local artisan Pizza from Nitza's Pizza (meat or vegetarian)
- Rolling inspection – check in for inspection as you arrive, with your dog(s). Inspection ends ½ hour after entries close each day (roll call). It is your responsibility to take your dog for inspection prior to roll call.
- **Lure Coursing is a strenuous athletic pursuit that requires your dog to be in excellent condition. Your dog relies on you to ensure this.**
- All hounds will be run in trios or braces, twice, unless excused, dismissed or disqualified.
- Hounds not present at roll call will be scratched, and their entry fee will NOT be refunded. No exceptions will be made.
- All handlers **MUST** use a slip lead when releasing their hounds.
- Hounds may wear muzzles and/or catch collars at the owner/agent's discretion.
- Bitches in season and lame hounds will be excused and will have their entry fee returned if notice is given to the secretary prior to roll call.
- The Chair may excuse any hound from competition for any reason deemed justifiable.
- A \$10.00 fine, payable to ALCA, will be levied for any hound loose on the field at any time between Roll Call and the completion of Best in Field.
- There is limited shade and no water available, so please come **PREPARED**.
- ALCA, its agents, members, representatives, volunteers, etc. assume no responsibility for any loss, damage or injury sustained by exhibitors, handlers, or to any of their dogs or property and further assume no responsibility for injury to children or spectators.
- All rights to televise, videotape, advertise, photograph, promote or otherwise exploit this event are vested in the club, or in persons to whom assignments of such rights have been made in writing by the club. All persons and animals attending these events grant the club the right to use their likeness and voice in any matter without further consent.

CAMPING: Limited overnight camping on the field. Please contact Ed Molloy to reserve your spot.
780 922-5218.

OFFICIAL VET

PulseVet 780-570-9999 <https://pulseveterinary.ca/>

**ALL RULES GOVERNING THESE EVENTS
ARE AVAILABLE ON LINE FROM THE CANADIAN KENNEL CLUB
[Lure-Coursing-Field-Trial-Rules-and-Regulations.aspx \(ckc.ca\)](https://www.ckc.ca/Lure-Coursing-Field-Trial-Rules-and-Regulations.aspx)**





WELCOME TO THE 10TH ANNUAL TURKEY
TROT LURE COURSING LUNCH!!



ALCA'S FAMOUS POTLUCK IS BACK!!
CLUB PROVIDES THE BIRDS AND GRAVY
POTLUCK FOR SIDES AND DESSERTS!!

BRING YOUR FAVORITE SIDE
OR DESSERT TO SHARE!!

SUNDAY LUNCH IS NITZA'S PIZZA – LOCAL
ARTISAN PIZZA



Not to scale

Antique Tractor Equipment

Saturday

700 meters

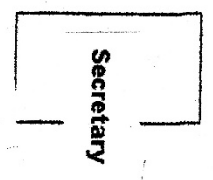
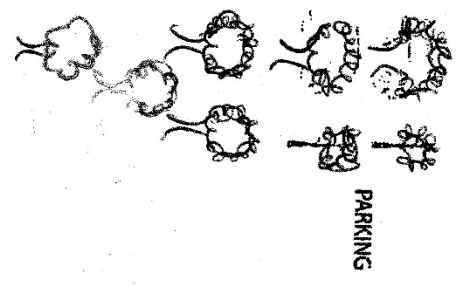
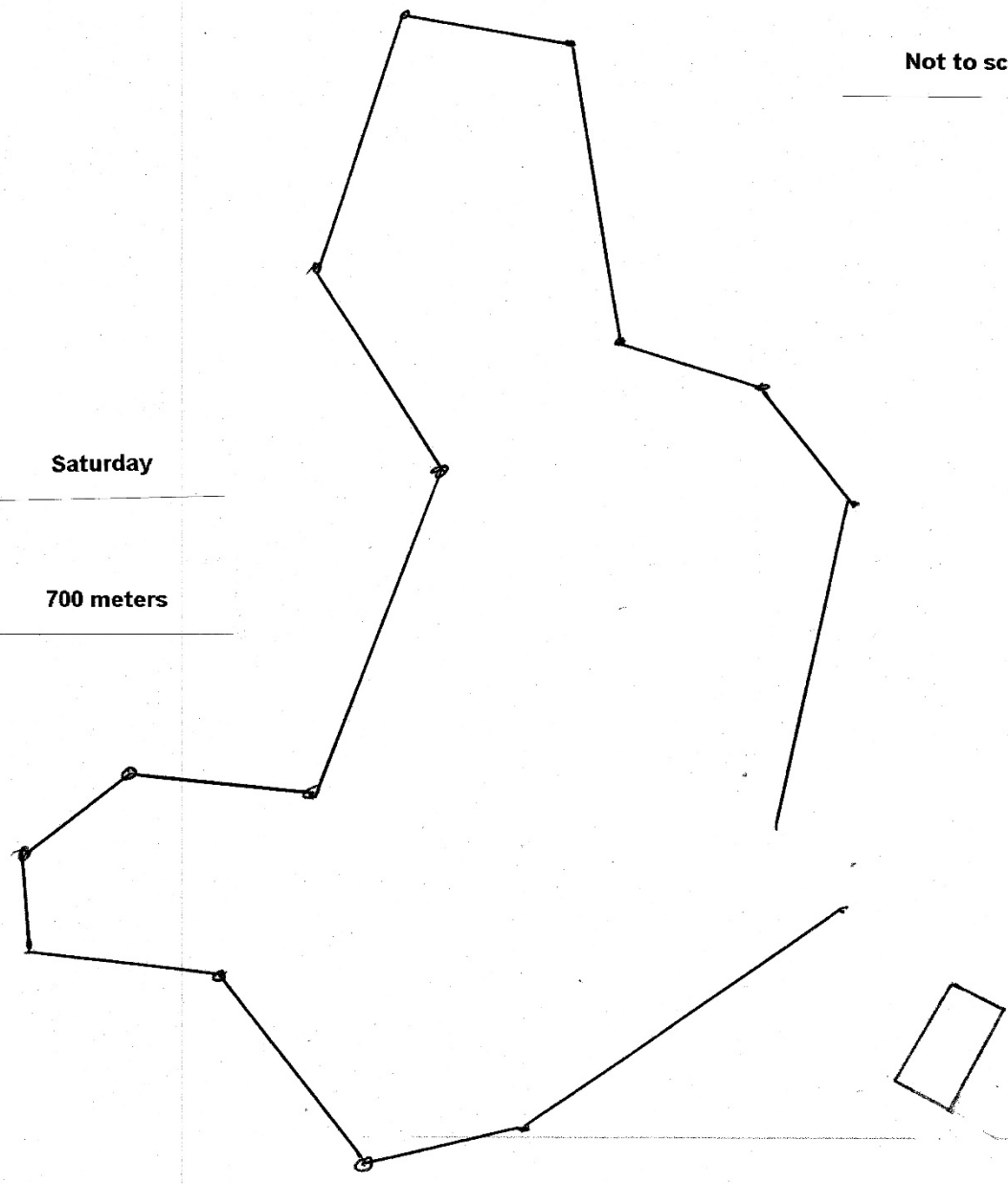

North



Not to scale

Sunday

750 meters

Antique Tractor Equipment

Puppy Veteran Single

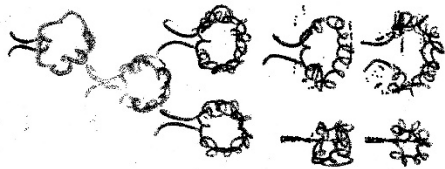
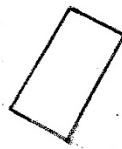

PARKING



Secretary

North





Official Canadian Kennel Club Entry Form
Alberta Lure Coursing Association
 Turkey Trot
 October 1 & October 2, 2022
 Saturday ___ Sunday ___



ENTER IN THE FOLLOWING CLASSES: One entry form per hound

- | | |
|--|------------|
| <input type="checkbox"/> Regular Classes Open | \$ 22.00 = |
| <input type="checkbox"/> Second dog, same household | \$ 20.00 = |
| <input type="checkbox"/> Post entry (after September 28 th) | \$ 35.00 = |
| <input type="checkbox"/> Puppy and Veteran Sunday Only: | \$ 5.00 = |
| <input type="checkbox"/> Single Sunday Only: | \$ 5.00 = |
| <input type="checkbox"/> TCN (Temporary Competition Number) Per event, per dog | \$ 10.50 = |
| <input type="checkbox"/> Saturday: Turkey Potluck | \$ 10.00 = |
| <input type="checkbox"/> Sunday: Local artisan pizza from Nitza's – 2 slices & drink | \$ 8.00 = |

Total \$

Enclose \$ _____ for Entry Fees \$ _____ TCN \$ _____ Other \$ _____

Visa Mastercard American Express

Card No. _____ Expiry _____ / _____

CARDHOLDER NAME (PLEASE PRINT):

Breed: _____ Call Name: _____ Male Female

Registered Name of Hound:

Check one & enter Number here:

Is this dog's first trial? Yes No
 If Yes, bring or attach Hound Certification
 Please separate my hounds

- CKC Reg. No.
 CKC ERN No.
 CKC Misc.Cert.No.
 CKC PEN No
 TCN

Date of birth D _____ M _____ Y _____

Is this a puppy? Yes No

Place of Birth:
 Canada
 Elsewhere

Owner's CKC Membership No.

Breeder(s): _____

Sire: _____

Dam: _____

Reg'd Owner(s): _____

Email: _____

Owner's Address: _____

City: _____

Prov: _____

Postal Code: _____

Name of Owner's Agent (if any) at the Trial _____

Email _____

City _____

Prov _____

Postal Code _____

I CERTIFY that I am the registered owner(s) of the dog or that I am the authorized agent of the owner(s) whose name(s) I have entered above and accept full responsibility for all statements made in this entry. I CERTIFY that one of the owners has the CKC membership number listed above. In consideration of the acceptance of this entry, I (we) agree to be bound by the rules and regulations of the Canadian Kennel Club and by any additional rules and regulations appearing in the premium list.

*******IDs will not be mailed – please supply email address for entry confirmation*******

Signature of Owner or Agent _____ Phone _____



Alberta Lure Coursing Association - Accidental Waiver & Release of Liability Form

In consideration of the acceptance of this Alberta Lure Coursing Association (ALCA) membership and or individual practice/fun(s) runs, the holding of this event(s), official trials, and the opportunity to have the canine(s) run, I agree to hold the organizing committee, the organization which it represents, including its members, officers and directors, volunteers, owners of the premises upon which the event(s) is held and their employees, harmless from any claim for loss or injury which may be alleged to have been caused directly or indirectly to any person or thing by the act of this dog while in or upon the event premises, or grounds, or near any entrance thereto, and I personally assume all responsibility and liability for any such claim.

I further agree to hold the aforementioned parties harmless from any claim for loss of this dog by disappearance, theft, death, or otherwise, and from any claim for damage or injury, to be caused or alleged to be caused by negligence of the parties aforementioned, or by the negligence of any other person, or any other cause or causes.

I hereby assume the sole responsibility for and agree to indemnify the aforementioned parties hold harmless from any and all loss and expenses (including legal fees) by reason of the liability imposed by law upon any of the aforementioned parties for damage because of bodily injuries, including death at any time resulting there from sustained by any person or persons, including myself and my guest or on account of damage to property, arising out of or in consequence of my participation in this event, howsoever such injuries, death or damage to property may be caused or may have alleged to have been caused by negligence of the aforementioned parties or any of their employees or agents, or any other person.

I hereby consent to receive medical treatment, which may be deemed advisable in the event of injury, accident, and/or illness during this activity.

I understand while participating in this activity, I or my canine(s) may be photographed. I agree to allow my photo, video, or film likeness to be used for any legitimate purpose by the activity holders, producers, sponsors, organizers, and assigns.

The Accident Waiver and Release of Liability Form shall be construed broadly to provide a release and waiver to the maximum extent permissible under applicable law.

Name: _____ Phone: _____ Email: _____

I certify that I have read this document and I fully understand its content. I am aware that this is a release of Liability and a contract and I sign it of my own free will.

Signature: _____
Signature of parent/guardian is required for children under 18 years

Date: _____ 2022