

Official OBEDIENCE Premium List

BYTOWN DOG OBEDIENCE CLUB



Saturday, & Sunday

May 7 & 8, 2011

181st, 182nd, 183rd, 184th, 185th, 186th

(6) All Breed Licensed Obedience Trials – Limited Entry

Fred Barrett Arena, 3280 Leirtrim Rd, Ottawa, Ontario K1G 3N2

These Shows held under the rules of The Canadian Kennel Club (CKC)

This event held **Indoors** - Unbenched & Unexamined

Entries Close: TUESDAY, April 19, 2010 AT 9 p.m.

Alterations, substitutions or cancellations of any entry after the closing date is prohibited except for moving class dogs to Specials after the official closing date.

The Bytown Dog Obedience Club & COLMAR Show Service reserves the right to refuse any entries, subject to CKC rules.

Enter Online at: www.colmars.com or with

The Entryline at www.theentryline.com

U.S. POST: All entries must be received at the US Post Office Box by 1:00 p.m. on the day of closing.

Please co-operate in keeping these grounds tidy.

***Check Trophy List inside for your chance to be eligible
to win 1 or more of 28 Trophies and Special Awards***

HIT OF HITS

Saturday May 7, 2011 – 6:30 pm

See details inside

Entries accepted from January 1 to 31, 2011

For further information contact

HIT-Co-Chair Sandra Brewster & Lise Gosselin

BDOC.Hitchair@gmail.com or www.bytowndogobedience.org

BYTOWN
Dog Obedience Club - Ottawa, ON

Club Officers

www.bytowndogobedience.org

(at time of Publication)

President - Frances Roach **Past President** – Angie Chew **Vice-President** - Sandra Brewster
Treasurer - Rolf Calhoun **Secretary** – Joy Clarke
Directors – Donna Johnson, Marilyn Sandiford, Seana Vornholt

Show Committee

(at time of Publication)

Superintendent – COLMAR Show Service
Obedience Trial Chairperson – Dawn O’Leary, doleary@xplornet.com
HIT Co - Chairs – Sandra Brewster, & Lise Gosselin
Chief Ring Steward - Kate Darbyshire **Trophy Chair** – Gillian Hunn
Hospitality Chair - Seana Vornholt **Property Chair** – Adele Forth
Publicity & Advertising – Linda Koenders
On-Call Show Veterinarian – Alta Vista Animal Hospital, 2616 Bank St, Ottawa, ON 613-731-6851

Show Secretary - COLMAR Show Service,
In Canada: 340 Mercer St., Chatham, On. Canada N7M 6E1
In USA: PO Box 142, Marine City, MI. USA 48039-0142
Phone: (519) 351-3147 **email:** colmar@ciaccess.com **Web Site:** www.colmars.com

Canadian Kennel Club

(at time of publishing)

Head Office
Joe Mauro CEO, 400 – 200 Ronson Dr., Etobicoke, ON. M9W 5Z9. (416) 675-5511
Head Office: Joe Mauro, CEO, 400 – 200 Ronson Dr., Etobicoke, ON. M9W 5Z9. (416) 675-5511
Eastern Ontario CKC Director Zone 5 – Bob Rowbotham,
 505 Airport Rd., RR # 4, Stirling, ON K0K 3E0 – bob@rock107.ca
Obedience Rep.....Frances Holmes
 112 Grey Stone Dr., Carp, ON KOA 1L0 frances@thetraininghall.com
Junior Handling Rep.....Kim Groves,
 12 Dallison Lane, Brighton, ON K0K 1H0 avatarbmd@sympatico.ca

OBEDIENCE - Judges & Assignments “Limited Entry”

Bruce Gibbons.....RR# 4, 869 River Road, Kemptville, ON K0G 1J0
James J. Ham39056 Lakeshore Drive, Harrison Township, MI 48045 USA
Donald G. Wallace....88 Chappell Street, Dartmouth, NS B3A 3P8

Class	Trial # 181 Saturday, May 7, 2011	Trial # 182 Saturday, May 7 2011	Trial # 183 Saturday, May 7, 2011	Trial # 184 Sunday May 8, 2011	Trial # 185 Sunday May 8, 2011	Trial # 186 Sunday May 8, 2011
All Classes	Donald Wallace	James Ham + Novice “C”	Bruce Gibbons	Donald Wallace + Novice “C”	James Ham	Bruce Gibbons

Obedience entries limited to 420 minutes per day/per judge – Obedience Trials may close earlier

Brace Class

(Saturday Only)

Judge: Frances Holmes & Judged at Noon approximately

We welcome all exhibitors and spectators, including persons with disabilities. If you require accommodation of a disability, please make your accommodation known to the club in advance. Please contact Show Superintendent by the closing date of this show to ensure that we can do our best to accommodate your needs

Show Entry Information *** All fees include HST ****

Entry Fee, of each dog, per entry per show/day	\$ 29.00 CDN or USD
Listing Fee – per dog, per show/day	\$ 9.40 CDN or USD
Brace.....	\$ 20.00 CDN or USD
Exhibition Only	\$ 12.00 CDN or USD
*Pre-Ordered & Prepaid Catalogue	\$ 3.00 CDN or USD

* (a LIMITED Number of catalogues will be available at the show for \$ 5.00 CDN)

Listing fees are applicable for all dogs entered in the shows

that do not have an individual CKC Registration Number, or an ERN number

Tendering of an NSF Cheque in payment of entry fees shall be considered non-payment of fees (8.8.2)

A service charge of \$25.00 CDN OR USD FUNDS will be applied to all NSF cheques **

ALL Cheques payable to: Bytown Dog Obedience Club

and MAILED TO: COLMAR Show Service, 340 Mercer St., Chatham, ON N7M 6E1

In USA: PO Box 142, Marine City MI. USA 48039-0142

With the uncertainty and unreliability of the postal system it is advised to send your entry - via, priority post, registered mail, or electronically. We cannot be held responsible for mail lost in transit or misdirected by any means

VISA - MasterCard & American Express - Entries

You may charge your Entries to your Visa/MasterCard/AMEX. Include the card number, expiry date, and name on the card, on the entry form, or a separate piece of paper. A NON - REFUNDABLE administration fee of 15% will be charged, plus GST on the Admin Charge. All Credit Card Charges Will Be Made in Canadian Funds.

ANY REFUNDS WILL BE MADE IN CANADIAN FUNDS FROM THE SHOW GIVING CLUB.

Fax Entries

You may also fax your entry directly to us at 519-351-3223 for a NON - REFUNDABLE fee of: 15% in advance of the closing date, plus GST on the Administration Charge.

ATTENTION FOREIGN EXHIBITORS

Please note that fees are due and payable in Canadian Dollars. Due to the constantly fluctuating currency rates, discounted cheques will not be accepted. Personal cheques will be accepted, however, they are to be payable in Canadian Funds. If you send a cheque in US Funds, it must be made out for the full amount of the entry and no exchange will be refunded to the exhibitor. Please do not mark cheques "Payable in Canadian Funds" or "At Par". They will not be cleared by the banks. To simplify the process, we urge that you purchase bank drafts or money orders payable in Canadian Funds. Your understanding and cooperation is appreciated. Thank You.

NON CKC MEMBER PARTICIPATION FEE - CANADIAN RESIDENTS ONLY

Effective Jan1, 2011 the CKC will be instituting a Non-Member Participation fee for all Canadian residents who participate in a CKC event but are not CKC members. In order to protect the awards/titles earned, the non-member will have a choice either to become a CKC member or to pay the non-member participation fee. Failure to comply within 30 days of notification will cause all awards and titles to be cancelled This applies to dogs wholly owned by non members resident in Canada and does not apply to U.S. exhibitors nor to CKC members or dogs co-owned with a CKC member

EVENT REGISTRATION NUMBER (ERN)

Effective Jan 1/92, all dogs that are foreign born and foreign owned and enter Canada for the sole purpose of entering CKC events, will no longer require a CKC registration number but will require an Event Registration Number (ERN). The ERN number MUST be applied for within 30 days of the first day of entering a CKC event. For further information, The Canadian Kennel Club, Phone (416) 675-5511 FAX (416) 675-6506 9:00 a.m. – 5:00 p.m.

MOVING UP – OBEDIENCE

CKC RULES AND REGULATIONS (EFFECTIVE JANUARY 01, 2008)

6.8.1 A dog that is registered in the records of the CKC or has a PEN, and ERN, or a MCN and has fulfilled the requirements for a title in accordance with these rules but at the time of the closing of entries for the trial has not received confirmation of the title may be moved to the next level of competition providing the request is submitted to the trial secretary on the appropriate move-up form by the owner or handler a minimum of one hour before the opening of the first trial on that day, schedule permitting.

6.8.2 When one or more trials are held on the same day in the same venue, the request for moving the dog up must be made a minimum of one hour prior to the scheduled start of the trial for which the dog is being moved up to, schedule permitting. The Trial Secretary shall amend the judge's book and the marked catalogue, which is to be sent to the CKC with the requests attached to the appropriate entry forms.

CLASSES – OBEDIENCE

Official CKC Classes Offered: Pre Novice, Novice "A", Novice "B", Novice "C" (Nov "C" only in Trial 182 & 184), Open "A", Open "B", & Utility.

Pre-Novice (Transition Class) - The Pre-Novice class shall be for dogs of any recognized or listed breed & of either sex which have not earned the title of P.C.D. (Pre-Companion Dog) in Canada

Novice "C" (Transition Class) - The Novice "C" class is open to any dog of either sex that has gained the title CD, CDX, UD or any other advanced Obedience title in Canada prior to the closing date of the trial in which it is to be entered. Exhibitors may enter more than one dog in this class but must have a separate handler for each dog in the Long Sit & The Long Down Exercises when they are judged in the same group. The Novice "C" exercises will be performed & judged as described in the official Novice Class except that exhibitors may compete in the Novice "C" Class indefinitely.

PERFORMANCE EVENT NUMBER (PEN)

Effective Jan 01, 2002, a Performance Event Number (PEN), allows an unregistrable dog of a CKC recognized breed to participate in those competitive events that are appropriate for the breed.. This restriction shall also apply to dogs with ILP numbers. Unregistrable Dog means, a dog of a recognized CKC breed that cannot be registered because of unknown parentage or the unavailability of its registration papers

ADVERTISE IN OUR CATALOGUE

RATES: Full Page - \$15.00 Half Page - \$10.00 Business Card - \$5.00

Deadline for submission is April 16, 2011

Make cheques payable to "BDOC"

Attention: Colmar Show Service, 340 mercer St., Chatham, ON N7M 6E1

BOOTH RENTALS

Booth Rental Rates\$ 40.00

Booth Space is available on a first come, first booked basis

Contact: Linda Koenders - linda.koenders@cra-arc.gc.ca

Important Note regarding EMAILS & FAXES

It will be the responsibility of the exhibitor to ensure that any electronic submission, either, email, facsimile, or any document transmitted electronically, reaches the proper authority or recipient, within the times and limits as regulated for each document in the CKC Rules & regulations. Sent fax receipts, and or, copies of sent emails, will not be taken as evidence of receipt by recipients.

General Entry Information

- ◆ **Please forward all inquires regarding entries to COLMAR SHOW SERVICE**
- ◆ All entry confirmations and **Judging Schedules** will be mailed as soon as possible after entries close.
- ◆ It is your responsibility to verify the receipt of any electronic entries prior to the advertised closing date. A valid means of payment must accompany all entries.
- ◆ Exhibitors must abide by errors made in entering their dogs regardless of how or by whom the entries were made.
- ◆ Only dogs eligible for registration with CKC may enter this show and trial.
- ◆ **Bitches, when in season**, are not permitted to compete in the Trial, however, entry fees will be refunded, providing a veterinarian's certificate stating that the bitch was in season within the 10 day period preceding the trial, is submitted to the Trial Secretary, on or before the date of the trial.
- ◆ The **Show precincts** will be the entire Building housing the show. No un-entered dogs will be allowed within the precincts of the show or trial.
- ◆ The **Bytown Dog Obedience Club** will not be responsible for any Items left overnight.
- ◆ The Show Superintendent will be in full charge of the show, governed by CKC rules. If, because of riot, civil disturbance or other acts beyond the controls of the management, it is impossible to open or complete the show or trial, no refund of Entry Fees will be made.
- ◆ The **Bytown Dog Obedience Club** will use care and diligence for the welfare of all dogs, exhibitors and spectators but will not be responsible for, nor assume any liability in the event of accident or misfortunes, however caused.



"Entryline" Dog Show Entry Service
" The Dog Show Entry Service that lets you focus on winning"
PHONE: 1-800-293-2935 FAX: 1-519-754-0796
INTERNET: www.theentryline.com (a Secured Site)
Important: Entries taken until: 6:00 pm on day of closing
This is a privately owned business and charges a fee for this service

Club Contact

www.bytowndogobedience.org OR 613-822-4400
2684 Fenton Rd., Gloucester, ON K1T 3T7

AWARDS ELIGIBILITY FORM

This form must be completed and returned with entry form to be eligible.
Read Award description in the Awards List

Name of Dog: _____

Name of Owner: _____

Check the box next to the award that you or your dog are eligible for.

- The Eve Coltas Memorial Trophy
- The OTCH Petitcote Mitzi
& CH/OTCH Grizebeck Terrie Of Ebonyhue Am Can TOX Trophy
- BDOC Utility Trophy
- BDOC Challenge Trophy Trial 181, 182, or 183
- Gertrude Baker Perpetual Trophy Trial 184, 185 or 186
- Bytown 50th Anniversary Trophy
- Bytown Member's Trophy Trial 181, 182 or 183
- Bytown Member High Combined (Open/Utility) Trial 184, 185 or 186
- All Breed Aggregate Any 4 Trials/in any one class
- McEvoy Perpetual Trophy Trial 181, 182, or 183
- Performance Event Number Award All Trials
- Paws 4 Thought Award Trial 181, 182, or 183
- Paws 4 Thought Award Trial 184, 185 or 186

Signature: _____

TROPHY LIST

All New Titles will receive a New Title Rosette

All winners, 1st, place, in each class (Novice A & B, Open A & B, & Utility) in each trial will receive the following prize.

All 1st place winners – Prize

1st place in Brace will receive \$ 100.00

AWARDS

HIGHEST QUALIFYING SCORE PER TRIAL

\$100 per trial will be offered courtesy of the following:

Trial # 181 Canadian Guide Dogs for the Blind (Courtesy of Jane Thornton)

Trial # 182 The Laker Memorial Trophy (Courtesy of Helen McGill, BDOC Member)

Trial # 183 Sponsored by Barbara Jeffrey, BDOC Member in memory of "D'Yquem" & "Talbot"

Trial # 184 Sponsored by Bytown Dog Obedience Club

Trial # 185 Sponsored by Bytown Dog Obedience Club

Trial # 186 Sponsored by Bytown Dog Obedience Club

HIGHEST QUALIFYING SCORES PER CLASS

The Bytown Dog Obedience Club offers a suitable rosette or ribbon for

First, Second & third place in each class in each trial

Bytown Dog Obedience Club MEMBERS AWARDS

Dog must be owned by a BDOC member who is currently training with BDOC at the level in which she/he is competing. Competitors must declare their eligibility for any of the following awards/trophies by completing the awards eligibility form & sending it to the Trial Secretary along with the entry form. The club will retain possession of the trophy with proper inscription. A toy will be provided to the winner

The Eve Coltas Memorial Trophy - Donated by Ken Coltas

Highest combined qualifying score of 4 trials, in any class, for a dog owned and trained by a BDOC member who has completed the BDOC training course leading to the degree for which she/he is competing.

The OTCH Petitcote Mitzi and CH/OTCH Grizebeck Terrie of Ebonyhue Am.Can.TDX Trophy

Donated by the late Eve Coltas

Highest qualifying score by a BDOC member (50 years of age or older) who obtains a title at these trials by earning three qualifying scores and is presently attending classes at the level in which he/she is competing.

BDOC Utility Trophy donated by Canadian Guide Dogs for the Blind (courtesy of Jane Thornton)

Highest qualifying score by a dog in Utility Class in any trial, trained by a BDOC member who has completed the BDOC Utility training course with the competing dog.

BDOC Challenge Trophy

Highest combined qualifying score of 2 Trials on Saturday in any class for a dog owned and trained by a BDOC member who has completed the BDOC training course leading to the degree for which she/he is competing

Gertrude Baker Perpetual Trophy

Highest combined qualifying score of 2 Trials on Sunday in any class for a dog owned and trained by a BDOC member who has completed the BDOC training course leading to the degree for which she/he is competing

AWARDS LIST - Awards are for official classes unless otherwise specified

Competitors must declare their eligibility for any of the following awards/trophies by completing the awards eligibility form & sending it to the Trial Secretary along with the entry form.

BYTOWN 50TH ANNIVERSARY TROPHY

Open to all BDOC Members as of November 1, of the previous year. To be Awarded to the Highest Aggregate with a minimum of four qualifying scores in any one class from any four of the six trials.

BYTOWN MEMBER'S TROPHY

DONATED BY- Cam Gravelle

Highest qualifying Score by a BDOC Member in each trial on Saturday - \$25.00 cash award

Bytown Member HIGH COMBINED (OPEN/UTILITY):

DONATED BY Roger Despard

Highest combined qualifying score by a BDOC member in each trial on Sunday \$25.00 cash award

Continued on next page.....

(Continued from Previous Page....) - Bytown Dog Obedience Club MEMBERS AWARDS

ALL BREED AGGREGATE

DONATED BY Barbara Jeffrey

Highest combined qualifying score of any FOUR trials in any official class. To be eligible, team must have qualified in all FOUR trials

McEVOY PERPETUAL TROPHY

Honouring Clint & Vera McEvoy'

Best two combined qualifying Open scores on Saturday

PERFORMANCE EVENT NUMBER AWARD:

DONATED BY Cyndi Morin

Highest qualifying score of a team with a PEN in any class on Saturday & Sunday

PAWS 4 THOUGHT AWARD

DONATED BY Frances Holmes

Highest qualifying score by a Paws 4 Thought student in any class on Saturday

PAWS 4 THOUGHT AWARD

DONATED BY Frances Holmes

Highest qualifying score by a Paws 4 Thought student in any class on Sunday who did not win this award on Saturday

Competitors do not have to declare their eligibility for any of the following Awards

PRE-NOVICE AWARD – in Memory of “Misha”

DONATED BY Angie Chew

A prize will be awarded to each qualifying entry

THE HELEN MCGILL VOLUNTEER TROPHY –

Team with the Highest qualifying scoring in Novice C (Sat - Trial# 182)

BREED / GROUP / OTHER AWARDS

<u>AWARDS</u>	<u>SPONSOR</u>
Group 3 (Working) Highest qualifying score each trial	Kate Darbyshire
Airedale - (In Memory of Oliver CD & Cedrik CD) Highest qualifying score in any class any trial	Jana Zikmund
Bouvier des Flandres Highest qualifying score in any class in any trial	Frances/George Roach
Dachshund Highest qualifying score any class any trial	Eleanor Ede
German Shepherd Highest qualifying score in any Novice A class, in any trial, on Saturday (Memory of Brawny & Trio)	Gerry Pearce & Helen Wallace
Golden Retriever Highest combined qualifying score of all six trials in any class	Clint & Vera McEvoy
Great Dane Highest qualifying score in any class in each trial	Ann/Dwight Nesbitt
Nova Scotia Duck Tolling Retriever In Memory of Becka, Rideau's Beck And Call CDX, CGN Highest qualifying score in any class, any trial Saturday & Highest score in any class, any trial Sunday	Dawn O'Leary
Poodle Highest qualifying score in any class any trial Saturday \$ 25.00	Margaret Powell Dubois
Poodle- Miniature or Standard-(Prance's Presents) Highest qualifying score in Novice A trial 181 \$25.00 - Highest score in Novice B trial 182 \$25.00 Highest qualifying score in Open A trial 183 \$25.00	Gib Jamieson
Miniature Schnauzer Highest qualifying score in any class on Saturday	Cam & Shirley Gobeil-Gravelle
SHETLAND SHEEPDOG Highest combined qualifying score in any two classes on Saturday \$50.00 Highest combined qualifying score in any two classes on Sunday \$50.00	Gwen & Larry Paget
SOFT-COATED WHEATEN TERRIER In Memory of Timtara's Bailey Cub, CD Highest qualifying score in any class, any Trial on Saturday \$25.00 Highest qualifying score in any class, any Trial on Sunday \$25.00	Peggy Warren
UTILITY CLASS AWARD Lowest qualifying score in the utility class in each trial, provided it is not the only qualifying score in that class	ANONYMOUS DONOR

The Bytown Dog Obedience Club
Invites You to Attend
the 17th Anniversary Presentation of the
HIT-of-HITS



Saturday May 7, 2011 at 6:30 p.m.
Fred Barrett Arena

Participants in the event have excelled in the CKC obedience ring in 2010 obtaining HITS with a score of 195 or greater in Novice and Open and 193 or better in Utility.

Spectators can expect a nail-biting evening as they watch the teams compete under the watchful eyes of three Obedience judges for the honour of winning the title of

HIGH IN TRIAL of HIGHS IN TRIAL

The teams are sharp, the routines tricky, the atmosphere is tense, making the Hit of Hits the flagship event of obedience competition in Canada

**PLAN TO ATTEND THE SEVENTEENTH ANNIVERSARY
OF THE EVENT**

Admission at the door (includes catalogue) - \$6.00

Further Information

HIT-Co-Chair Sandra Brewster & Lise Gosselin
BDOC.Hitchair@gmail.com

or view the BDOC webpage – www.bytowndogobedience.org



Bytown Dog Obedience Club
would like to invite you to become a
“Friend of the HIT”



The HIT of HITS is a major undertaking for Bytown and each year we struggle to keep this event in the black. In order for you to show your support for the HIT and your hope that the event continue in the future, we have created a ‘Friend of the HIT’ sponsorship category.

For the sum of \$25.00 you get mention on our web page and in our HIT catalogue, acknowledgement by the emcee at the HIT, plus two admission tickets to the HIT of HITS on Saturday, May 7, 2011.

But most important of all, your ‘Friend’ donation is a cheer of
‘WELL DONE, KEEP IT UP’
to the club & volunteers who organize this very special evening !

**To become a ‘FRIEND’
a cheque made out to BDOC
should be sent by May 1, 2011 to:**

**Sandra Brewster
35 Sai Cres.
Ottawa, ON
K1G 5N7**

OBDIENCE - OFFICIAL CANADIAN KENNEL CLUB FORM				Armband #
BYTOWN Dog Obedience Club – Limited Entry				
SATURDAY MAY 7, 2011		SUNDAY MAY 8, 2011		
<input type="checkbox"/> Trial # 181 <input type="checkbox"/> Trial # 182 <input type="checkbox"/> Trial # 183		<input type="checkbox"/> Trial # 184 <input type="checkbox"/> Trial # 185 <input type="checkbox"/> Trial # 186		Entry Fee: \$ 29.00 CDN/USD, Listing Fee: \$ 9.40 CDN/USD Other Fees: Exhibition \$ 12.00 & Brace \$20.00
<input type="checkbox"/> Pre Paid and Pre Ordered Catalogue \$ \$ 3.00 CDN OR USD				
Please Make <u>ALL Cheques Payable</u> to Bytown Dog Obedience Club			Entries Close: Tuesday April 19, 2011	
Please Print or Type CLEARLY		TOTAL FEES FOR THIS ENTRY: \$ <input type="checkbox"/> CDN <input type="checkbox"/> USD		
OBDIENCE			Jump Heights	
<input type="checkbox"/> Pre Novice <input type="checkbox"/> Novice B <input type="checkbox"/> Open A <input type="checkbox"/> Open B <input type="checkbox"/> Novice A <input type="checkbox"/> Novice C (offered in Trial 182 & 184 only) <input type="checkbox"/> Exhibition Only			<input type="checkbox"/> Utility <input type="checkbox"/> Brace (Sat Only) Height Width	
BREED			SEX: <input type="checkbox"/> MALE OR <input type="checkbox"/> FEMALE	
REGISTERED				
NAME OF DOG				
Check One & Enter Number Here		Date Of Birth: Please Circle Month		IS THIS A PUPPY?
<input type="checkbox"/> CKC Reg #		Jan Feb Mar Apr May June		<input type="checkbox"/> Yes <input type="checkbox"/> No
<input type="checkbox"/> CKC PEN #		July Aug Sept Oct Nov Dec		PLACE OF BIRTH?
<input type="checkbox"/> CKC ERN #		Day _____ Year _____		<input type="checkbox"/> Canada
<input type="checkbox"/> CKC Misc Cert.#				<input type="checkbox"/> Elsewhere
<input type="checkbox"/> LISTED				
BREEDER(S)				
SIRE				
DAM				
REGISTERED OWNER(S)				
OWNER'S ADDRESS				
CITY	PROV/STATE	POSTAL CODE/ZIP		
NAME OF OWNERS AGENT (IF ANY) AT THE SHOW				
AGENT'S ADDRESS				
CITY	PROV/STATE	POSTAL CODE/ZIP		
Mail ID to: <input type="checkbox"/> OWNER Or <input type="checkbox"/> AGENT				
<small>I certify that I am the registered Owner(s) of the dog or that I am the authorized agent of the Owner(s) whose name(s) I have entered above and accept full responsibility for all statements made in this entry. In Consideration of the acceptance of this entry, I (we) agree to be bound by the rules and regulations of the Canadian Kennel Club and any additional rules and regulations appearing in the premium list. Also, by signing this form I certify that I will not hold the Show giving Club, it's members, Directors, Employees, or Agents, liable in the event of any accident or misfortune however caused.</small>				
				Phone Number
Signature of Agent or Owner _____				
a 15% + HST, charge applies on all Credit Card Charges			Email address	
<input type="checkbox"/> VISA <input type="checkbox"/> MasterCard <input type="checkbox"/> AMEX		Expiry Date: Month > _____ Year > _____		
Card Number: _____ -- _____ -- _____ -- _____				
Name of Card Holder: _____				
Fax # 519-351-3223	Mail To: COLMAR Show Service,		In Canada: 340 Mercer St, Chatham, ON, Canada N7M 6E1	
	Web Site: www.colmars.com		In USA: PO Box 142, Marine City, MI, USA 48039-0142	

COLMAR Show Service will only collect and utilize data and information that you provide us, and only for the purposes of the service we provide, exhibitors entering a CKC (Canadian Kennel Club) event, and the subsequent documents generated for this event, and required by the CKC. The type and accuracy of the information is solely contingent upon what you voluntarily provide us with. We will not use or disclose personal information for the purposes other than those for which it was collected, except with consent or as required by law. Personal information will not be retained longer than needed for the specified purposes.

Enter online at www.colmars.com

 **MUDDYPAWZ** 
PHOTOGRAPHY



Award Photos
Dog Sports
Candid
Portraits



Book a portrait session during the BDOC Trials

Appointments available between

9 am and 5 pm on Saturday

9 am and 4 pm on Sunday

WENDY BEARD – Tel: 613 – 266- 6432

Email wendy@muddypawz.net

www.muddypawz.net



All dogs need canine massage

**No bones about it
canine massage works!**

For more information contact

Sandy Benoit

Certified

Canine Masseuses

PHONE: (613) 762-8869

www.caninetouchandtell.com

caninetouchandtell@rogers.com

**Canine
Touch & Tell**

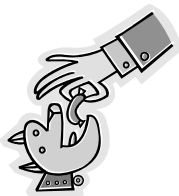

Bytown Dog Obedience Club

FUN MATCH



Friday - May 6, 2011

LIMITED ENTRY

Pre-Register - \$12.00

At the Door - \$14.00 (space permitting)

Classes – Pre-Novice, Novice, Open, Utility

NOTE: ONE ENTRY PER DOG PER CLASS

No ribbons, score sheets on request & ONLY if handler is using CKC ring procedures

Start Time – 6:30 p.m. - Three Rings

Place – Trial Site Fred Barrett Arena 3280 Leitrim Rd, Ottawa

Send Entries to: Betty Ann Despard

24 rue des Mangliers, Gatineau, QC J8Y 6J7

Phone: 819-778-3057 E-mail: bdespard@videotron.ca

Make cheques payable to “BDOC” **NO REFUNDS**

ENTRY LIMITED TO 2.5 HOURS JUDGING PER RING

NOTE: ONE ENTRY PER DOG PER CLASS

REGISTERED NAME OF DOG			
Breed			
<u>O</u> BEDIENCE			Jump Heights
<input type="checkbox"/> Pre Novice	<input type="checkbox"/> Novice	<input type="checkbox"/> Open	<input type="checkbox"/> Utility
		Height	Width
Amount Enclosed \$ _____			
NAME of Owner/Handler:			
ADDRESS:			
CITY	PROV /STATE	POSTAL CODE/ZIP	
Phone Number		Email address	

BDOC Trial Premium List Available at
www.bytowndogobedience.org OR www.colmars.com

**You deserve a
TRAINED Dog!**

**Your dog deserves to be
TRAINED
with the BEST!**

Motivational Dog Training Classes

Classes in:

- ❖ • **Puppy Socialization**
- ❖ • **Family Dog Training**
- ❖ • **Competitive Training**
- ❖ • **Rally-O**

BYTOWN DOG OBEDIENCE CLUB

**2684 Fenton Road
Ottawa (Gloucester), ON**

**Call our Registration Line
For More Information:**

(613) 822-4400

www.bytowndogobedience.org

Shhhhhhhhhhhhhhhhhhhhh.....

"Wanna hear a secret....."

FENTON HALL

For training, playing and just plain hanging out with your
Canine friend(s) during the long winter months !

Fenton Hall is the home of
BYTOWN DOG OBEDIENCE CLUB
2684 Fenton Rd., Ottawa (Gloucester), ON

Fenton Rental is reasonable and accessible
by contacting
BDOCRental@gmail.com

Hourly rates for BDOC Members

\$ 8.00 per hour

Hourly rates for Non - BDOC Members

\$ 10.00 per hour

Bundled rate - \$75.00 - 10 pre selected hours

Full Day rental of facility – 9:00 am to 5:00 pm \$ 250.00

CGN TEST (CANINE GOOD NEIGHBOUR) - \$ 20.00

FRIDAY MAY 6, 2011 – 6:30 PM TO 8 PM

Pre-registration is encouraged.

Registration on site will be allowed provided there is space available

Evaluator: Adelle Forth, Barbara Jeffrey

ACCOMMODATIONS

BLACK LAB INN - A Dog Friendly Bed & Breakfast - www.blacklabinn.com - 1-866-327-5391

DELTA HOTEL 613-238-6000

SOUTHWAY INN 1-877-688-4929 or 613-737-0811

NOVOTEL HOTEL 613-230-3033

WEBB'S MOTEL 613-728-1881 (Small Dogs Only)

MONTEREY INN 613-288-3500 (\$ 10.00 fee per pet)

TRAVELODGE OTTAWA HOTEL.. 613-722-7600 (no fee for dogs)

LES SUITES HOTEL 613-232-2000

DIRECTIONS TO THE SHOW SITE

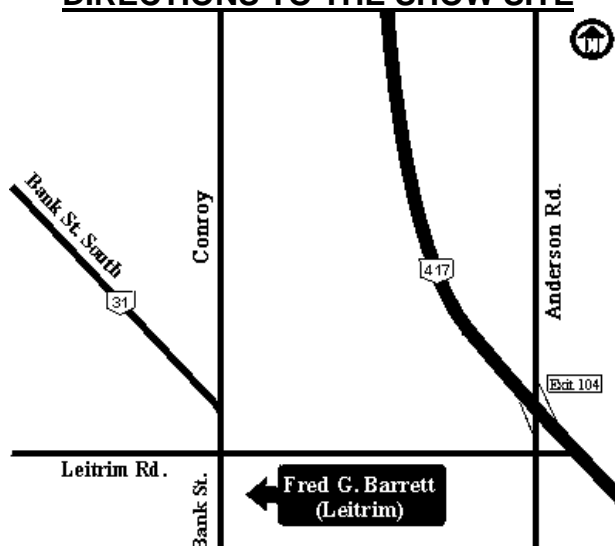

Driving Instructions

From Hwy-401: If you are Westbound on the 401, take exit # 721, on to Hwy 416 N.

If you are Eastbound from Toronto on the 401 take exit # 721 – A, on to Hwy 416 N.

Follow 416 N to exit # 72 – Hunt Club Road. Exit right & turn left on to Hunt Club Road East to Bank St, turn right on to Bank St., follow Bank St S., to Leitrim Rd., turn left at the lights at Leitrum & Bank St., the arena is the second building on your right.

From Hwy-417 East: take exit # 110, left on to Walkley Rd., Follow Walkley to Conroy Rd. Turn left on to Conroy Rd., At Hunt Club Rd turn right Follow Hunt Club Rd to Bank St, Turn left & follow Bank St., to Leitrim Rd., turn left at the lights at Leitrum & Bank St., the arena is the second building on your right.

From Hwy-417 West: follow signs to the 416 & exit right at Hunt Club Rd., turn left on Hunt Club Rd., East to Bank St, turn right on to Bank St., follow Bank St S., to Leitrim Rd., turn left at the lights at Leitrum & Bank St., the arena is the second building on your right..