

Stormont, Dundas, & Glengarry Dog Association



Entries Close AT 8 p.m

TUESDAY, Eukanuba

JULY 29, 2014

Friday, Saturday, Sunday, Monday

August 22, 23, 24, 25, 2014

118th, 119th, 120th, 121st

4 All Breed Championship Shows

131st, 132nd, 133rd, 134th, 135th, 136th

6 All Breed Obedience Trials (LIMITED ENTRY)

35th, 36th, 37th, 38th, 39th, 40th

6 All Breed Rally Trials (LIMITED ENTRY)

6 All Breed Agility Trials* (Limited Entry) *Separate Show Secretary

Long Sault Campgrounds, Woodlands Campsite, Long Sault, ON, Canada

<http://www.stlawrenceparks.com/lsp.htm>

These Shows held under the rules of The Canadian Kennel Club - This event held **Outdoors** - Unbenched & Unexamined
" no cover will be provided in case of inclement weather"

All Breed Baby Puppy offered Saturday & Sunday

All Breed Best Bred By – Friday Aug 22, 2014 – ONLY

All Breed Brace – Sunday August 24, 2014 – ONLY

(11) SPECIALTIES

Friday, August 22, 2014

Canadian Bloodhound Club - NATIONAL

Saturday, August 23, 2014

Bernese Mountain Dog Club of Canada - NATIONAL

Bouvier des Flandres Club of Canada - NATIONAL

Ottawa Valley All Setter Association

Pointer Club of Canada – National

Standard Schnauzer Club of Canada - NATIONAL

Rideau Terrier Club - Group 4 Specialty

Sunday, August 24, 2014

Bernese Mountain Dog Club of Ontario - REGIONAL

Specialty for Miniature Schnauzer Only - Rideau Terrier Club

Ottawa Valley Pointing Dog Club **AND** Wire Fox Terrier Club of Canada- NATIONAL

BOOSTERS

Boosters for – Bloodhound, **ALL TERRIERS**, Bernese Mountain Dog, Borzoi, **ALL POINTERS**, Braque Français, Kleiner Munsterlander Vorstehhund, Wire-Haired Pointing Griffon, Pointer, Pointer (GLH, GSH, GWH), Pudelpointer, Spaniel (Blue Picardy, Brittany, French), Spinone Italiano, Weimaraner, Setters (English, Gordon, Irish and Irish Red & White), Vizsla (SM & WH), Schnauzer (Standard)

Junior Handling - SD & G - Conformation - Sunday August 24, 2014

To comply with instructions issued by the CKC we will be unable to accept, cancel, or substitute any entry reaching our show secretary after the official closing date.

**NOW ELIGIBLE TO COMPETE IN
OBEDIENCE, RALLY & AGILITY**

(MIXED BREED of no breed designation - see inside for details)

A Dog that is eligible for a **CCN May Not Be Entered As A Listed Dog.**

Dogs may only enter events after a **CCN** has been issued to that dog.

S stormont
D undas
&
G lengarry
Long Sault
ON

Stormont, Dundas, & Glengarry Dog Association - Officers

(At time of Publication)

President.....Rachelle O'Meara Vice-PresidentCandy Beauchamp
Secretary.....Sandra Cummings Treasurer.....Connie Charlebois
Directors:.....Jodie O'Meara

Show Committee (At time of Publication)

Show Superintendent..... Jodie O'Meara, (613) 443-2262, banquise@sympatico.ca

Show Chairperson:..... Jodie O'Meara

Chief Ring Steward Candy Beauchamp

Booth Rental Jeff Dale, jdale@trademarkmedia.ca

RV & Trailer Parking - Jeff Dale, 613-366-2030 ext# 2000 jdale@trademarkmedia.ca

Show Photographer - Dogs In Design Photography, PO Box 123, Arden, ON K0H 1B0

Tel: 613-314-2816 - Fax: 613-335-4387 email: ddphotographies@gmail.com

No pictures may be taken for the purpose of resale at the SD & G dog show by anyone other than the official

show photographer(s) without express written consent from the SD & G club.

Veterinarian – St. Lawrence Valley Animal Hospital, 435 Pitt St., Cornwall, ON (613) 932-4094

Show Secretary - **COLMAR Show Service**, 340 Mercer St., Chatham, ON, Canada N7M 6E1

Phone: (519) 351-3147 Email: colmar@ciaccess.com website: www.colmars.com

Canadian Kennel Club

(at time of publishing)

Head Office: Lance Novak, Executive Director,

400 – 200 Ronson Dr., Etobicoke, ON. M9W 5Z9. (416) 675-5511

Eastern Ontario CKC Director Zone 5 – Bob Rowbotham,

505 Airport Rd., RR # 4, Stirling, ON K0K 3E0 – bob@rock107.ca

Conformation Rep Robert Whitney,

313 Pipeline Rd RR#2, Castleton, ON, K0K 1M0 rwhitney@xplornet.com

Obedience Rep Frances Holmes

112 Grey Stone Dr., Carp, ON KOA 1L0 frances@thetraininghall.com

Agility Rep..... Sandra Esford

1452 Wallbridge Loyalist Rd Belleville ON K8N 4Z5 goldencol@sympatico.ca

Junior Handling Rep: Kim Groves, 10 Grimes St., Brighton, ON K0K 1H0 avatarbmd@sympatico.ca

Catalogue Advertising

Bus Card or Quarter Page \$20.00 - Half Page \$ 30.00 - Full Page \$ 60.00 - Send camera ready materials along with a cheque payable to Stormont, Dundas, & Glengarry Dog Association by August 4, 2011, to: COLMAR Show Service, 340 Mercer St., Chatham, ON. N7M 6E1

Booth Space - Jeff Dale, 613-366-2030 ext# 2000 jdale@trademarkmedia.ca

All Booth Space is on a First Come First Serve Basis

10 x 10 - \$ 245.00, 10 x 20 - \$ 280.00, 10 x 30 or 20 x 20 - \$ 315 FOR THE WEEKEND

Electrical \$ 40.00 extra, includes 1 Table included

We welcome all exhibitors and spectators, including persons with disabilities. If you require accommodation of a disability, please make your accommodation known to the club in advance.

Please contact the Superintendent by the closing date to ensure that we can do our best to accommodate your needs.

Judges - SD & G – Conformation

Sandy AlexanderBox 2, Group 9, RR # 1, Dugald, MB R0E 0K0

Sandra Anderson.....7213 Stevenson Rd., Brockville ON K6V 5T4

Peggy Beisel-McIlwaine; 6225 N Maple Rd., Ann Arbor, MI USA 48105-8901

Stewart Dankner.....1153 Parthia Cres., Mississauga, ON L4Y 2L3

Barbara M. Heal.....RR # 5 5072 County Road 44, Spencerville, ON K0E 1X0

Karl-Erik Johansson Grindtorpsvägen 27 4tr S-18349 TABY, Sweden

Michael Leonard 196 Kimmage Rd., W, Dublin, Ireland

Kaye McGhie Brisbane, Queensland, Australia

David Swartwood255 Cunningham Rd., Gananoque, ON K7G 2V4

Judging Assignments – Conformation * Denotes Group Judge

Any Exhibitor who subjects any Judge, Club Official, Volunteer, or participant at this event to ANY indignities, shall be removed from the show grounds immediately and no refunds will be made

Group	Friday August 22, 2014	Sat. August 23, 2014	Sunday August 24/14	Monday Aug 25/14
1	Barbet, Braque Francais (Gascogne, Pyrenees), Griffon (WHP), Kleiner Münsterländer Vorstehund, Lagotto Romgnolo, Pointer (GLH, GSH, GWH), Pudelpointer, Spanish Water Dog,, Spinone Italiano Spaniel (Blue Picardy, Brittany, French.) Sandra Anderson Pointer, Retriever (Chesapeake Bay, Curly – coated, Flat-coated, Golden, Labrador, N.S. Duck Tolling), Vizsla (SH, WH), Weimaraner KE Johansson * Balance of Breeds Sandy Alexander	Barbet, Braque Francais (Gascogne, Pyrenees), Griffon (WHP), Kleiner Münsterländer Vorstehund, Lagotto Romgnolo, Pointer, Pointer (GLH, GSH, GWH), Pudelpointer, Spaniel (Blue Picardy, Brittany, French.) Sandy Alexander Spaniel (Am Cocker, Am Water, Clumber, English Cocker, English Springer, Field, Irish Water, Sussex, Welsh Springer Kaye McGhie Balance of Breeds P.Beisel-McIlwaine*	Retriever (CC, FC, Golden, Labrador), Spanish Water Dog, Spinone Italiano, Vizsla (SM & WH), Weimaraner Sandy Alexander Balance of Breeds Barbara Heal *	Retriever (Chesapeake Bay, Curly – coated, Flat-coated, Golden, Labrador, NSDTR) Kaye McGhie Pointer, Vizsla (Smooth Haired), Vizsla (Wire Haired), Weimaraner Michael Leonard Balance of Breeds KE Johansson *
2	Foxhound (American), Foxhound (English), Greyhound, Harrier, Ibizan Hound, Norrbottenspet, Norwegian Elkhound, Norwegian Lundehund, Otterhound, Pharaoh Hound Michael Leonard Balance of Breeds Stewart Dankner *	Greyhound, Harrier, Ibizan Hound, Irish Wolfhound, Norrbottenspet, Norwegian Elkhound, Norwegian Lundehund, Otterhound, PBGV, Pharaoh Hound, Rhodesian Ridgeback, Saluki, Shikoku, Whippet Kaye McGhie* Balance of Breeds Barbara Heal	Sandy Alexander	KE Johansson*
3	Sandy Alexander	Barbara Heal	Bernese Mountain Dog P. Beisel-McIlwaine Balance of Breeds KE Johansson*	Bernese Mountain Dog Kaye McGhie Balance of Breeds Michael Leonard *
4	Sandra Anderson	Kaye McGhie	Airedale, Am Staffordshire, Aust Terrier, Bedlington, Border Terrier, Bull Terrier, Bull Terrier (Min), Cairn, Cesky, Dandie Dinmont, Fox Terrier (Sm, Wire), Glen of Imaal, Parson Russell David Swartwood Balance of Breeds KE Johansson*	Michael Leonard
5	S. Anderson	Michael Leonard	KE Johansson	Kaye McGhie
6	Michael Leonard	S. Alexander	KE Johansson	Kaye McGhie
7	Kaye McGhie	S. Alexander	P. Beisel-McIlwaine	KE Johansson
BIS BPIS	S. Alexander & Best Bred By Ex	Kaye McGhie	KE Johansson & Best Brace	Michael Leonard

**There is limited Electric available in the Grooming Tent
Be Fair and Share**

BEST BRED BY EXHIBITOR – Conformation - Friday, August 22, 2014

The Stormont, Dundas & Glengarry dog Association is pleased to offer an UNOFFICIAL CLASS COMPETITION for breeders who enter the Bred By Exhibitor Class on **Friday, August 22, 2014, ONLY**.

This class is open only to dogs entered in the "bred by" class. There is no additional charge for this competition. Judging in this competition will be held after each official class is completed at the breed and group level, by the regular breed judge. Each winner will be eligible to compete for Best Bred by Exhibitor in his or her respective groups. Each group winner of the Best Bred by Exhibitor will be eligible to compete for Best Bred By Exhibitor in Show. A Judge will judge best Bred by Exhibitor in Show upon completion of General Specials. A flat ribbon will be awarded at the breed level. A Rosette will be awarded to all Group winners in this competition. A trophy and rosette will be awarded to the Best Bred By Exhibitor in Show.

Obedience & Rally Judges

Darwin Boles RR # 3, 18 Mountain Ash Dr., Kemptville, **ON K0G 1J0**

Bruce Gibbons RR # 4, 869 River Rd., Kemptville, **ON K0G 1J0**

Sharlene Manderson - 100 Tall Forest Drive, RR # 3, Carp, **ON K0A 1L0**

OBEDIENCE (LIMITED ENTRY) –Assignments

Rally / Obedience entries limited to 420 minutes per day/per judge – Trials may close earlier

Class	Trial # 1 Aug 22, 2014	Trial # 2 Aug 22, 2014	Trial # 3 Aug 23, 2014	Trial # 4 Aug 23, 2014	Trial # 5 Aug 24, 2014	Trial # 6 Aug 24, 2014
All Classes	Sharlene Manderson	Darwin Boles	Darwin Boles	Bruce Gibbons	Sharlene Manderson	Bruce Gibbons

RALLY (LIMITED ENTRY) - Assignments

Class	Trial # 1 Aug 22, 2014	Trial # 2 Aug 22, 2014	Trial # 3 Aug 23, 2014	Trial # 4 Aug 23, 2014	Trial # 5 Aug 24, 2014	Trial # 6 Aug 24, 2014
All Classes	Darwin Boles	Sharlene Manderson	Bruce Gibbons	Darwin Boles	Bruce Gibbons	Sharlene Manderson

Rally / Obedience entries limited to 420 minutes per day/per judge – Trials may close earlier

NOW ELIGIBLE TO COMPETE IN OBEDIENCE, RALLY & AGILITY

(MIXED BREED of no breed designation)

A Dog that is eligible for a **CCN May Not Be Entered As A Listed Dog.**

Dogs may only enter events after a **CCN** has been issued to that dog.

Canine Companion Number (CCN) Effective: July 1, 2014

1 Definitions

- Mixed Breed dog: is a dog of unknown ancestry that belongs to no recognized breed and is not the result of selective breeding.
- Unrecognized breed: is a dog of known ancestry not on the CKC list of recognized or miscellaneous breeds, and that is registered with a Registry recognized by the CKC.
- Recognized breed is a breed that CKC is authorized to register in accordance with the Animal Pedigree Act (APA) or a dog of a breed included in the CKC Miscellaneous Breed list

2 Purpose

- A Canine Companion Number (CCN) allows mixed and unrecognized breed dogs to participate in the CKC Performance Events of Agility, Obedience and Rally Obedience Trials.

3 Eligibility

- In order for a dog to receive a Canine Companion Number (CCN) the following criteria must be met:
 - The dog must be either a mixed breed or unrecognized breed as defined herein.
 - Mixed breed dogs must be spayed or neutered. Unrecognized breeds are not required to be spayed or neutered.
 - The dog must be identified with a Canadian Kennel Club approved microchip.

4 Applying for a Canine Companion Number (CCN)

- Complete the appropriate Canadian Kennel Club Canine Companion Number application form.
- With the completed form, accompanying documentation must be included as follows
 - Mixed breed dogs - proof of spay or neuter.
 - Unrecognized dogs not eligible for registration by CKC and not on the Miscellaneous List – a copy of a registration certificate from a CKC recognized Registry.
 - The appropriate fee as noted in the CKC fee schedule.

5 Upon receipt of a Canine Companion Number (CCN), the dog may be entered in any of the events noted in 2 a.

6 A dog that is eligible for a CCN may not be entered as a listed dog.

7 The Canadian Kennel Club may cancel for cause, any Canine Companion Number."

US Obedience Exhibitors

Any dog holding an AKC - CD Title is not eligible for Novice A, but may enter Novice B.

Any dog holding an AKC - CDX Title is not eligible for Open A, but may enter Open B.

CLASSES – OBEDIENCE

The following Official CKC Classes will be provided:

Pre – Novice, Novice "A", & "B", "C", Intermediate Novice, Open "A", Open "B", and Utility A & B.

6.9 MOVING UP – OBEDIENCE

CKC Rules And Regulations (Effective January 01, 2012)

6.9.1 A dog that is registered in the records of the CKC or has a PEN, and ERN, or a MCN and has fulfilled the requirements for a title in accordance with these rules but at the time of the closing of entries for the trial has not received confirmation of the title may be moved to the next level of competition providing the request is submitted to the trial secretary on the appropriate move-up form by the owner or handler a minimum of one hour before the opening of the first trial on that day, schedule permitting.

6.9.2 When one or more trials are held on the same day in the same venue, the request for moving the dog up must be made a minimum of one hour prior to the scheduled start of the trial for which the dog is being moved up to, schedule permitting.

6.9.3 In the case of limited entry trial, move ups are permitted and the club is exempt from

Section 4.3.4.

6.9.5 If it is established by the CKC that a dog moved up to the next level has not completed the requirements for the lower level before moving up, then all qualifying ribbons and/or awards earned by the dog incorrectly entered shall be forfeited and cancelled by the CKC and the owner may be subject to disciplinary action.

6.9.6 In order for a dog to be eligible to move up, the dog must be individually registered in the CKC or have a Performance Event Number (PEN), an Event Registration Number (ERN) or a Miscellaneous Certification Number (MCN) before entries close. The addition of a CKC number after close of entries does not make the dog eligible and will result in referral to the Discipline Committee.

6.9.7 **Exhibitors incorrectly entered** in the "A" class are permitted to move the dog to the corresponding "B" class up to one hour before the start of the trial.

PERFORMANCE EVENT NUMBER (PEN)

Effective Jan 01, 2002,

A Performance Event Number (PEN), allows an unregistrable dog of a CKC recognized breed to participate in those competitive events that are appropriate for the breed. Those events are as follows: Obedience, Tracking, Herding, Draft Dogs, Agility, Lure Coursing, Earthdog Tests, Hunt Tests, Working Certificate Tests, and Pointing Field Dog Tests. A Dog that is eligible for a PEN may not be entered as a listed dog. Dogs may only enter events after a PEN has been issued to that dog. This restriction shall also apply to dogs with ILP numbers. Unregistrable Dog means, a dog of a recognized CKC breed that cannot be registered because of unknown parentage or the unavailability of its registration papers.

All Emails & Faxes

It will be the responsibility of the exhibitor to ensure that any electronic submission, either email or facsimile, *or any* document transmitted electronically reaches the proper authority or recipient within the times and limits as regulated for each document in the CKC Rules & Regulations. Sent fax receipts and / or copies of sent emails will not be taken as evidence of receipt by the recipients.

SD & G ALL BREED AGILITY TRIALS - - AUGUST 22, 23, 24, 2014

Entries Open - 8 a.m. May 31 , 2014

Entries Close - 8 p.m. August 8, 2014

or automatically when the limit of 300 runs a judge is reached

Make Cheque or Money Order payable to

Stormont, Dundas & Glengarry Dog Association (SG&D Dog Association)

Mail Agility Entries To:

Agility Trial Secretary, Gail Giles, rythmk9@hotmail.com

1523 Lazier Rd., RR#2, Shannonville, ON K0K 3A0

Entryline will also take entries for this trial

1523 Lazier Rd., RR#2, Shannonville, ON K0K 3A0

To comply with instructions issued by the CKC we will be unable to accept, cancel, alter, or substitute any entry reaching our Trial Secretary after the above time & date.

These events held under the rules of the "Canadian Kennel Club"

**For a Complete Premium List for these trials visit the
Belleville & District Kennel Club Website at**

<http://www.bellevilledistrictkennelclub.com>

4 Standard Classes, 3 JWW Classes, 4 PAD and 4 Steeplechase over the weekend

Regular Classes

Novice, Intermediate, Excellent & Master Excellent and

Selected and Veterans Classes

Novice, Intermediate and Excellent, & Master Excellent

Outdoors, on grass surface, ring size 110' x 110' - No cover provided in case of inclement weather

Agility Judges and Assignments		
Friday, August 22	Trial 1 2 Points and Distance all levels	Wendy Beard, Carp, ON
	Trial 2 2 Steeplechase	Wendy Beard, Carp, ON
Saturday, August 23	Trial 3 2 Standard 1 JWW All Classes	Wendy Beard, Carp, ON
	Trial 4 2 JWW All Classes	Anic Vermette, Quebec QC
Sunday, August 24	Trial 5 2 STD All Classes	Anic Vermette, Quebec QC
	Trial 6 2 Points and Distance all levels 2 Steeplechase	Sandra Esford, Belleville ON

Agility Entry Fees (Canadian Funds or U.S. Funds)

Entry of each dog per run \$ 25.00
 Weekend Package (Sat & Sun all Trials, Same Dog 11 runs)..... \$ 220.00
 Package of 15 run, same dog, All trials \$ 300.00

Same day entry \$30.00 available only if limit not reached

Listing fee, per dog per trial \$ 9.70**

All fees include HST and are payable in Canadian Funds.

Post-dated cheques will not be accepted.

****A listing fee is required for all dogs entered, who do not have an individual CKC Registration number, an E.R.N. number or a P.E.N. Number**

OFFICIAL CANADIAN KENNEL CLUB FORM - SD&G - CONFORMATION			Armband #
<input type="checkbox"/> Friday, August 22, 2014	<input type="checkbox"/> Sunday, August 24, 2014		
<input type="checkbox"/> Saturday, August 23, 2014	<input type="checkbox"/> Monday, August 25, 2014		
Obedience	Dates	Rally	Price List
<input type="checkbox"/> Trial 1 <input type="checkbox"/> Trial 2	Friday August 22, 2014	<input type="checkbox"/> Trial 1 <input type="checkbox"/> Trial 2	Entry Fee: \$ 30.00 CDN/USD
<input type="checkbox"/> Trial 3 <input type="checkbox"/> Trial 4	Saturday, Aug 23, 2014	<input type="checkbox"/> Trial 3 <input type="checkbox"/> Trial 4	Baby Puppy Entry Fee: \$ 25.00 CDN/USD
<input type="checkbox"/> Trial 5 <input type="checkbox"/> Trial 6	Sunday, August 24, 2014	<input type="checkbox"/> Trial 5 <input type="checkbox"/> Trial 6	Listing Fee: \$ 9.70 CDN or USD
			Other Fees: Sweepstakes, Exhibition, & Non- - Regular - \$ 15.00 CDN or USD
<input type="checkbox"/> Pre Paid and Pre Ordered Catalogue \$ 15.00 CDN/USD			TOTAL FEES FOR THIS ENTRY: \$
Make Cheques Payable to SD & G Dog Association Entries Close: Tuesday JULY 29, 2014 at 8 pm			
Conformation	Rally (Limited Entry)	Obedience (Limited Entry)	
<input type="checkbox"/> Baby Puppy (3-6 mos) <input type="checkbox"/> Bred By Exhibitor	Jump Heights	<input type="checkbox"/> Pre - Novice <input type="checkbox"/> Open A <input type="checkbox"/> Utility A	
<input type="checkbox"/> Baby Sat & Sun ONLY	<input type="checkbox"/> 6" <input type="checkbox"/> 8" <input type="checkbox"/> 12" <input type="checkbox"/> 16"	<input type="checkbox"/> Novice A <input type="checkbox"/> Open B <input type="checkbox"/> Utility B	
<input type="checkbox"/> Jr. Puppy (6 - 9 mos) <input type="checkbox"/> Open	<input type="checkbox"/> Novice A <input type="checkbox"/> Novice B	<input type="checkbox"/> Novice B <input type="checkbox"/> Exhibition	
<input type="checkbox"/> Sr. Puppy (9 - 12 mos) <input type="checkbox"/> Specials Only	<input type="checkbox"/> Advanced A <input type="checkbox"/> Advanced B	<input type="checkbox"/> Novice C	
<input type="checkbox"/> 12 - 18 month <input type="checkbox"/> Brace (Sun Only)	<input type="checkbox"/> Excellent A <input type="checkbox"/> Excellent B	<input type="checkbox"/> Intermediate Nov	
<input type="checkbox"/> Canadian Bred <input type="checkbox"/> Exhibition		Jump Heights Height Width	
BREED			SEX: <input type="checkbox"/> MALE OR <input type="checkbox"/> FEMALE
REGISTERED			
NAME OF DOG			
Check One & Enter Number Here		IS THIS A PUPPY?	
<input type="checkbox"/> CKC Reg #	<input type="checkbox"/> CKC PEN #	<input type="checkbox"/> Yes or <input type="checkbox"/> No	
<input type="checkbox"/> CKC ERN #	<input type="checkbox"/> CKC Misc Cert.#	PLACE OF BIRTH?	
<input type="checkbox"/> CKC CCN.#	<input type="checkbox"/> LISTED	<input type="checkbox"/> Canada	
		<input type="checkbox"/> Elsewhere	
BREEDER(S)			
SIRE			
DAM			
REGISTERED OWNER(S)			
OWNER'S ADDRESS			
CITY	PROV/STATE	POSTAL CODE/ZIP	
NAME OF OWNERS AGENT (IF ANY) AT THE SHOW			
AGENT'S ADDRESS			
CITY	PROV/STATE	POSTAL CODE/ZIP	
Mail ID to: <input type="checkbox"/> OWNER Or <input type="checkbox"/> AGENT			
I certify that I am the registered Owner(s) of the dog or that I am the authorized agent of the Owner(s) whose name(s) I have entered above and accept full responsibility for all statements made in this entry. In Consideration of the acceptance of this entry, I (we) agree to be bound by the rules and regulations of the Canadian Kennel Club and any additional rules and regulations appearing in the premium list. Also, by signing this form I certify that I will not hold the Show giving Club, it's members, Directors, Employees, or Agents, liable in the event of any accident or misfortune however caused.			
Signature of Agent or Owner			Phone Number
a 15% + HST, charge applies on Credit Card Charges			Email address
<input type="checkbox"/> VISA <input type="checkbox"/> MasterCard <input type="checkbox"/> AMEX		Expiry Date: Month > _____ Year > _____	
Card Number: _____ -- _____ -- _____			
Name of Card Holder: _____			
Fax # 519-351-3223	Mail To: COLMAR Show Service, 340 Mercer St, Chatham, ON, Canada N7M 6E1		
	Web Site: www.colmars.com		

All Fees are payable at time of entry. No entry will be processed or entered in this show without payment.
Listing fees are applicable for all dogs entered in the shows that do not have an individual CKC Reg. or an ERN number

Entry Information

	Canadian Funds	US Funds
**Entry Fee, of each dog, per entry per show/day	\$ 30.00	\$ 30.00
Baby Puppy (listing Fee goes not apply to this class).....	\$ 25.00	\$ 25.00
Listing Fee – per dog, per show/day	\$ 9.70	\$ 9.70
All Non – Regular & Unofficial Classes & All Breed Brace.....	\$ 15.00	\$ 15.00
Exhibition Only.....	\$ 15.00	\$ 15.00
Specialty Brace.....	\$ 15.00	\$ 15.00
Specialty Parades (Must be in Exhibition or one Regular Classes).....	N/C	N/C
Sweepstakes	\$ 15.00	\$ 15.00
Pre-Ordered & Prepaid Catalogue	\$ 15.00	\$ 15.00

All Fees are payable at time of entry. No entry will be processed or entered in this show without payment. Listing fees are applicable for all dogs entered in the shows that do not have an individual CKC Reg. Number or an ERN number. Tendering of an NSF cheque in payment of entry fees shall be considered non-payment of fees (8.8.2).

****A service charge of \$35.00 CDN OR US FUNDS will be applied to all NSF cheques.****

Make ALL cheques payable to: **Stormont, Dundas, & Glengarry Dog Association**
and MAIL TO: **COLMAR Show Service, 340 Mercer St., Chatham, ON, Canada N7M 6E1**

With the uncertainty and unreliability of the postal system and email, it is advisable to send your entry via priority post, registered mail, or Entryline. It is your responsibility to verify receipt of any electronic entries or email correspondence. We cannot be held responsible for mail lost in transit or misdirected electronically or physically.

Fax Entries - VISA - MasterCard & American Express - Entries

You may fax your entry directly to us at 519-351-3223. Also you may charge your entries to your Visa/MasterCard/AMEX. Include the card number, expiry date, and name on the card, on the entry form, or a separate piece of paper. A NON - REFUNDABLE administration fee of 15% plus HST will be charged.

All Credit Card Charges Will Be Made in Canadian Funds.

ANY REFUNDS WILL BE MADE IN CANADIAN FUNDS FROM THE SHOW GIVING CLUB.

General Entry Information

- LIMITED NUMBER OF CATALOGUES WILL BE AVAILABLE AT THE SHOW FOR \$ 20.00 CDN/USD.
- To comply with instructions issued by the Canadian Kennel Club we will be unable to accept, cancel, or substitute an entry reaching our Show Secretary after the closing date, except for moving class dogs to Specials.
- All entry confirmations and Judging Schedules will be mailed as soon as possible after entries close.
- It is your responsibility to verify the receipt of any electronic entries prior to the advertised closing date. A valid means of payment must accompany all entries.
- In the event that the dog is absent, excused by a Veterinarian or Judge, disqualified, or barred from competition by action of the bench Committee, no entry fees will be refunded.
- There is no refund for duplicate entries. All efforts will be made to find all duplicate entries. However, if the entry has been processed and appears in the official catalogue, no refund will be made.
- The Stormont, Dundas, & Glengarry Dog Association & COLMAR Show Service will not be responsible for cash sent through the mail.
- Overpayments will be applied to the General Trophy fund. Therefore, please calculate fees carefully.
- No entry will be accepted unless accompanied by full entry fees. NO post-dated cheques.
- Incomplete entries will be returned. Handlers and agents please note the full address of all owners must be filled in. **Refunds will not be given for anyone double entering the same dog.**
- Exhibitors must abide by errors made in entering their dogs regardless of how or by whom the entries were made.
- Only dogs eligible for registration with CKC may enter this show and trial.
- **Bitches, when in season**, are not permitted to compete in the Trial, however, entry fees will be refunded, providing a veterinarian's certificate stating that the bitch was in season within the 10 day period preceding the trial, is submitted to the Trial Secretary, on or before the date of the trial.

The Stormont, Dundas, & Glengarry Dog Association reserves the right to refuse any entries, subject to CKC rules.



ENTRYLINE - Dog Show Entry Service

PHONE: 1-800-293-2935 FAX: 1-519-754-0796 www.theentryline.com (a Secured Site)

" The Dog Show Entry Service that lets you focus on winning"

Important: Entries taken until: 6:00 pm on day of closing

This is a privately owned business and charges a fee for this service

BOOSTERS

Bernese Mountain Dog Club of Canada - Saturday Aug 23, 2014 Judge: Barbara Heal

Through the generosity of friends and the members of Bernese Mountain Dog Club of Canada the following prizes will be offered. BOB, BOS, BPIB, BOW, WB & WD

Bernese Mountain Dog Club of Ontario - Sunday Aug 24, 2014 Judge: P. Beisel-McIlwaine

Through the generosity of friends and the members of Bernese Mountain Dog Club of Ontario, the following prizes will be offered. BOB, BOS, BPIB, BOW, WB & WD

Canadian Bloodhound Club - Sunday, August 24, 2014 Judge: S. Alexander

Through the generosity of friends and members The German Shorthaired Pointer Club of Canada is pleased to offer the following prizes BOB, BOS, BPIB, BOW, WB, & WD.

Borzoi Canada - Sunday, August 24, 2014 Judge: Sandy Alexander

Through the generosity of friends and the members of Borzoi Canada the following prizes will be offered. BOB, BOS, BPIB, BOW, WB & WD

Border Terrier Club of Ontario - Saturday, Aug 23/14 –Judge: Kaye McGhie

Through the generosity of friends and members The Border Terrier Club of Ontario is pleased to offer the following prizes BOB, BOS, BPIB, BOW, WB, & WD.

Cairn Terrier Club of Canada – ON E Region - Saturday Aug 23, 2014 Judge: Kaye McGhie

Through the generosity of friends and members The Cairn Terrier Club of Canada- OER is pleased to offer the following prizes BOB, BOS, BPIB, BOW, WB, & WD.

German Shorthaired Pointer Club of Canada - Saturday, August 23, 2014 Judge: S. Alexander

Through the generosity of friends and members The German Shorthaired Pointer Club of Canada is pleased to offer the following prizes BOB, BOS, BPIB, BOW, WB, & WD.

Irish Setter Club of Canada - Sunday, August 24, 2014 Judge: Barbara Heal

All Rebate fees from this booster will be applied to the Club Rescue Fund

Std Schnauzer Club of Canada Saturday, August 23, 2014 - Judge: Barbara Heal

Through the generosity of friends and members Std Schnauzer Club of Canada is pleased to offer the following awards: BOB, BOS, BPIB, BOW, WB, WD, RWD & RWB

Highest Scoring Standard Schnauzer of the Day in Agility, Obedience & Rally, on Sunday August 24

Ottawa Valley All Setter Association - Sunday, August 24, 2014

Judge: **Barbara Heal**

Setters (English, Gordon, Irish, Irish Red & White)

In lieu of prizes, the Ottawa Valley All Setter Association

will be donating a portion of the rebate received to a charity of the club's choice..

Ottawa Valley Pointing Dog Club - Saturday Aug 23, 2014

(All Pointing Breeds)

Braque Français, Kleiner Munsterlander Vorstehhund, Wire-Haired Pointing Griffon, Pointer, Pointer (GSH, GLH, GWH), Pudelpointer, Spaniel (Blue Picardy, Brittany, French), Spinone Italiano, Vizsla (SM & WH), Weimaraner

Judge: **Sandy Alexander**

Setter (Irish, English, Gordon, Irish R & W)

Judge: **P. Beisel-McIlwaine**

In lieu of prizes, the Ottawa Valley Pointing Dog Club will be donating a portion of the rebate received to a charity of the club's choice

Pointer Club of Canada - Sunday, August 24, 2014 Judge: Barbara Heal

Through the generosity of friends and members The Pointer Club of Canada is pleased to offer the following prizes BOB, BOS, BPIB, BOW, WB, & WD.

Rideau Terrier Club – All Terriers - Sunday, August 24, 2014

Airedale, Am Staffordshire, Aust Terrier, Bedlington, Border Terrier, Bull Terrier, Bull Terrier (Min), Cairn, Cesky, Dandie Dinmont, Fox Terrier (Sm, Wire), Glen of Imaal, Parson Russell

Judge: **David Swartwood**

Rideau Terrier Club Balance of Group Four Breeds

Judge: **KE Johansson**

Through the generosity of friends and members the Rideau Terrier Club is pleased to offer the following awards: Group 1st, 2nd, 3rd, 4th & BPIG.

Legend of Abbreviations

BB = Best of Breed, **BOS** = Best Of Opposite Sex, **WD** = Winners Dog, **WB** = Winners Bitch, **BW** = Best of Winners, **BP** = Best Puppy In Breed & **HQS** = Highest Qualifying Score , The Stormont, Dundas & Glengarry Dog Association is pleased to offer rosettes for Best Of Breed, Best Of Opposite Sex, Winners Dog, Winners Bitch, Best of Winners, Best Puppy In Breed The Clubs have offered to support the entry in their breed

Eukanuba 

OFFICIAL CANADIAN KENNEL CLUB FORM - SD&G - CONFORMATION			Armband #
<input type="checkbox"/> Friday, August 22, 2014	<input type="checkbox"/> Sunday, August 24, 2014		
<input type="checkbox"/> Saturday, August 23, 2014	<input type="checkbox"/> Monday, August 25, 2014		
Obedience	Dates	Rally	Price List
<input type="checkbox"/> Trial 1 <input type="checkbox"/> Trial 2	Friday August 22, 2014	<input type="checkbox"/> Trial 1 <input type="checkbox"/> Trial 2	Entry Fee: \$ 30.00 CDN/USD
<input type="checkbox"/> Trial 3 <input type="checkbox"/> Trial 4	Saturday, Aug 23, 2014	<input type="checkbox"/> Trial 3 <input type="checkbox"/> Trial 4	Baby Puppy Entry Fee: \$ 25.00 CDN/USD
<input type="checkbox"/> Trial 5 <input type="checkbox"/> Trial 6	Sunday, August 24, 2014	<input type="checkbox"/> Trial 5 <input type="checkbox"/> Trial 6	Listing Fee: \$ 9.70 CDN or USD
		Other Fees: Sweepstakes, Exhibition, & Non- - Regular - \$ 15.00 CDN or USD	
<input type="checkbox"/> Pre Paid and Pre Ordered Catalogue \$ 15.00 CDN/USD			TOTAL FEES FOR THIS ENTRY: \$
Make Cheques Payable to SD & G Dog Association Entries Close: Tuesday JULY 29, 2014 at 8 pm			
Conformation	Rally (Limited Entry)	Obedience (Limited Entry)	
<input type="checkbox"/> Baby Puppy (3-6 mos) <input type="checkbox"/> Bred By Exhibitor	Jump Heights	<input type="checkbox"/> Pre - Novice <input type="checkbox"/> Open A <input type="checkbox"/> Utility A	
<input type="checkbox"/> Baby Sat & Sun ONLY	<input type="checkbox"/> 6" <input type="checkbox"/> 8" <input type="checkbox"/> 12" <input type="checkbox"/> 16"	<input type="checkbox"/> Novice A <input type="checkbox"/> Open B <input type="checkbox"/> Utility B	
<input type="checkbox"/> Jr. Puppy (6 - 9 mos) <input type="checkbox"/> Open	<input type="checkbox"/> Novice A <input type="checkbox"/> Novice B	<input type="checkbox"/> Novice B <input type="checkbox"/> Exhibition	
<input type="checkbox"/> Sr. Puppy (9 - 12 mos) <input type="checkbox"/> Specials Only	<input type="checkbox"/> Advanced A <input type="checkbox"/> Advanced B	<input type="checkbox"/> Novice C	
<input type="checkbox"/> 12 - 18 month <input type="checkbox"/> Brace (Sun Only)	<input type="checkbox"/> Excellent A <input type="checkbox"/> Excellent B	<input type="checkbox"/> Intermediate Nov	
<input type="checkbox"/> Canadian Bred <input type="checkbox"/> Exhibition		Jump Heights Height Width	
BREED			SEX: <input type="checkbox"/> MALE OR <input type="checkbox"/> FEMALE
REGISTERED			
NAME OF DOG			
Check One & Enter Number Here		Date Of Birth: Please Circle Month	IS THIS A PUPPY?
<input type="checkbox"/> CKC Reg #	<input type="checkbox"/> CKC PEN #	Jan Feb Mar Apr May June	<input type="checkbox"/> Yes or <input type="checkbox"/> No
<input type="checkbox"/> CKC ERN #	<input type="checkbox"/> CKC Misc Cert.#	July Aug Sept Oct Nov Dec	PLACE OF BIRTH?
<input type="checkbox"/> CKC CCN.#	<input type="checkbox"/> LISTED	Day _____ Year _____	<input type="checkbox"/> Canada
			<input type="checkbox"/> Elsewhere
BREEDER(S)			
SIRE			
DAM			
REGISTERED OWNER(S)			
OWNER'S ADDRESS			
CITY	PROV/STATE	POSTAL CODE/ZIP	
NAME OF OWNERS AGENT (IF ANY) AT THE SHOW			
AGENT'S ADDRESS			
CITY	PROV/STATE	POSTAL CODE/ZIP	
Mail ID to: <input type="checkbox"/> OWNER Or <input type="checkbox"/> AGENT			
I certify that I am the registered Owner(s) of the dog or that I am the authorized agent of the Owner(s) whose name(s) I have entered above and accept full responsibility for all statements made in this entry. In Consideration of the acceptance of this entry, I (we) agree to be bound by the rules and regulations of the Canadian Kennel Club and any additional rules and regulations appearing in the premium list. Also, by signing this form I certify that I will not hold the Show giving Club, it's members, Directors, Employees, or Agents, liable in the event of any accident or misfortune however caused.			
Signature of Agent or Owner			Phone Number
a 15% + HST, charge applies on Credit Card Charges			Email address
<input type="checkbox"/> VISA <input type="checkbox"/> MasterCard <input type="checkbox"/> AMEX	Expiry Date: Month > _____ Year > _____		
Card Number: _____ -- _____ -- _____			
Name of Card Holder:			
Fax #	Mail To: COLMAR Show Service, 340 Mercer St, Chatham, ON, Canada N7M 6E1		
519-351-3223	Web Site: www.colmars.com		

All Fees are payable at time of entry. No entry will be processed or entered in this show without payment.
Listing fees are applicable for all dogs entered in the shows that do not have an individual CKC Reg. or an ERN number

EVENT REGISTRATION NUMBER (ERN)

Effective Jan 1/92, all dogs that are foreign born and foreign owned and enter Canada for the sole purpose of entering CKC events will no longer require a CKC registration number, but will require an Event Registration Number (ERN). The ERN number MUST be applied for within 30 days of the first day of entering a CKC event.

For further information, contact: **The Canadian Kennel Club**

Phone (416) 675-5511 FAX (416) 675-6506 HOURS: 9:00 a.m. – 5:00 p.m.

GENERAL INFORMATION

CKC Conformation Rules & Regulations 12.2.2 - PUPPIES 3-6 Months (January 1, 2007)

- a) Dogs 3 months of age and under 6 months of age on the day of the show may be entered in Exhibition Only, providing that the owner of the puppies has also entered a dog in one of the regular official classes.
b) Puppies in this category may not compete in any official, unofficial or non-regular classes including parades.

COLMAR Note: Listing Fees do not apply & need not be paid for "Exhibition Only" entries.

- ◆ Limited number of catalogues will be available at the show for \$ 20.00. (Pre-ordering is highly recommended.)
- ◆ The show precincts **30 feet from any ring or building housing show executives.**
- ◆ **"No Show - All Breed or Specialty, Event, Performance Event, or Best in Show Judging, shall be delayed for any Exhibitor who has a conflict in another ring or event. All exhibitors are expected to have alternative arrangements made for any possible conflict."**
- ◆ The Show Superintendent has the authority to ask exhibitors to move or take down any crates and private exercise pens, etc. Failure to do so when requested could result in disciplinary action.
- ◆ Exhibitors are requested to keep their grooming and crating areas clean and tidy. If space is at a premium, exhibitors must remove exercise pens if requested by the Show Superintendent or designate.
- ◆ Dogs not entered in these shows will NOT be allowed within the precincts of the show & trial.
- ◆ The Show Superintendent will be in full charge of the show, governed by CKC rules.
- ◆ If, because of riot, civil disturbance, or other acts beyond the controls of the management, it is impossible to open or complete the show or trial, no refund of Entry Fees will be made.
- ◆ It shall be the duty and obligation of the show-giving club to ensure that a judge or any show committee members are not subjected to any indignities. The Conformation Show Committee shall promptly report to the CKC any infringement of this regulation, and the Discipline Committee will have the authority to take such action as it deems fit on receipt of a report indicating that this has occurred.
- ◆ The COLMAR Show Service & the Stormont, Dundas, & Glengarry Dog Association will use care and diligence for the welfare of all dogs, exhibitors and spectators, but will not be responsible for, nor assume any liability in the event of accident or misfortunes, however caused.
- ◆ Dogs need only to arrive 15 minutes before scheduled judging time and will be excused from each show when not required for further judging. Waiting for dogs will not be possible and handlers with several breeds must arrange for alternate handlers if judging times for their breeds conflict.
- ◆ COLMAR Show Service will only collect and utilize data and information that you provide us, and only for the purposes of the service we provide exhibitors entering a CKC (Canadian Kennel Club) event, and the subsequent documents generated for this event, and required by the CKC. The type and accuracy of the information is solely contingent upon what you voluntarily provide to us. We will not use or disclose personal information for the purposes other than those for which it was collected, except with consent or as required by law. Personal information will not be retained longer than needed for the specified purposes.
- ◆

SD & G Junior Handling Conformation

All Junior Handling Classes offered - **Sunday, August 24, 2014 Judge: TBA**

All Juniors should register with the Show Secretary one hour before competition. Stormont, Dundas & Glengarry Dog Association is pleased to offer Flats for 1st to 4th in each class, and a Rosette for Best Junior Handler overall.

Prizes For Junior Handling Sponsored By Best in Show - Show Supplies

Eukanuba 

 **Best in Show Dog Supplies**

Champions and Championship Points

Chapter 15.1 A dog awarded WINNERS at a championship show shall be credited with a number of championship points (ranging from 0 to 5) and the number of championship points credited to a dog awarded WINNERS shall be as provided hereunder.

15.1.2 The schedule to be employed in the determination of the number of points to be allocated a dog awarded Winners shall be:

Dogs Competing*	1	2	3 to 5	6 to 9	10 to 12	13 or more
Points Allocated *includes the dog awarded WINNERS	0	1	2	3	4	5

In counting the number of eligible dogs in competition, a dog that is disqualified, dismissed, excused or ordered from the ring by the judge shall **NOT** be included in the calculation for championship points.

Note: To determine the number of championship points earned by a dog awarded WINNERS, total all the dogs in competition which the dog defeated, directly or indirectly, for the highest of the following official breed awards, Winners, Best of Winners, Best of Breed, or Best of Opposite Sex, then consult the schedule set forth above.

Section 15.1.8, ... a dog awarded WINNERS which also places in the regular group competition shall be credited with the following additional points, provided that a dog was defeated at the Group level.

Number of breeds competing at Group level	Placed 1 ST	Placed 2 ND	Placed 3 RD	Placed 4 TH
13 or more	5	4	3	2
10 to 12	4	3	2	1
6 to 9	3	2	1	1
5	2	1	1	1
4	2	1	1	0
3	2	1	0	0
2	1	0	0	0
1	0	0	0	0

Section 15.1.9, A dog may not be credited with more than five (5) championship points in a single show.

Section 15.1.11, A dog awarded WINNERS which also places Best in Show at an all-breed Championship Show shall be credited with five (5) championship points inclusive of any points earned at breed or group level.

Section 15.1.12 (c), In order for a dog to be recognized as a Champion and its owner provided with a Championship certificate, the dog must...have earned at least one 2 point win either at the breed or group level.

Moving a Class Dog to Specials

Chapter 8, Section 8.9.1, A dog which is individually registered in the records of the Canadian Kennel Club, and has completed the requirements for a championship in accordance with these rules but at the time of the closing of entries for a show has not received confirmation of the title, may be transferred from one of the regular classes to "Specials Only", providing the transfer is submitted to the Show Secretary in WRITING by the owner or handler at least one (1) hour prior to the opening of the show.

Section 8.9.3, When one or more all-breed and/or specialty shows are held on the same day, in the same venue, the request for moving of class dogs to specials must be made prior to the scheduled opening of the first show.

Every day of a 2 or more day show is a separate show. Please note that this rule is effective up to one (1) hour prior to the opening of the show, NOT one hour prior to the judging of the breed.

CKC Rules & Regulations 4.1.3 - A judge officiating at a show held under these rules shall not be subjected to indignities of any kind during the progress of the show. It shall be the duty and obligation of the club holding the show to see that this rule is effectively carried out.

Trophy List

Though the generosity of members and friends, the Stormont, Dundas, & Glengarry Dog Association, is pleased to offer prizes and Rosettes for the following each day:

Best in Show, Best Puppy in Show, High In Trial, High in Obedience & Rally Class,
First in Each Group, Best Puppy in Each Group, Rosettes for Best Brace in Group & Show
Performance Event New Title Rosettes will be offered to any Exhibitor that receives their Title
in Obedience, Rally, or Agility, at these Trials.

It is the exhibitors' responsibility to pick up their rosette, all rosettes must be picked up at the show.
No rosettes will be mailed.

Best In Show Dog show supplies will be offering gift certificates for Best Brace in Group and Best Brace Overall.

NON CKC MEMBER PARTICIPATION FEE - CANADIAN RESIDENTS ONLY

Effective April, 2011.

The CKC will be instituting a Non-Member Participation fee for all Canadian residents who participate in a CKC event but are not CKC members. The non member participation fee is paid in any year a title is earned and covers all titles and dogs owned by that individual. In order to protect the awards/titles earned, the non-member will have a choice either to become a CKC member or to pay the non-member participation fee. Failure to comply within 30 days of notification will cause all awards and titles to be cancelled This applies to dogs wholly owned by non members resident in Canada, and does not apply to U.S. exhibitors nor to CKC members or dogs co-owned with a CKC member

OFFICIAL CANADIAN KENNEL CLUB FORM - SD&G - CONFORMATION			Armband #
<input type="checkbox"/> Friday, August 22, 2014	<input type="checkbox"/> Sunday, August 24, 2014		
<input type="checkbox"/> Saturday, August 23, 2014	<input type="checkbox"/> Monday, August 25, 2014		
Obedience	Dates	Rally	Price List
<input type="checkbox"/> Trial 1 <input type="checkbox"/> Trial 2	Friday August 22, 2014	<input type="checkbox"/> Trial 1 <input type="checkbox"/> Trial 2	Entry Fee: \$ 30.00 CDN/USD
<input type="checkbox"/> Trial 3 <input type="checkbox"/> Trial 4	Saturday, Aug 23, 2014	<input type="checkbox"/> Trial 3 <input type="checkbox"/> Trial 4	Baby Puppy Entry Fee: \$ 25.00 CDN/USD
<input type="checkbox"/> Trial 5 <input type="checkbox"/> Trial 6	Sunday, August 24, 2014	<input type="checkbox"/> Trial 5 <input type="checkbox"/> Trial 6	Listing Fee: \$ 9.70 CDN or USD
			Other Fees: Sweepstakes, Exhibition, & Non- - Regular - \$ 15.00 CDN or USD
<input type="checkbox"/> Pre Paid and Pre Ordered Catalogue \$ 15.00 CDN/USD			TOTAL FEES FOR THIS ENTRY: \$
Make Cheques Payable to SD & G Dog Association Entries Close: Tuesday JULY 29, 2014 at 8 pm			
Conformation		Rally (Limited Entry)	Obedience (Limited Entry)
<input type="checkbox"/> Baby Puppy (3-6 mos) <input type="checkbox"/> Bred By Exhibitor <input type="checkbox"/> Baby Sat & Sun ONLY <input type="checkbox"/> Jr. Puppy (6 - 9 mos) <input type="checkbox"/> Open <input type="checkbox"/> Sr. Puppy (9 - 12 mos) <input type="checkbox"/> Specials Only <input type="checkbox"/> 12 - 18 month <input type="checkbox"/> Brace (Sun Only) <input type="checkbox"/> Canadian Bred <input type="checkbox"/> Exhibition		Jump Heights <input type="checkbox"/> 6" <input type="checkbox"/> 8" <input type="checkbox"/> 12" <input type="checkbox"/> 16" <input type="checkbox"/> Novice A <input type="checkbox"/> Novice B <input type="checkbox"/> Advanced A <input type="checkbox"/> Advanced B <input type="checkbox"/> Excellent A <input type="checkbox"/> Excellent B	<input type="checkbox"/> Pre - Novice <input type="checkbox"/> Open A <input type="checkbox"/> Utility A <input type="checkbox"/> Novice A <input type="checkbox"/> Open B <input type="checkbox"/> Utility B <input type="checkbox"/> Novice B <input type="checkbox"/> Exhibition <input type="checkbox"/> Novice C <input type="checkbox"/> Intermediate Nov
BREED			SEX: <input type="checkbox"/> MALE OR <input type="checkbox"/> FEMALE
REGISTERED			
NAME OF DOG			
Check One & Enter Number Here		Date Of Birth: Please Circle Month	IS THIS A PUPPY?
<input type="checkbox"/> CKC Reg #		Jan Feb Mar Apr May June	<input type="checkbox"/> Yes or <input type="checkbox"/> No
<input type="checkbox"/> CKC PEN #		July Aug Sept Oct Nov Dec	PLACE OF BIRTH?
<input type="checkbox"/> CKC ERN #		Day _____ Year _____	
<input type="checkbox"/> CKC Misc Cert.#			
<input type="checkbox"/> CKC CCN.#			
<input type="checkbox"/> LISTED			
BREEDER(S)			
SIRE			
DAM			
REGISTERED OWNER(S)			
OWNER'S ADDRESS			
CITY	PROV/STATE	POSTAL CODE/ZIP	
NAME OF OWNERS AGENT (IF ANY) AT THE SHOW			
AGENT'S ADDRESS			
CITY	PROV/STATE	POSTAL CODE/ZIP	
Mail ID to: <input type="checkbox"/> OWNER Or <input type="checkbox"/> AGENT			
I certify that I am the registered Owner(s) of the dog or that I am the authorized agent of the Owner(s) whose name(s) I have entered above and accept full responsibility for all statements made in this entry. In Consideration of the acceptance of this entry, I (we) agree to be bound by the rules and regulations of the Canadian Kennel Club and any additional rules and regulations appearing in the premium list. Also, by signing this form I certify that I will not hold the Show giving Club, it's members, Directors, Employees, or Agents, liable in the event of any accident or misfortune however caused.			
Signature of Agent or Owner			Phone Number
a 15% + HST, charge applies on Credit Card Charges		Email address	
<input type="checkbox"/> VISA <input type="checkbox"/> MasterCard <input type="checkbox"/> AMEX		Expiry Date: Month > _____ Year > _____	
Card Number: _____ -- _____ -- _____			
Name of Card Holder: _____			
Fax # 519-351-3223	Mail To: COLMAR Show Service, 340 Mercer St, Chatham, ON, Canada N7M 6E1		
	Web Site: www.colmars.com		

All Fees are payable at time of entry. No entry will be processed or entered in this show without payment.
Listing fees are applicable for all dogs entered in the shows that do not have an individual CKC Reg. or an ERN number.

SPECIALTY SHOW
CANADIAN BLOODHOUND CLUB
Friday August 22, 2014

This National Specialty shall be dedicated to the memory of the
Bloodhound Club of Canada member and friend
Geneviève Richer.

Ce spéciaux nationale est dédié à la mémoire
de notre ami et collègue de la Bloodhound Club du Canada
Geneviève Richer.

CONFORMATION - Regular & Non-Regular Classes

Kaye McGhie, Brisbane, Queensland, Australia

PROUDLY SPONSORED BY



SWEEPSTAKES – All Sweepstakes Classes

Jean- Christophe Boulinguez, 7-154 Seigneuriale, Quebec, QC G1E 4Y6

OFFICERS

President.....	Heather Whitcomb	Vice-President	Tammy Arseneau
Treasurer	Veronica Mercer	Secretary	Debbie Blowatt
Show Chair	Jodie O'Meara		
Show Superintendent	Jodie O'Meara	Show Secretary ...	COLMAR Show Service

CLASSES - Divided by Sex

Regular Classes: Jr (6-9), Sr (9-12), (12-18), Cdn Bred, Bred By Ex, Open, Veteran,
Specials Only & Altered (spayed/neutered dogs allowed in Veterans class)

Non – Regular: Exhibition Only, Stud Dog, Brood Bitch, Brace.

TROPHIES AND ROSETTES

Through the generosity of Friends and Members of the Canadian Bloodhound Club a suitable Trophy &/or Rosettes will be offered Best of Breed, Best of Opposite, Best Puppy in Breed, Winners (Male & Female), Best of Winners, Reserve Winners (Male & Female), Best Veteran Male & Female, First in each Regular Class, Best Altered in breed, Best Opposite Altered, Best Stud Dog, Best Brood Bitch, Best Brace.

A suitable Trophy &/or Rosette will be offered to Highest Qualifying Score by an Bloodhound in the SD & G Obedience Trial(s) & Rally Trials, on the day of the specialty.

A Perpetual trophy will be awarded for the Best of Breed and will be retained by the Canadian Bloodhound Club.

Award Of Merit: One rosette will be offered for every ten dogs competing at Best of Breed level. Awards of merit will be presented at the discretion of the judge. (All Dogs Entering the ring to Compete for Best Of Breed will be counted).

SWEEPSTAKES

(All ages as of the day of the specialty)

Please Note: All Dogs entered in Sweepstakes must also be entered in one of the official classes at the specialty.

This specialty will include SWEEPSTAKES, VETERAN SWEEPSTAKES as follows:

All Regular Sweepstakes classes divided by sex – (Divided by Sex), 6 - 9 mos, 9 -12 mos, 12 -18 mos. 18 – 24 mos.

All Veteran Sweepstakes classes are to be divided by sex – 7 - 9 Years, 9 -11 Years, 11 years +..

PRIZES (Regular & Veteran) Prize money will be divided as follows:

Best in Sweepstakes	Rosette & 50% of entry fees.
Best of Opposite in Sweepstakes	Rosette & 25% of entry fees.
	25% will be retained by club for administration.

Social

Pizza, Auction Saturday after BIS.

Watch the club facebook page (or email us) for details.

For More information regarding this specialty
Contact – **Debbie Blowatt**, chevykid57@shaw.ca
or visit www.canadianbloodhoundclub.com

Bernese Mountain Dog Club of Canada

PROUDLY SPONSORED BY



Saturday, August 23, 2014



CONFORMATION - Regular & Non-Regular Classes

SWEEPSTAKES – All Sweepstakes Classes

SPECIALTY OBEEDIENCE (1) & RALLY (1) TRIAL (limited Entry)

ALL-BREED DRAFT TEST (Friday Aug 22, 2014) – **Separate Show Secretary Details Below**

SIEGER SHOW for Bernese Mountain Dogs (Fri Aug 22, 2014) **Separate Show Secretary Details Below**

JUDGES:

CONFORMATION: Karl-Erik Johansson, Grindtorpsvägen 27 4tr S-18349 TABY, **Sweden**

SWEEPSTAKES: Kathryn Young, 5866 Longhearth Way, Manotick, **ON K4M 1M1**

Specialty OBEEDIENCE/RALLY (LIMITED ENTRY)-

Sharlene Manderson, 100 tall Forest Dr., RR # 3 Carp, **ON KOA 1L0**

DRAFT: June Ward, Peggy Flockhart, and Rick Connell

SEIGER SHOW: Mylène Turbide

OFFICERS

President Maureen Greaves
 Treasurer Lesley Rouillier
 Show Chairperson Robin Camken
 Show Superintendent Jodie O'Meara

Vice-President..... Kim Doig
 Secretary Robert Buck
 Obedience/Rally Trial Chair Helen Rimmer
 Show Secretary..... COLMAR Show Service

CONFORMATION CLASSES - Divided by Sex

Regular Classes: Jr (6-9), Sr (9-12), 12-15, 15 - 18, Cdn Bred, Bred By Ex, Open, Veteran (Divided 7-9 yrs, 9-11 yrs, 11+ yrs), Specials Only, Exhibition Only, & Sexually Altered.

Non – Regular Classes: Stud Dog, Brood Bitch, Brace, Parade of Veterans.

OBEEDIENCE CLASSES (Limited Entry):

Pre – Novice, Novice A, B, C, Intermediate Novice, Open A & B, Utility A & B, Veteran, Brace

RALLY CLASSES (Limited Entry): Novice A & B, Advanced A & B, Excellent A & B.

TROPHIES AND ROSETTES

All trophies/awards must be picked up at the show. No trophies will be mailed.

Eukanuba will provide ring favours to all Bernese entered in Specialty Conformation, Rally & Obedience.

SPECIALTY CONFORMATION

\$100.00 for Best of Breed	\$50.00 for Winners Dog and Winners Bitch
\$80.00 for Best of Opposite,	\$40.00 for Reserve Winners Dog & Bitch
\$70.00 for Best of Winners, Best Veteran, Best Puppy	\$30.00 - 1st place all regular & non-regular class winners
\$60.00 for Select Dog, Select Bitch	\$40.00 for Sexually Altered Best of Breed
	\$30.00 for Sexually Altered Best of Opposite

Trophies: Thanks to the generosity of members and friends, the Bernese Mountain Dog Club of Canada is pleased to offer rosettes and cash prizes for the following placements:

Awards of Merit: One \$50.00 cash prize and rosette will be offered for every ten dogs competing at Best of Breed level. Awards of merit will be presented at the discretion of the judge after the awarding of Best of Breed, Best of Opposite Sex, Best of Winners, Select Dog and Select Bitch from the dogs remaining in the ring.

A rosette will be awarded to second through fourth place in each class in the Specialty.

A personalized Medallion will be awarded to each participant in the Parade of Veterans. The Bernese Mountain Dog Club of Ontario will also present a prize to each participant in the Parade of Veterans.

BMDCC PERPETUAL TROPHIES

Best of Breed - The San Marco Trophy Donated by Dave and Stephanie Patterson

Best Veteran in Sweeps - Swisskiss Memorial Trophy Donated by Madeline Knowles and Geoff Huber

Best Female in Sieger Show - The Angel Trophy Donated by Leslie and Leon Rouillier.

Youngest Dog to Qualify in Specialty Obedience - WiddleWascal Trophy Donated by Bill & Lisbeth Plant

SPECIALTY OBEEDIENCE & RALLY TRIALS

\$70 and a rosette for High in Trial (Obedience trial only)

\$30 and a rosette for all High in Class placements

A rosette and prize will be offered for a passing score in Pre-Novice Class.

Rosettes & Prizes will only be awarded for Qualifying Scores in both trials.

All qualifying scores will receive a rosette. A rosette will be awarded to second through fourth place in each class. All non-placing entrants in the Veteran Class will receive a participant's rosette.

AGILITY

One prize will be given to each Bernese that receives a Qualifying Score in Agility on the day of the Specialty

All trophies/awards must be picked up at the show. No trophies will be mailed.

For further information contact Helen Rimmer: 514-425-1044 or info@baergliberners.ca

SWEEPSTAKES

All Ages are as of the day of the Specialty.

Note: All Dogs entered in Sweepstakes must also be entered in one of the official classes at the specialty.
All **Regular Sweepstakes** classes divided by sex: 6 – 9, 9 -12, 12- 15, & 15 -18 mos,
All **Veteran Sweepstakes** classes are to be divided by sex: 7-9 yrs, 9 -11 yrs, 11 yrs +,

SWEEPSTAKES PRIZES

All Money prizes are based on entry fees collected for each class

1st Place in Class: 30% & Rosette, **2nd Place in Class:** 20% & rosette;

3rd Place in Class: 15% & rosette; **4th Place in Class:** 10% & rosette

Best in Sweeps: rosette &/or trophy; **Best of Opposite in Sweeps:** rosette &/or trophy

Balance of total entry fees: (25%) will be retained to cover administration and expenses.

Veteran Sweepstakes: Same as above. In addition,
a participant's rosette will be awarded to all participants in the Veterans Sweepstakes.

ALL BREED DRAFT TEST, DD, DDX & DD Brace. DDX BRACE AT THE SITE – Friday August 22, 2014

Judges; June Ward, Peggy Flockhart, and Rick Connell

More information and entry forms can be found on the website

of the Bernese Mountain Dog Club of Canada <http://www.bmdcc.ca>,

**or by contacting Denise Lauzon, at denise.lauzon@sympatico.ca or 613-259-5035
Send entries to Denise Lauzon, 350 Forbes Rd, RR # 3, Lanark, ON Canada K0G 1K0**

EUROPEAN STYLE SIEGER SHOW

For Bernese Mountain Dogs Only

Jointly sponsored by The Bernese Mountain Dog Clubs of Canada and Ontario

Friday August 22, 2014

Judge will be Bernese Mountain Dog breeder

Mylène Turbide (Alpenspirit BMD)

Dogs entered may be spayed or neutered.

All dogs entered will receive a written and oral

critique based on the CKC Standard for the Bernese Mountain Dog.

More information and entry forms can be found on the web sites

BMDCC www.bmdcc.ca or BMDCO www.bmdco.on.ca

Or by contacting Angela Wagenblast at 905-765-3518 or aakw@sympatico.ca

Send Entries to:

Robin Camken, 66 Landover Cres. Kanata, ON, K2M 2W4

For more information regarding this Specialty:

Contact: **Robin Camken**, rcamken@yahoo.ca 613-270-0880

Visit the 2014 Specialty Facebook Page

www.facebook.com/BMDCC2014BMDCO

HOST HOTEL - Best Western Parkway Inn

1515 Vincent Massey Drive, Cornwall, ON,

A set of rooms has been booked under Bernese Mountain Dog Clubs

Please phone the hotel directly to make reservations.

613-932-0451 to receive the Bernese Rate

This block will be held until July 21, 2014

At that time all unsold rooms will be released back to the hotel.

Specialty Banquet

A Specialty Banquet will be held at the Host Hotel on the night of Saturday August 23, 2014

See the BMDCC & BMDCO websites for banquet details

Contact Robin Camken rcamken@yahoo.ca for tickets

REGIONAL SPECIALTY SHOW - Outdoors
Bernese Mountain Dog Club of Ontario
Sunday August 24, 2014



CONFORMATION - Regular & Non-Regular Classes
SWEEPSTAKES – All Sweepstakes Classes
SPECIALTY OBEDIENCE (1) & RALLY (1) TRIAL (limited Entry)

JUDGES:

CONFORMATION: Michael Leonard, 196 Kimmage Rd., W, Dublin, **Ireland**

SWEEPSTAKES: Dawn Cox, 103 Valley View Dr., Hanover, **PA USA 17331**

Specialty OBEDIENCE/RALLY (LIMITED ENTRY)-

Michelle M. Armitage, 17 Sturbridge Pvt, Ottawa, **ON K1T 3J6**

OFFICERS

President	Jennifer Lennon	Vice-President.....	Deborah Webster
Treasurer.....	Robert Hume	Secretary.....	Irene Hume
Show Chairperson	Ian McKie	Obedience/Rally Trial Chair....	Sandra Graham
Show Superintendent	Jodie O'Meara	Show Secretary.....	COLMAR Show Service

CONFORMATION CLASSES - Divided by Sex

Regular Classes: Jr (6-9), Sr (9-12), 12-15, 15 - 18, Cdn Bred, Bred By Ex, Open, Veteran (Divided 7-9 yrs, 9-11 yrs, 11+ yrs), Specials Only, Exhibition Only, & Sexually Altered.

Non – Regular Classes: Stud Dog, Brood Bitch, Brace

OBEDIENCE CLASSES (Limited Entry):

Pre – Novice, Novice A, B, C, Intermediate Novice, Open A & B, Utility A & B, Veteran, Brace

RALLY CLASSES (Limited Entry): Novice A & B, Advanced A & B, Excellent A & B.

TROPHIES AND ROSETTES

All trophies/awards must be picked up at the show. No trophies will be mailed.

SPECIALTY CONFORMATION

Trophies: Thanks to the generosity of members and friends, the Bernese Mountain Dog Club of Ontario is pleased to offer rosettes and cash prizes for the following placements:

\$100.00 for Best of Breed

\$80.00 for Best of Opposite,

\$70.00 for Best of Winners, Best Veteran, Best Puppy

\$60.00 for Select Dog, Select Bitch

\$50.00 for Winners Dog and Winners Bitch

\$40.00 for Reserve Winners Dog and Reserve Winners Bitch

\$30.00 for 1st place in all regular and non-regular class winners

\$40.00 for Sexually Altered Best of Breed

\$30.00 for Sexually Altered Best of Opposite

Awards of Merit: One \$50.00 cash prize and rosette will be offered for every ten dogs competing at Best of Breed level. Awards of merit will be presented at the discretion of the judge after the awarding of Best of Breed, Best of Opposite Sex, Best of Winners, Select Dog and Select Bitch from the dogs remaining in the ring.

A rosette will be awarded to second through fourth place in each class in the Specialty.

Specialty Obedience & Rally Trials

\$70 and a rosette for High in Trial (Obedience trial only)

\$30 and a rosette for all High in Class placements

A rosette and prize will be offered for a passing score in Pre-Novice Class.

Rosettes & Prizes will only be awarded for Qualifying Scores in both trials.

All qualifying scores will receive a rosette. A rosette will be awarded to second through fourth place in each class. All non-placing entrants in the Veteran Class will receive a participant's rosette.

All trophies/awards must be picked up at the show. No trophies will be mailed.

AGILITY

One prize will be given to each Bernese that receives a Qualifying Score in Agility on the day of the Specialty

For further information contact Sandra Graham: 613-389-8856 or sg17@post.queensu.ca

SWEEPSTAKES

All Ages are as of the day of the Specialty.

Note: All Dogs entered in Sweepstakes must also be entered in one of the official classes at the specialty.
All **Regular Sweepstakes** classes divided by sex: 6 – 9, 9 -12, 12- 15, & 15 -18 mos,
All **Veteran Sweepstakes** classes are to be divided by sex: 7-9 yrs, 9 -11 yrs, 11 yrs +,

SWEEPSTAKES PRIZES

All Money prizes are based on entry fees collected for each class

1st Place in Class: 30% & Rosette, **2nd Place in Class:** 20% & rosette;

3rd Place in Class: 15% & rosette; **4th Place in Class:** 10% & rosette

Best in Sweeps: rosette &/or trophy; **Best of Opposite in Sweeps:** rosette &/or trophy

Balance of total entry fees: (25%) will be retained to cover administration and expenses.

Veteran Sweepstakes: Same as above. In addition,
a participant's rosette will be awarded to all participants in the Veterans Sweepstakes.

EUROPEAN STYLE SIEGER SHOW

For Bernese Mountain Dogs Only

Jointly sponsored by The Bernese Mountain Dog Clubs of Canada and Ontario

Friday August 22, 2014

Judge will be Bernese Mountain Dog breeder

Mylène Turbide (Alpenspirit BMD)

Dogs entered may be spayed or neutered.

All dogs entered will receive a written and oral
critique based on the CKC Standard for the Bernese Mountain Dog.

More information and entry forms can be found on the web sites

BMDCC www.bmdcc.ca or BMDCO www.bmdco.on.ca

Or by contacting Angela Wagenblast at 905-765-3518 or aakw@sympatico.ca

Send Entries to:

Robin Camken, 66 Landover Cres. Kanata, ON, K2M 2W4

For more information regarding this Specialty:

Contact: **Ian McKie**, ian.mckie2@sympatico.ca 613-839-5665

Visit the 2014 Specialty Facebook Page

www.facebook.com/BMDCC2014BMDCO

HOST HOTEL - Best Western Parkway Inn

1515 Vincent Massey Drive, Cornwall, ON,

A set of rooms has been booked under Bernese Mountain Dog Clubs

Please phone the hotel directly to make reservations.

613-932-0451 to receive the Bernese Rate

This block will be held until July 21, 2014

At that time all unsold rooms will be released back to the hotel.

Specialty Banquet

A Specialty Banquet will be held at the Host Hotel on the night of Saturday August 23, 2014

See the BMDCC & BMDCO websites for banquet details

Contact Robin Camken rcamken@yahoo.ca for tickets

NATIONAL SPECIALTY SHOW
Bouvier des Flandres Club of Canada
Saturday August 23, 2014

CONFORMATION - Regular & Non-Regular Classes

Michael Leonard, 196 Kimmage Rd., W, Dublin, Ireland

SWEEPSTAKES – All Sweepstakes Classes

Bonnie Bailey, 160 Desmond Road, Yarker, ON K0K 3N0

OFFICERS

President..... Serge Bilodeau
Vice-President..... Yvonne Savard
Secretary..... Bonnie Bailey
Treasurer..... Kathleen Bayfield-Pollock

Directors: Atlantic Region - Allison Capson, QUEBEC - Sophie Galland, ONTARIO - William Miller,
PRAIRIE - Tina Clifford, British Columbia - Janice Brind
Rescue coordinator -Pam Calver

Show Chair.....Jodie O'Meara
Show Superintendent.....Jodie O'Meara
Show Secretary COLMAR Show Service

Regular Classes - (divided by sex) – Baby Puppy (3-6 mos), Jr Puppy 6- 9 mos, Sr Puppy 9- 12
mos, 12 - 18 Month, Canadian Bred, Bred by Exhibitor, Open, Specials Only, Veterans.
& Sexually Altered Class

Non-Regular Classes - Exhibition Only, Brace, Stud Dog, Brood Bitch

TROPHIES AND ROSETTES

Through the generosity of Sponsors, Friends and Members of Bouvier des Flandres Club of Canada, a suitable Trophy or Prize &/or Rosette or Ribbon will be offered for Best of Breed, Best of Opposite, Best of Winners, Select Dog, Select Bitch, Best Puppy in Breed, Winners (Male & Female), Reserve Winners (Male & Female), Veterans (Male &Female) , Best Veteran , Altered (Male &Female), Best Altered in Breed, Best Brace, Best Stud Dog, Best Brood Bitch, Best Baby in Breed.

Award Of Merit: One rosette and/or Trophy/Prize will be offered for every ten dogs competing at Best of Breed level, awards of merit will be presented at the discretion of the judge.

(All Dogs Entering the ring to Compete for Best Of Breed will be counted).

AGILITY: One prize will be given to each Bouvier des Flandres that receives a Qualifying Score in Agility on Sunday August 24.

Obedience & Rally Obedience: A prize and a rosette will be awarded to the highest scoring Bouvier des Flandres, Sunday, Trial #5.

A prize will be offered to the Highest Score Combined Novice A & B, Open A & B, Utility (Trial#5)

A prize will be offered to the highest scoring Bouvier des Flandres in Rally-Obedience (Trial#5)

Sweepstakes (All ages as of day of specialty)

All Dogs entered in Sweepstakes must also be entered in one of the regular classes at the specialty.

This specialty will include Regular and Veteran Sweepstakes as follows:

Sweepstakes classes (divided by sex) – 3-6 mos, 6 - 9 Mos, 9 -12 Mos,& 12 -18 Mos,

Veteran Sweepstakes (divided by sex) – 7 - 9 yrs, 9 -11 yrs & 11 yrs & over

Prizes: SWEEPSTAKES & VETERAN SWEEPSTAKES

Best in Sweepstakes50% of entry money

Best of Opposite in Sweepstakes 25% of entry money

25% will be retained by SD & G DA for administration.

Rosettes and/or prizes will be awarded for

Best in Sweepstakes and Best of Opposite in Sweepstakes

For More information
Serge Bilodeau at boyero@distributel.net

Please Check Each Specialty For The classes that are offered

<input type="checkbox"/> Canadian Bloodhound Club - National - Friday Aug 22/14		SD & G Specialties	Armband #
<input type="checkbox"/> Bouvier des Flandres CC - National - Sat August 24 /14		<input type="checkbox"/> Bernese MTN Dog CO - Regional - Sunday Aug 24/14	
<input type="checkbox"/> Bernese MTN Dog CC - National - Saturday Aug 23/14		<input type="checkbox"/> Ottawa Valley Pointing Dog Club -Sunday August 24/13	
<input type="checkbox"/> Ottawa Valley All Setter Association- Saturday Aug 23/14		<input type="checkbox"/> Std Schnauzer Club of Can - Sunday August 24, 2013	
<input type="checkbox"/> Pointer Club of Canada National - Sat August 24, 2014		<input type="checkbox"/> Miniature Schnauzer – RTC -Sunday, August 24, 2013	
<input type="checkbox"/> Rideau Terrier Club - Group 4 Specialty- Sat Aug 23/14		<input type="checkbox"/> Wire Fox Terrier Club of Can -Sunday, August 24 / 14	
Price List - Entry Fee: \$ 30.00 CDN/USD Listing Fee: \$ 9.70 & Baby Puppy No Listing Fee Other Fees: Exhibition, Sweepstakes, Non Regular, \$15.00 CDN/USD			
PRE - ORDERED CATALOGUES - <input type="checkbox"/> ALL BREED \$ 10.00 CDN/USD			
Cheques Payable to SD & G Dog Association		Entries Close: Tuesday July 30, 2013 at 8pm	
CONFORMATION (Please Check Each Individual Specialty For Classes Offered)			
<input type="checkbox"/> BABY. Puppy (3-6 mth)		<input type="checkbox"/> 12 - 18 months	<input type="checkbox"/> Canadian Bred
<input type="checkbox"/> JR. Puppy (6 – 9 mth)		<input type="checkbox"/> 12 - 15 months	<input type="checkbox"/> Open
<input type="checkbox"/> SR. Puppy (9 – 12 mth)		<input type="checkbox"/> 15 - 18 months	<input type="checkbox"/> Veteran
		<input type="checkbox"/> Bred By Exhibitor	<input type="checkbox"/> Specials Only
		<input type="checkbox"/> Sexually Altered	
SWEEPSTAKES (Please Check Each Individual Specialty For Classes Offered)			
<input type="checkbox"/> 3-6 MOS		<input type="checkbox"/> 9 - 12 MOS	<input type="checkbox"/> 15-18 MOS
<input type="checkbox"/> 6 - 9 MOS		<input type="checkbox"/> 12-15 MOS	<input type="checkbox"/> 12-18 MOS
		<input type="checkbox"/> 18 - 24 MOS	<input type="checkbox"/> 7-9 years
			<input type="checkbox"/> 9 years +
			<input type="checkbox"/> 10 years +
			<input type="checkbox"/> 11-12 years
			<input type="checkbox"/> 13 years +
			<input type="checkbox"/> 11 years +
			<input type="checkbox"/> 3 Generation Sweepstakes
SPECIALTY OBEDIENCE (Please Check Each Individual Specialty For Classes Offered)			
<input type="checkbox"/> Pre- Novice		<input type="checkbox"/> Novice A	<input type="checkbox"/> Novice B
<input type="checkbox"/> Novice A		<input type="checkbox"/> Novice B	<input type="checkbox"/> Novice C
<input type="checkbox"/> Intermediate Novice		<input type="checkbox"/> Open A	<input type="checkbox"/> Open B
		<input type="checkbox"/> Utility A	<input type="checkbox"/> Utility B
		JUMP HEIGHTS Height - Width -	
SPECIALTY RALLY (Please Check Each Individual Specialty For Classes Offered)			
<input type="checkbox"/> Novice A		<input type="checkbox"/> Novice B	<input type="checkbox"/> Advanced A
<input type="checkbox"/> Novice B		<input type="checkbox"/> Advanced A	<input type="checkbox"/> Advanced B
<input type="checkbox"/> Advanced A		<input type="checkbox"/> Advanced B	<input type="checkbox"/> Excellent A
<input type="checkbox"/> Advanced B		<input type="checkbox"/> Excellent A	<input type="checkbox"/> Excellent B
<input type="checkbox"/> Excellent A		<input type="checkbox"/> Excellent B	<input type="checkbox"/> 6" <input type="checkbox"/> 8" <input type="checkbox"/> 12" <input type="checkbox"/> 16"
NON REGULAR CLASSES (Please Check Each Individual Specialty For Classes Offered)			
<input type="checkbox"/> Exhibition Only		<input type="checkbox"/> Brace	<input type="checkbox"/> Brood Bitch
<input type="checkbox"/> Brace		<input type="checkbox"/> Brood Bitch	<input type="checkbox"/> Stud Dog
<input type="checkbox"/> Brood Bitch		<input type="checkbox"/> Stud Dog	<input type="checkbox"/> Parade of Veterans
<input type="checkbox"/> Stud Dog		<input type="checkbox"/> Parade of Veterans	<input type="checkbox"/> Parade of Titleholders
<input type="checkbox"/> Parade of Veterans		<input type="checkbox"/> Parade of Titleholders	
<input type="checkbox"/> Parade of Titleholders			
<input type="checkbox"/> Field Dog		<input type="checkbox"/> TEAM	ANY OTHER CLASS NOT LISTED <input type="checkbox"/>
BREED		<input type="checkbox"/> Short - Haired	SEX: <input type="checkbox"/> MALE OR <input type="checkbox"/> FEMALE
		<input type="checkbox"/> Long - Haired	
REGISTERED NAME OF DOG			
Check One & Enter Number Here		IS THIS A PUPPY?	
<input type="checkbox"/> CKC Reg #		<input type="checkbox"/> Yes or <input type="checkbox"/> No	
<input type="checkbox"/> CKC PEN #		PLACE OF BIRTH?	
<input type="checkbox"/> CKC ERN #		<input type="checkbox"/> Canada	
<input type="checkbox"/> CKC Misc Cert.#		<input type="checkbox"/> Elsewhere	
<input type="checkbox"/> CKC CCN.#			
<input type="checkbox"/> LISTED			
BREEDER(S)			
SIRE			
DAM			
REGISTERED OWNER(S)			
OWNER'S ADDRESS			
CITY	PROV/STATE	POSTAL CODE/ZIP	
NAME OF OWNERS AGENT (IF ANY) AT THE SHOW			
AGENT'S ADDRESS			
CITY	PROV/STATE	POSTAL CODE/ZIP	
Mail ID to: <input type="checkbox"/> OWNER Or <input type="checkbox"/> AGENT			
<small>I certify that I am the registered Owner(s) of the dog or that I am the authorized agent of the Owner(s) whose name(s) I have entered above and accept full responsibility for all statements made in this entry. In consideration of the acceptance of this entry, I (we) agree to be bound by the rules and regulations of the Canadian Kennel Club and any additional rules and regulations appearing in the premium list. Also, by signing this form I certify that I will not hold the Show giving Club, it's members, Directors, Employees, or Agents, liable in the event of any accident or misfortune however caused.</small>			
Signature of Agent or Owner		Phone Number	Email address
a 15% + HST, charge applies on all Credit Card Charges			
<input type="checkbox"/> VISA <input type="checkbox"/> MasterCard <input type="checkbox"/> AMEX		Expiry Date: Month > _____ Year > _____	
Card Number: _____ - _____ - _____ - _____			
Name of Card Holder: _____			
Fax # 519-351-3223		Mail To: COLMAR Show Service, 340 Mercer St, Chatham, ON, Canada N7M 6E1	

All Fees are payable at time of entry. No entry will be processed or entered in this show without payment.

SPECIALTY SHOW for ALL Setters (English, Gordon, Irish and Irish Red & White)

OTTAWA VALLEY ALL SETTER ASSOCIATION

PROUDLY SPONSORED BY Thirty-Ninth Annual Specialty Show



Saturday, August 23, 2014

CONFORMATION - Regular & Non-Regular Classes

Michael Leonard, 196 Kimmage Rd., W, Dublin, Ireland

SWEEPSTAKES All Classes –

Helene Viaud, 826 Avenue, Ste.-Therese, QC G1B 1E4



OFFICERS

President – Alistair Sutherland Vice-President – Marie Tinlin Treasurer- Deborah Cook
Secretary – Patrick Hunt Membership – Debbie Cook Rescue - Patrick & Vicky Hunt
Directors – Tina Cockram, Mary Lou Levesque, Bonnie Whitten
Show Chair - Wendy Watson wwbirdie1@gmail.com,
Show Superintendent - Jodie O'Meara Show Secretary - COLMAR Show Service

CLASSES - Divided by Sex Regular Classes: Jr (6-9), Sr (9-12), (12-18), CDN Bred, Bred By Ex, Open, Veteran, Specials Only. (Please Note Spayed/Neutered dogs may participate in the Veteran class)

Non – Regular Classes: Exhibition Only, Stud Dog, Brood Bitch, Brace . All Setter breeds combined. **Field Dog**, must have one leg towards Field Title & all Setter Breeds & sexes combined Entries in these classes may be spayed or neutered & must be entered in any OVASA Specialty class or Exhibition Only. Judging of these Non-Regular Classes will be held immediately after Best of Breed of the Last Setter Breed

Unofficial Classes: Best Setter in Multiple Breed Specialty (Best Setter in each breed to compete), Best Setter Puppy in Multiple Breed Specialty (Best Setter Puppy in each breed to compete), Best Setter Veteran in Multiple Breed Specialty (1st place Veteran Dog and 1st place Veteran Bitch in each breed to complete. There will be no Best Veteran Award at Breed Level). Best Setter Field Dog in Multiple Breed Specialty

Parade of Rescue Dogs: For Setter Dogs/ Bitches placed in a new home by the Rescue System

No fee and no registration number required. May be spayed or neutered. Non-competitive.

TROPHIES AND ROSETTES

Through the kindness and generosity of its members and friends, OVASA is pleased to offer the following: Rosettes for 1st to 4th place for All Official Classes. Trophies and Rosettes will be awarded for Best of Breed, Best of Opposite Sex, Best Puppy, Best of Winners (Rosette only), Winners Dog, Winners Bitch, Reserve Winners Dog, Reserve Winners Bitch, Veteran Dog, Veteran Bitch, For all Combined Breeds – Best Setter in Multiple Breed Specialty, Best Setter Puppy in Multiple Breed Specialty, Best Setter Veteran in Multiple Breed Specialty, Select Dog & Bitch (At Judges discretion) Rosette Only. Best Setter Field Dog in Multiple Breed Specialty. Stud Dog, Brood Bitch, Brace, Rosette only.

Obedience - Highest qualifying score by a setter on each Day. with Host Club Obedience Trials Rosette only

Rally - Highest qualifying score by a setter on each Day with Host Club Rally Obedience Trials Rosette only

Agility - Highest cumulative daily score by a setter on each of Day. with Host Club Trials Rosette only

Field Test- Highest Qualifying Score by a setter on the Tue with the OVADC Field Test. Rosette only

Perpetual Trophies

The following perpetual trophies will be awarded but will remain with the hosting club:

The Killane Rogue Memorial Trophy, Best Setter in Specialty - Donated by the late John & Muriel Royston.

The Spruce Trophy, BOB – English Setter –Donated by Joan Detmold

The Gunnstalk Trophy, BOB – Gordon Setter –Donated by Sandy Gunn

The Bryjade Trophy, BOB – Irish Setter –Donated by Don & Janice Craig

The Irish R & W Setter Trophy, BOB – Irish R & W Setter –Donated by the Irish R & W Setter Club of Canada

The Gus Polley Memorial Trophy, Best Puppy in Spec. – Donated by Tina Cockram ,Lori Stewart, Jill Taylor

The Horace S. Hollands Memorial Trophy, Best Puppy in Sweeps - Donated by the Late Mrs. Anne Snelling

The Veteran Sweepstakes Trophy, Best Veteran in Sweeps –Donated by Len & Cheryl Walker

SWEEPSTAKES

Please Note: Sweepstakes entries must be entered in one of the official classes or Exhibition only at the specialty.

This specialty will include Sweepstakes, Veteran Sweepstakes as follows: for All Setter Breeds

All Regular Sweepstakes classes NOT divided by sex - 6 - 9 mos, 9 -12 mos, 12 – 15 mos & 15 -18 Mos.

All Veteran Sweepstakes classes NOT divided by sex - 7-10 yrs, 10 yrs and over, as of the day of the specialty.

Prizes: SWEEPSTAKES & VETERAN SWEEPSTAKES

Rosettes 1st to 4th place in each class. - A rosette will be offered to the Best in Sweepstakes.

Prize money: 75% of the entry money received will be divided by the total number of entries and awarded to the winner of each of the classes based on the number of dogs entered in that class.

No additional money will be awarded to the Best in Sweepstakes.

Balance of 25% will be retained for Administration.

For More information regarding the OVASA Specialty

Wendy Watson - wwbirdie1@gmail.com

NATIONAL SPECIALTY SATURDAY AUGUST 23, 2014



CONFORMATION - Regular & Non-Regular Classes

Peggy Beisel-McIlwaine,

6225 N MAPLE RD., ANN ARBOR, MI USA 48105-8901

SWEEPSTAKES – All Sweepstakes Classes

Bea Sawka

OFFICERS

President..... Jo Griffith
Secretary Rhonda Ace
Show Chair Jo Griffith

Vice-President..... Genevieve Munro
Treasurer..... Wally Ace

Directors

BC – Heidi Gervais, **Prairies** – Barb Bigelow,
Ontario – Rhonda Ace, **Maritimes** – Danik Dancause

Show Superintendent..... Jody O'Meara
Show Secretary..... COLMAR Show Service

CLASSES - Divided by Sex

Regular Classes: Jr (6-9), Sr (9-12), (12-18), Cdn Bred, Bred By Ex, Open, Veteran, Specials Only
& Altered (spayed/neutered dogs allowed in Veterans class)

Non – Regular: Exhibition Only, Stud Dog, Brood Bitch, Brace,
Field Dog Class (Dogs that have earned a qualifying score at a CKC Hunt Test or
Field Trial, or dogs that have earned a qualifying score at a AKC Hunt Test or Field Trial)

SWEEPSTAKES

Please Note: All Dogs entered in Sweepstakes must also be entered
in one of the official classes at the specialty.

This specialty will include SWEEPSTAKES, VETERAN SWEEPSTAKES as follows:

All Regular Sweepstakes classes divided by sex –

6 - 9 Mos, 9 -12 Mos, & 12 -18 Mos, as of the day of the specialty.

All Veteran Sweepstakes classes are to be divided by sex –

7-9 yrs, 9 to 11 yrs, 11 yrs +, as of the day of the specialty.

PRIZES (Regular & Veteran)

Prize money will be divided as follows:

Best in SweepstakesTrophy, Rosette & 35% of entry fees.

Best of Opposite in Sweepstakes Trophy, Rosette & 25% of entry fees.

First in each classRosette & 5% of entry fees

25% will be retained by club for administration.

Rosettes and prizes will be awarded for Best in Sweepstakes and Best of Opposite in Sweepstakes

TROPHIES & PRIZES

Through the generosity of its, members and friends the Pointer Club of Canada will offer suitable prizes and rosettes, for the following awards: Best Of Breed, Best Of Opposite, Sex, Best Of Winners, Winners Dog, Winners Bitch, Reserve Winners Dog, Reserve Winners Bitch, Best Veteran Male And Female, Best Puppy, Best Of Breed Altered, Best Of Opposite Sex Altered, ,Brace, Stud Dog , Brood Bitch, Field Dog, Canadian Bred, Rosettes will be awarded for the placements in each class.

AWARD OF MERIT (rosette) may also be presented at the, judge's discretion (at the rate of 1 Award/10 dogs in Best of Breed, competition. All prizes must be claimed at the show

Social

To Be Announced

Rideau Terrier Club Saturday, August 23, 2014
44th ANNUAL SPECIALTY SHOW - for All Breeds in Group 4

**THE RIDEAU TERRIER CLUB DEDICATES OUR 2014 SHOW
 To SQUIBS MERCIER**

In Honour Of Her Wonderful Spirit and Dedication To The Sport

Judge CONFORMATION - Regular Non-Regular Classes

Kenneth M. McDermott, 110 Valley View Dr., Newburgh, NY USA 12550-8914

Judge SWEEPSTAKES – All Sweepstakes Classes

Kelly Wood, 35 Glasgow St. S., Conestoga, ON N0B 1N0



Regular Classes - Divided by Sex (Spayed/neutered dogs may be entered in Veteran class)

Baby Puppy (3-6 mos), Jr (6-9), Sr (9-12), 12 to 18 mos, Canadian Bred, Bred By Exhibitor, Open, Veteran, Specials Only, & Altered.

Non – Regular Classes: Exhibition Only, Brace & Team

The Rideau Terrier Club's BREED OF DISTINCTION FOR 2014

Bull Terrier & Bull Terrier (Miniature)

CLUB OFFICERS

President Karen Nesbitt
 Vice-President Anita Roy
 Treasurer Squibs Mercier
 Secretary Laura Grieveson

SHOW COMMITTEE

Hon. Show Chair Marion Fleming
 Show Chair Linda Bergh
 Trophy Chair Mike Sullivan
 Hospitality Linda and Jim Mabey
 Hon. Ring Steward ... Chris Raine

Show Superintendent Jodie O'Meara Show Secretary - COLMAR Show Service

**The Rideau Terrier Club will donate \$1 per entry in the Specialty
 towards the fight against Breed Specific Legislation**

\$50.00 Armband Draw – Donated by Belle Severn

AWARDS

All donors to the Trophy Fund will be listed in the Official Show Catalogue

The Rideau Terrier Club retains its perpetual trophies; keeper prizes are offered to the winners
 Best In Specialty – Betty Hyslop Memorial Trophy
 Best Puppy in Specialty – Fred Fraser Memorial Trophy
 Best Cdn.-bred in Specialty – Ch Redletter Miss Splinter's Memorial Trophy
 Best Bred-by-Exhibitor in Specialty (Chosen from the Bred By Class) - Frances Atkins Memorial Trophy
 Best Altered Dog in Specialty – Morgan Wueri Trophy
 Best Veteran in Specialty – Staffhaven Trophy
 Best Canadian-bred in Sweepstakes – Audrey Faibish Memorial Trophy
 Best of Breed - Cairn Terrier, Cairndania Commemorative Trophy
 Roger Orr Memorial Trophy – Best Miniature Schnauzer Puppy in Bred

Through the kindness of the Cairn Terrier Breeders and Owners the following prizes will be awarded for Cairn Terriers, Winners Dog & Bitch, Best of Winners, Best of Opp. Sex and Best of Breed & Best Puppy

Rideau Terrier Club Prizes & Rosettes – Breed level – Best of Breed, Best of Opposite Sex, Best Puppy
Prizes & Rosettes – Group level – Best in Specialty, & Group 2ND, 3RD, 4TH, Best Canadian Bred, Best Puppy, Best Bred-by-Exhibitor, Best Veteran, Best Altered

SWEEPSTAKES

(All Dogs entered in Sweepstakes must also be entered in one of the Regular Classes at the Specialty.)
 Classes are divided by sex – Junior 6-9 mos., Senior 9-12 mos., & 12-18 mos. on the day of the Specialty.
 Prizes in each class – 1ST – 25%; 2ND – 20%, 3RD – 15%, 4TH – 15% of entry fees received for that class.
 Best in Sweeps – rosette Best of Opposite Sex in Sweeps –rosette
 Best Canadian Bred in Sweeps – (Perpetual Trophy), a prize and rosette
 Flat ribbons will be awarded for 1ST through 4TH place in each class.
 Balance of 25% will be retained by the Rideau Terrier Club

For More information Contact - Linda Bergh lindabergh21@hotmail.com

Ottawa Valley Pointing Dog Club

SPECIALTY SHOW for

Kleiner Munsterlander Vorstehhund, Braque Français, Wire-Haired Pointing Griffon, Pointer, Pointer (GLH, GSH, GWH), Pudelpointer, Setter (Irish, English, Gordon, Irish R & W), Spaniel (Blue Picardy, Brittany, French), Spinone Italiano, Vizsla (SM & WH), Weimaraner

Sunday, August 24, 2014



CONFORMATION - Regular & Non-Regular Classes

Kaye McGhie, Brisbane, Queensland, **Australia** **PROUDLY SPONSORED BY**

SWEEPSTAKES – All Sweepstakes Classes



Linda St-Hilaire, 6700-300 Boul. Pierre-Bertrand, QC G2J 0B4

OFFICERS

President.....	Kevin MacWilliams	Vice-President.....	Linda Cooney
Treasurer.....	Deborah Cook	Secretary	Gail Docherty
Field Director	Kevin MacWilliams	Hospitality	OVPDC Members
Show Chair.....	Deborah Cook		
Show Superintendent.....	Jodie O'Meara	Show Secretary....	COLMAR Show Service

CLASSES - Divided by Sex

Regular Classes: Junior (6-9), Senior (9-12), (12-18), Canadian Bred, Bred By Exhibitor, Open, Veteran, Specials Only.

Non – Regular Classes: Exhibition Only, Field Dog*.

*Entries in Field Class may be spayed or neutered & must be entered in any OVPDC Specialty class or Exhibition Only

***The Field Dog class will be judged after Best of Breed for each breed**

TROPHIES AND ROSETTES

The following Ribbons, Rosettes and Trophies have been made possible by the generosity of members and friends of the Ottawa Valley Pointing Dog Club and by Eukanuba:

Ribbons will be awarded 1st thru 4th Place and to Winners Dog & Bitch in all Regular Classes

Rosettes will be awarded:

- In each breed for Best of Breed; Best of Opposite Sex; Best of Winners, Best Veteran, Best Puppy; and Best Field Dog
- To Best in Multiple Breed Specialty (MBS); Best Puppy in MBS; Best Veteran in MBS; Best Field Dog in MBS
- Highest qualifying score in Obedience by a pointing breed, on each of Saturday and Sunday with host club obedience trials
- Highest qualifying score in Rally by a pointing breed, on each of Saturday and Sunday with host club obedience trials
- Highest cumulative daily score in agility by a pointing breed, on each of Saturday and Sunday at host club agility trials

Trophies will be awarded:

To Best in Multiple Breed Specialty (MBS); Best Puppy in MBS; Best Veteran in MBS; Best Field Dog in MBS; Best of Breed; Best Field Dog in Breed; Highest qualifying score in Obedience, by a pointing breed during 2 days (Saturday/Sunday); Highest qualifying score in Rally, by a pointing breed during 2 days (Saturday/Sunday); Highest qualifying score in obedience, by a German Short-Haired Pointer during 2 days (Saturday/Sunday); Highest Cumulative 2 day (Saturday/Sunday) Score in agility, by a pointing breed.

Three Ottawa Valley Pointing Dog Club Versatility Awards.

- (1) Open to all Pointing Breeds (must not be entered in CKC field test)
- (2) Open to all German Short-Haired Pointers (must be entered in CKC field test)
- (3) Open to all Pointing Breeds (must be entered in CKC field test)

(Continued on next page.....)

(.....Continued from the previous page)

Perpetual Trophies and Awards

The following perpetual trophies will be awarded but will remain with the hosting club:

- Best in Multiple-Breed Specialty
- Best Puppy in Multiple-Breed Specialty
- Best Veteran in Multiple-Breed Specialty
- Best Field Dog in Multiple-Breed Specialty
- Best in Sweepstakes – Puppy and Veteran
- Highest Qualifying Score in Obedience (all Pointing Breeds competing)
- Highest Qualifying Score for a German Short-Haired Pointer in Obedience
- Highest Qualifying Score in Rally (All Pointing Breeds Competing)
- Highest Cumulative Score in Agility (all Pointing Breeds competing)
- Highest Qualifying Score in the Hunt Test (all Pointing Breeds competing)
- The OVPD Club Versatility Award (All Pointing Breeds Competing)
- The OVPD Club Versatility Award (German Short-Haired Pointer)
- The OVPD Club Versatility Award – Field- (all Pointing Breeds competing)

Unofficial classes

- Best Field Dog in Breed*
 - Best-in-Multiple Breed Specialty (Best in each breed to compete)
 - Best Puppy in Multiple Breed Specialty (Best Puppy in each breed to compete)
 - Best Veteran in Multiple Breed Specialty (Best Veteran in each breed to compete)
 - Best Field Dog in Multiple Breed Specialty (Best Field Dog in each breed to compete)
- * Must have at least 1 confirmed qualifying score in a CKC or AKC hunting event, and must also enter Regular Specialty Classes or Exhibition Only (Veteran & Exhibition entries may be spayed/neutered)

Sweepstakes

- Sweepstakes* – Not divided by Sex or Breed, (6 to 9 months, 9 to 12 months, 12-18 months)
- Veterans* Sweepstakes - Not divided by Sex or Breed, (7-10 years, over 10 years)
- (Veterans may be spayed or Neutered)
- Breeds & sexes will be judged together

* Must also enter Regular Specialty Classes or Exhibition Only

Prizes for Sweepstakes and Veteran Sweepstakes: Prize money to be divided as follows:
75% of the entry money received will be divided by the total number of entries and awarded to the winner of each of the classes based on the number of dogs entered in that class.

- No additional money will be awarded to the Best in Sweepstakes.
- The remaining 25% of the entry fee will be retained to defray expenses.
- Best in Sweepstakes, & Best Veteran in Veteran Sweepstakes

Special Events

All OVPDC members, friends and exhibitors are invited to ringside for refreshments on the day of the specialty.

- Booster: (All Pointing Breeds) Saturday, August 23, 2014
- Obedience Competition (Friday, Saturday & Sunday, with Host Show)
- Rally Competition (Friday, Saturday & Sunday, with Host Show)
- Agility Competition (Friday, Saturday & Sunday with Host Show)
- CKC Field Test nearby (Tuesday August 26, 2014)

3 OVPDC Versatility Awards - (awarded at Field event Tuesday August 26, 2014)

Junior Handling

JUNIOR HANDLING will be offered – Judge: TBA, Time during the lunch break
All Juniors should register with the Show Secretary
one hour before competition.

Flats for 1st to 4th in each class, and a Rosette & Prize for Best Junior Handler & Reserve Junior Handler overall Junior Handlers - each 1st place winner will receive a prize from “Eukanuba”



Please visit www.ovpdc.org

PROUDLY SPONSORED BY



SPECIALTY SHOW
FOR MINIATURE SCHNAUZERS ONLY
 Sponsored by Rideau Terrier Club - Sunday, August 24, 2014

CONFORMATION - Regular Non-Regular Classes

Peggy Beisel-McIlwaine,

6225 N MAPLE RD., ANN ARBOR, MI USA 48105-8901

CLUB OFFICERS

President Karen Nesbitt
 Vice-President Anita Roy
 Treasurer Squibs Mercier
 Secretary Laura Grieveson

SHOW COMMITTEE

Show Chair Jodie O'Meara
 Show Superintendent Jodie O'Meara
 Show Secretary - COLMAR Show Service

Regular Classes - Divided by Sex (Spayed/neutered dogs may be entered in Veteran class)

Jr (6-9), Sr (9-12), 12 to 18 months, Canadian Bred, Bred By Exhibitor, Open, Veteran, Specials Only.

Non – Regular Classes: Exhibition Only,

AWARDS

Prize &/or Rosette for Best of Breed,
 Rosettes will be awarded to, Best of Opposite, Best Puppy, Best Veteran
 Winners Dog, and Bitch, Best of Winners, Reserve Winners Dog, and Bitch.

Perpetual Trophy

“The Rideau Terrier Club Miniature Schnauzer Memorial Trophy”
 awarded to Best in Specialty

For More information Contact - Karen Nesbitt - knesbitt@kos.net

NATIONAL SPECIALTY SHOW
WIRE FOX TERRIER CLUB OF CANADA

Sunday, August 24, 2014

CONFORMATION - Regular Non-Regular Classes

Peggy Beisel-McIlwaine,

6225 N MAPLE RD., ANN ARBOR, MI USA 48105-8901



CLUB OFFICERS

President..... Barbara Watt
 Vice-President Darle Heck
 Treasurer/Secretary Elizabeth Campbell

SHOW COMMITTEE

Show Chair Jodie O'Meara
 Show Superintendent Jodie O'Meara
 Show Secretary - COLMAR Show Service

Directors; BC- Alexis Davidson, **Prairies** - Judy McVeigh,
ON – Linda Mazurkiewicz, **Maritimes** – Verena Matthew

Regular Classes - Divided by Sex (Spayed/neutered dogs may be entered in Veteran class)

Jr (6-9), Sr (9-12), 12 to 18 months, Canadian Bred, Bred By Exhibitor, Open, Veteran, Specials Only.

Non – Regular Classes: Exhibition Only,

AWARDS

Prize & Rosette for Best of Breed, Best of Opposite, & Best Veteran Rosettes will be awarded to,
 Best Puppy, Winners Dog, and Bitch, Best of Winners, Reserve Winners Dog, and Bitch.

Perpetual Trophies

Best of Breed Marksman Trophy	Winners Bitch Elfie Erzberger Memorial Trophy
Best of Winners Hugh Brown Memorial Trophy	Winners Dog Kathy Ferguson Memorial Trophy
	Best Puppy Dimminsdale Trophy

Wire Fox Terrier Club of Canada retains the perpetual trophies stated;
 keeper prizes are offered to winners.

For More information Contact Linda Mazurkiewicz
 Ontario Director WFTCC linner56@hotmail.com

National SPECIALTY SHOW
Standard Schnauzer Club of Canada
Saturday August 23, 2014



JUDGES

CONFORMATION - Regular & Non-Regular Classes

Peggy Beisel-McIlwaine,

6225 N MAPLE RD., ANN ARBOR, MI USA 48105-8901

OFFICERS

President	Line Champagne	Vice-President.....	Heather Pedersen
Treasurer.....	Eleanor Symons	Secretary	Michelle Ross
Prairies – Andrea Knibbs & Jill Fraser, Ontario – Mary Davies, Judith Gooch, Karen Pare,			
Quebec – Lyne Labonte, Maritimes – Line Champagne			
Show Superintendent	Dennis Arrand	Show Secretary	COLMAR Show Service

CLASSES - Divided by Sex

Regular Classes: Junior (6-9), Senior (9-12), (12-18), Canadian Bred, Bred By Exhibitor, Open, Veteran, Specials Only,

Non Regular Classes: Brace, Stud Dog, Brood Bitch. and Exhibition only.

TROPHIES AND ROSETTES

Trophies and/or Rosettes are offered by the members Standard Schnauzer Club of Canada for Best Of Breed, Best Of Opposite Sex, Best Puppy In Breed, Best Canadian Bred in specialty, Best Of Winners, Winners Dog, Winners Bitch, Reserve Winners Dog, Reserve Winners Bitch, & First in each class. Rosettes will be awarded for all placements in the regular classes.

Award Of Merit: *One rosette will be offered for every ten dogs competing at Best of Breed level, awards of merit will be presented at the discretion of the judge.*

A Trophy and Rosette will be awarded for the Highest Qualifying scoring Standard Schnauzer of the day in the SD & G, Rally, Obedience, & Agility Trials on the day of the specialty.

Junior Handling

Trophy & Rosette will be awarded for Best Overall Junior Handler. Rosettes awarded for 1st in each class

BBQ
Saturday Night

For more information
about the Standard Schnauzer Club of Canada Specialty,
contact

Karen Pare, karenpare@xplornet.com 613-359-9975

or

Michelle Ross, tealwoodss@gmail.com 905-854-1966

Please Check Each Specialty For The classes that are offered

<input type="checkbox"/> Canadian Bloodhound Club - National - Friday Aug 22/14		SD & G Specialties	Armband #
<input type="checkbox"/> Bouvier des Flandres CC - National - Sat August 24 /14		<input type="checkbox"/> Bernese MTN Dog CO - Regional - Sunday Aug 24/14	
<input type="checkbox"/> Bernese MTN Dog CC - National - Saturday Aug 23/14		<input type="checkbox"/> Ottawa Valley Pointing Dog Club -Sunday August 24/13	
<input type="checkbox"/> Ottawa Valley All Setter Association- Saturday Aug 23/14		<input type="checkbox"/> Std Schnauzer Club of Can - Sunday August 24, 2013	
<input type="checkbox"/> Pointer Club of Canada National - Sat August 24, 2014		<input type="checkbox"/> Miniature Schnauzer - RTC -Sunday, August 24, 2013	
<input type="checkbox"/> Rideau Terrier Club - Group 4 Specialty- Sat Aug 23/14		<input type="checkbox"/> Wire Fox Terrier Club of Can -Sunday, August 24 / 14	
Price List - Entry Fee: \$ 30.00 CDN/USD Listing Fee: \$ 9.70 & Baby Puppy No Listing Fee Other Fees: Exhibition, Sweepstakes, Non Regular, \$15.00 CDN/USD			
PRE - ORDERED CATALOGUES - <input type="checkbox"/> ALL BREED \$ 10.00 CDN/USD			
Cheques Payable to SD & G Dog Association		Entries Close: Tuesday July 30, 2013 at 8pm	
CONFORMATION (Please Check Each Individual Specialty For Classes Offered)			
<input type="checkbox"/> BABY. Puppy (3-6 mth) <input type="checkbox"/> 12 - 18 months <input type="checkbox"/> Canadian Bred <input type="checkbox"/> Open <input type="checkbox"/> Veteran		<input type="checkbox"/> JR. Puppy (6 - 9 mth) <input type="checkbox"/> 12 - 15 months <input type="checkbox"/> Bred By Exhibitor <input type="checkbox"/> Specials Only <input type="checkbox"/> Sexually Altered	
<input type="checkbox"/> SR. Puppy (9 - 12 mth) <input type="checkbox"/> 15 - 18 months			
SWEEPSTAKES (Please Check Each Individual Specialty For Classes Offered)			
<input type="checkbox"/> 3-6 MOS <input type="checkbox"/> 9 - 12 MOS <input type="checkbox"/> 15-18 MOS <input type="checkbox"/> 7-9 years <input type="checkbox"/> 9 years + <input type="checkbox"/> 11-12 years		<input type="checkbox"/> 6 - 9 MOS <input type="checkbox"/> 12-15 MOS <input type="checkbox"/> 12-18 MOS <input type="checkbox"/> 7 -10 years <input type="checkbox"/> 10 years + <input type="checkbox"/> 13 years +	
		<input type="checkbox"/> 18 - 24 MOS <input type="checkbox"/> 9 -11 years <input type="checkbox"/> 11 years + <input type="checkbox"/> 3 Generation Sweepstakes	
SPECIALTY OBEDIENCE (Please Check Each Individual Specialty For Classes Offered)			
<input type="checkbox"/> Pre- Novice <input type="checkbox"/> Novice A <input type="checkbox"/> Novice B <input type="checkbox"/> Novice C <input type="checkbox"/> Open A <input type="checkbox"/> Open B <input type="checkbox"/> Utility A <input type="checkbox"/> Utility B		<input type="checkbox"/> Intermediate Novice JUMP HEIGHTS Height - Width -	
SPECIALTY RALLY (Please Check Each Individual Specialty For Classes Offered)			
<input type="checkbox"/> Novice A <input type="checkbox"/> Novice B <input type="checkbox"/> Advanced A <input type="checkbox"/> Advanced B <input type="checkbox"/> Excellent A <input type="checkbox"/> Excellent B <input type="checkbox"/> 6" <input type="checkbox"/> 8" <input type="checkbox"/> 12" <input type="checkbox"/> 16"			
NON REGULAR CLASSES (Please Check Each Individual Specialty For Classes Offered)			
<input type="checkbox"/> Exhibition Only <input type="checkbox"/> Brace <input type="checkbox"/> Brood Bitch <input type="checkbox"/> Stud Dog <input type="checkbox"/> Parade of Veterans <input type="checkbox"/> Parade of Titleholders		<input type="checkbox"/> Field Dog <input type="checkbox"/> TEAM ANY OTHER CLASS NOT LISTED <input type="checkbox"/>	
BREED		<input type="checkbox"/> Short - Haired <input type="checkbox"/> Long - Haired	SEX: <input type="checkbox"/> MALE OR <input type="checkbox"/> FEMALE
REGISTERED NAME OF DOG			
Check One & Enter Number Here		IS THIS A PUPPY?	
<input type="checkbox"/> CKC Reg #		<input type="checkbox"/> Yes or <input type="checkbox"/> No	
<input type="checkbox"/> CKC PEN #		PLACE OF BIRTH? <input type="checkbox"/> Canada <input type="checkbox"/> Elsewhere	
<input type="checkbox"/> CKC ERN #			
<input type="checkbox"/> CKC Misc Cert.#			
<input type="checkbox"/> CKC CCN.#			
<input type="checkbox"/> LISTED		Date Of Birth: Please Circle Month Jan Feb Mar Apr May June July Aug Sept Oct Nov Dec Day _____ Year _____.	
BREEDER(S)			
SIRE			
DAM			
REGISTERED OWNER(S)			
OWNER'S ADDRESS			
CITY	PROV/STATE	POSTAL CODE/ZIP	
NAME OF OWNERS AGENT (IF ANY) AT THE SHOW			
AGENT'S ADDRESS			
CITY	PROV/STATE	POSTAL CODE/ZIP	
Mail ID to: <input type="checkbox"/> OWNER Or <input type="checkbox"/> AGENT			
<small>I certify that I am the registered Owner(s) of the dog or that I am the authorized agent of the Owner(s) whose name(s) I have entered above and accept full responsibility for all statements made in this entry. In consideration of the acceptance of this entry, I (we) agree to be bound by the rules and regulations of the Canadian Kennel Club and any additional rules and regulations appearing in the premium list. Also, by signing this form I certify that I will not hold the Show giving Club, it's members, Directors, Employees, or Agents, liable in the event of any accident or misfortune however caused.</small>			
Signature of Agent or Owner _____		Phone Number _____	
a 15% + HST, charge applies on all Credit Card Charges		Email address _____	
<input type="checkbox"/> VISA <input type="checkbox"/> MasterCard <input type="checkbox"/> AMEX Expiry Date: Month > _____ Year > _____			
Card Number: _____ - _____ - _____ - _____			
Name of Card Holder: _____			
Fax # 519-351-3223		Mail To: COLMAR Show Service, 340 Mercer St, Chatham, ON, Canada N7M 6E1	

All Fees are payable at time of entry. No entry will be processed or entered in this show without payment.

There is limited Electric available in the Grooming Tent Be Fair and Share

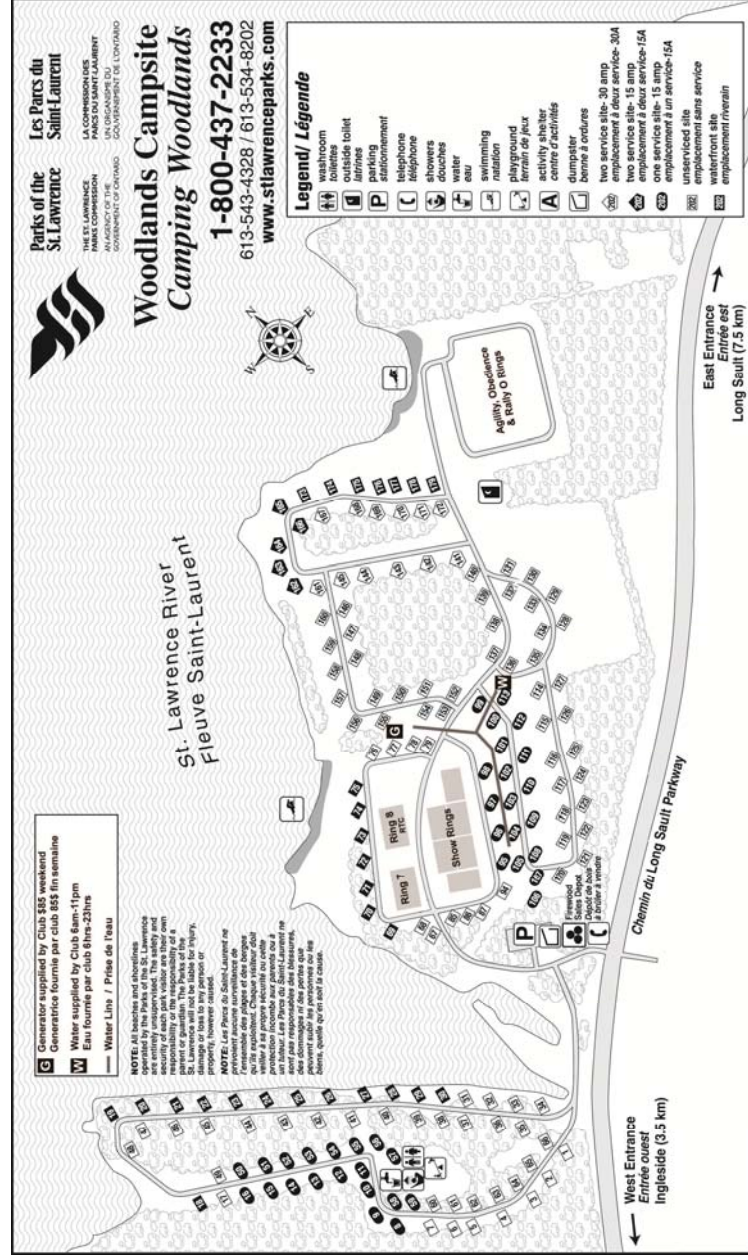

RV's & Trailers Reservations Accepted & Strongly Suggested, Please call 1-800-437-2233, Inform the Park you are with the Dog Show
There is no site sharing & visitors are not permitted to enter the park after 8pm. Limited Electrical Hook-ups. Don't be disappointed book early.

RV Trailer and Exhibitor Parking & Electrical Hook-ups
No refunds under any circumstances. Electrical - per receptacle \$ 85.00 CDN or USD. Any & All unpaid hook-ups will be removed. All Electrical hook-ups are to be paid at the show and to SD & G. Please refer to the map for campsite you wish to reserve closest to amenities. It is your responsibility to have enough cord to reach the generator, or hose for Water Hook-up. Refer to Map for locations. Water lines are marked on map (W). SD & G or it's affiliates do not accept or assume any liability for any damages caused by removal of unpaid electrical or Water Hook-ups. Unavailable Sites: - 71, 72, 83, 84, 88-92, 93, 95, 96, 98&, 100, 102, 103, 105-108, 109, 153-156, 154, 155, 153-166, 172

Please Contact Jeff Dale, 613-366-2030 ext # 2000 jdale@trademarkmedia.ca

Have More Than Ten Dogs? - Exhibitors /Handlers with 10 or more dogs contact – Jeff Dale, 613-366-2030 ext# 2000 jdale@trademarkmedia.ca - for any help in your stay.

No show or event - Specialty, All Breed, Performance Event, or Best in Show Judging, shall be delayed for any Exhibitor who has a conflict in another ring or event.

All exhibitors are expected to have alternative arrangements made for any possible conflict.

ACCOMMODATIONS

The following Motels/Hotels may accept dogs. Some of them may require a deposit or room-cleaning fee. Please verify acceptance of dogs in rooms when making reservations and respect Motel/Hotel property to ensure that you will be welcomed back.

If you are planning on leaving your dogs crated in your room, please do not leave them alone. Some dogs have a tendency to voice their disapproval to this situation and to the other guests.

Best Western 1515 Vincent Massey Dr., Cornwall ON
613-932-0451

Comfort Inn 1625 Vincent Massey Dr., Cornwall ON
613-937-0111

Lion Motel Hwy 32 exit # 778, Long Sault, ON
613-634-2119

Nites Inn 2120 Vincent Massey Dr., Cornwall ON
613-932-9623

Eukanuba 



DIRECTIONS TO THE SHOW SITE

(Map only as reference please refer to an official Ontario road map)

