



OFFICIAL PREMIUM LIST

MANITOBA GAZEHOUND ASSOCIATION

2 LICENSED LURE COURSE TRIALS

Saturday May 13, 2023 & Sunday May 14, 2023

MORRISON SPORTS PARK
OAKVILLE, MANITOBA

JUDGES: * Valorie Hill Box 36 104 Fourth Ave South, Lucky Lake SK S0L 1Z0
* All breeds

LURE OPERATOR: Jeff Burtch

Send Entries to: DOGSHOW.ca

Event Secretary Jenn Muzik
704 Muriel Street
Winnipeg, MB R2Y 0Y2
204-995-4257 manitobagazehoundsecretary@gmail.com

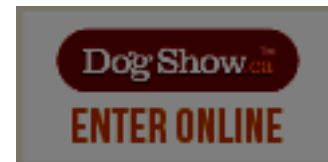

ENTRIES CLOSE: Friday May 5, 2023 – 6 PM (local time)
Entries will not be accepted by phone or paper copy
No Field/Post Entries Accepted

ROLL CALL, INSPECTION & HANDLER'S BRIEFING:

Saturday May 13, 2023 – 9:00 am
Sunday May 14, 2023 – 9:00 am

Please ensure you maintain social distancing at Roll Call and on the field.

These events are held under the rules of The Canadian Kennel Club.

CKC OFFICIALS:

Head Office Address:

Jeff Cornett
5397 Eglinton Ave W, Suite 101
Etobicoke, ON M9C 5K6
(416)675-5511

Manitoba CKC Lure Coursing Rep: Tannis Tindall
ttindall@mts.net

Manitoba CKC Board Member: Corinne Walker
prairieskykennel@gmail.com

CKC Chapter 4 Section 4.1.4

"It shall be the duty and obligation of the trial-giving club to see that a judge, club official, volunteer or any participant at an event held under these rules is not subject to indignities of any kind. The Field Trial Committee shall promptly report to the CKC any infringement of this regulation, and the Discipline Committee shall have the authority to take such action as it deems fit on receipt of a report indicating that this has occurred.

OFFICERS OF THE MGA:

Event Superintendent: Karl Schnabbler
President: Karl Schnabbler
Vice President: Leslie Guyader
Secretary: Jenn Muzik
Treasurer: Tannis Tindall
Event Secretary: Jenn Muzik

ENTRY FEES: \$20.00 for first dog
\$18.00 for second and subsequent dog(s)

OTHER FEES: \$10.50 CKC listing fee for all non-CKC registered dogs
(Includes 5% GST)

THERE IS A WAIVER FORM THAT MUST BE SIGNED AND WHICH MUST BE HANDED IN AT THE FIELD THE DAY OF THE TRIALS. OTHERWISE YOUR DOGS(S) WILL NOT BE ALLOWED TO PARTICIPATE. THIS CAN BE DOWNLOADED AT DOGSHOW.CA

THERE IS A COVID-19 WAIVER THAT MUST BE FILLED OUT AND SIGNED THE DAY OF THE TRIALS. OTHERWISE YOU AND YOUR DOG(S) WILL NOT BE ALLOWED TO PARTICIPATE. THIS WAIVER WILL BE PROVIDED AT THE TRIAL.

These events are held under the rules of The Canadian Kennel Club

ELIGIBLE BREEDS:

The Lure Course Trial Program participation is open to all breeds designated as Sighthounds who are at least 12 months of age that are:

- Individually registered with the CKCK; or
- Have an Event Registration Number (ERN); or
- Have a Performance Event Number (PEN); or
- Eligible for registration with the CKC; or
- Have a Miscellaneous Certificate Number (MCN) if it belongs to a CKC listed breed.

STAKES OFFERED:

Open Stakes:

- Each stake shall consist of entries for only one breed (dogs and bitches). Field Trial Champions in that breed may be entered.

Singles:

- Dogs will be run individually and scored by a judge. Hounds will run after the Open Stake has completed its preliminary round and then again after the open stake has completed its final round. A random draw will determine the order of running of dogs in this stake. Dogs must wear a blanket.

Veteran:

- Each stakes shall consist of entries of only one breed (dog and bitches) where their age is over 7 years. Field Trial Champions in that breed may be entered.

Best In Field:

- For all Best of Breed winners.

Dogs with Breed disqualifications are eligible to enter.

Females in season may not enter.

A dog may enter only once per trial.

Running order and arrangement of hounds coursing shall be determined by a random draw conducted by the Field Trial Secretary. 1st drawn will wear yellow (running on left side). 2nd drawn will wear pink (running in the middle) and 3rd drawn will wear blue (running on the right side).

PLACEMENTS & AWARDS:

CKC Chapter 9 Section 9.5.2

Championship points in regular stakes shall be awarded on the basis of the following:

First Place: 4x the number of hounds competing in the stake with a maximum of 40 points.

Second Place: 3x the number of hounds competing in the stake with a maximum of 30 points.

Third Place: 2x the number of hounds competing in the stake with a maximum of 20 points.

Fourth Place: Pointes equal to the number of hounds competing in the stake to a maximum of 10 points.

Next Best Qualified Dog (NBQ): No points awarded.

Qualifying Score (QS): No points awarded.

CKC Chapter 9 Section 9.5.3 A hounds shall not receive a placement or be awarded points if it does not score at least 50% of the total possible combined scores. Hounds that do not receive placements under this provision will, nevertheless, be considered as having been in competition for the purpose of awarding points. If a hound is excused in the preliminary run, that hound will

not count as having been in competition when computing championship points. Hounds that are dismissed or declared ineligible shall count as having been in competition when computing championship points.

RIBBONS:

A Rosette will be provided for Best in Field/

Ribbons will be provided for Best of Breed and placements 1st through 4th.

Prizes will be provided for Best in Field and Best in Breeds.

PRE-CERTIFICATION OF HOUNDS:

If anyone requires a dog to be certified prior to the trial please contact the Trial Secretary to make arrangements.

COURSE PLANS:

The club reserves the right to alter the course plan as required by weather and/or field conditions on the day of the trial. Course will be reversed for finals and again for run-offs and BOB.

ATTENTION EXHIBITORS:

- There will be a \$10.00 fine for dogs loose on the field or in the area of the event other than the dog(s) running the course.
- Lamé dogs or bitches in season will be excused and their entry refunded, provided notice is given prior to or during roll call.
- Dogs not present at roll call shall be scratched with no refunds. No exceptions.
- A veterinary clinic is located in Portage La Prairie.
- There is plenty of parking. Bathrooms available.
- Lots of room for crates but bring shade for your dogs and plenty of water.
- People are expected to clean up after their dogs and themselves. There will be a \$10.00 fine for being caught NOT cleaning up after their dogs.
- No food or beverages will be provided by MGA. Please ensure you bring water for your dog and water/snacks for yourself.
- Due to Covid-19 Protocols please ensure you maintain social distancing at the start line and on the sidelines. Please ensure to bring your own mask, hand sanitizer and wipes.

DIRECTIONS TO THE FIELD:

Travelling West from Winnipeg:

Head west on Trans Canada Highway #1 towards Portage La Prairie for approximately 55 km. (From West Perimeter).

Turn left onto Hwy 13 (south). There are signs for Oakville/Carman.

After 2.5 km turn right (west) onto HWY 331. There is a sign for Newton.

Park entrance on the left hand side (south) very near the intersection.

Yellow MGA signs will be put on the roadside.

Dog ShowTM.ca

ENTER ONLINE



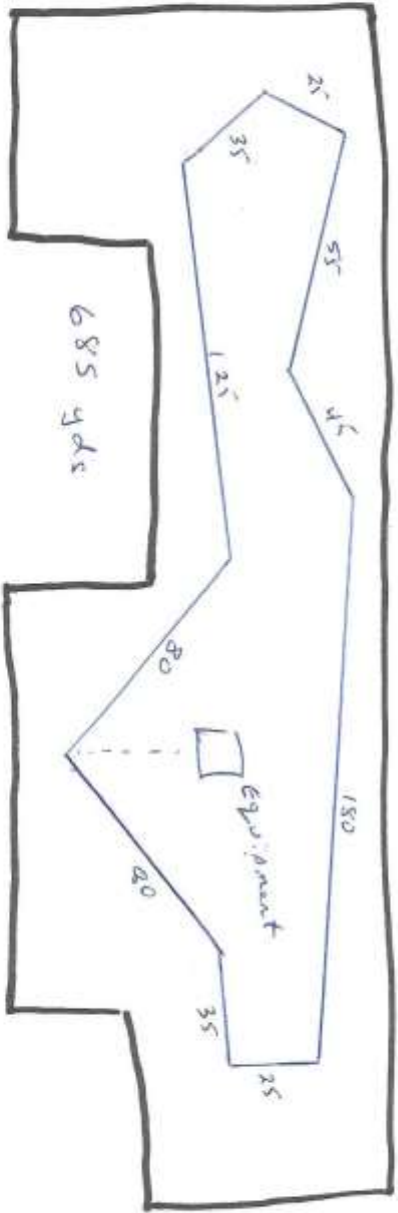

May 27/23

club
house

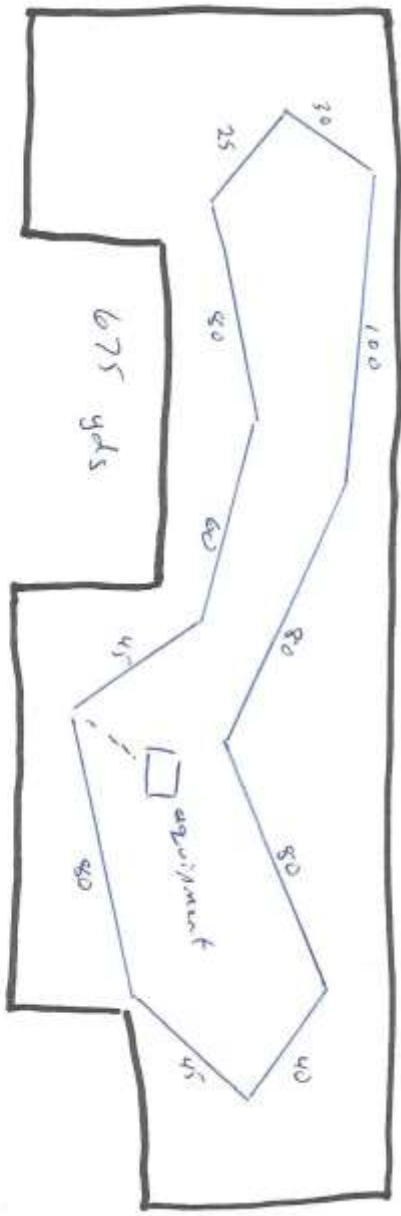

May 28/23

Club house

